

**FLOOD COMPENSATION STORAGE AREA 1**  
**SECTION A-A**

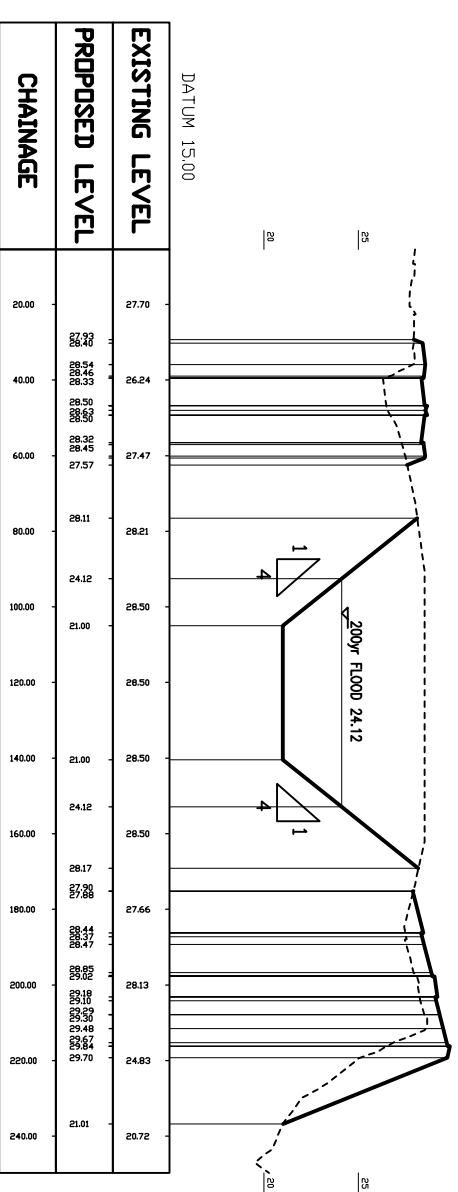

**FLOOD COMPENSATION STORAGE AREA 1**  
**SECTION B-B**

- NOTES:-
- 1) FOR LOCATION REFER TO DRAWING FIGURE 15.4.
  - 2) DETAILED DESIGN OF AREA 1 WILL INVOLVE PROFILING BASE TO ENSURE SLOPE TO RIVER CLYDE AND THEREFORE EFFICIENT DRAINAGE OF STRUCTURE POST FLOOD EVENT.

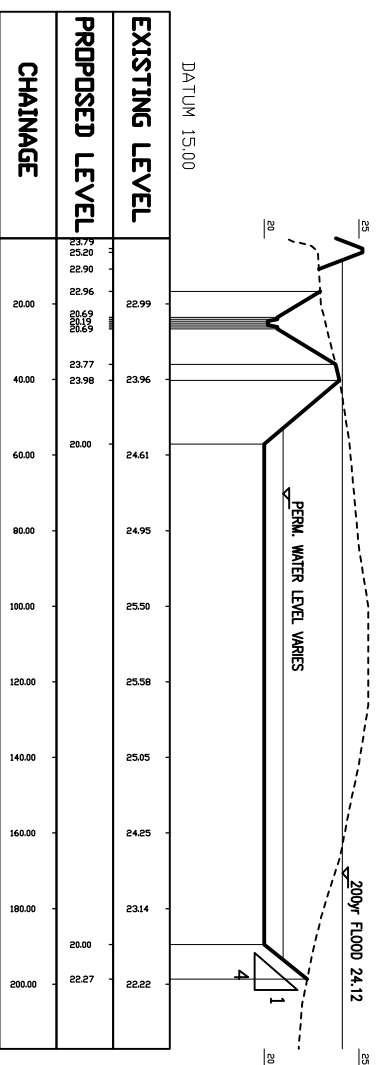

**FLOOD COMPENSATION STORAGE AREA 2**  
**SECTION C-C**

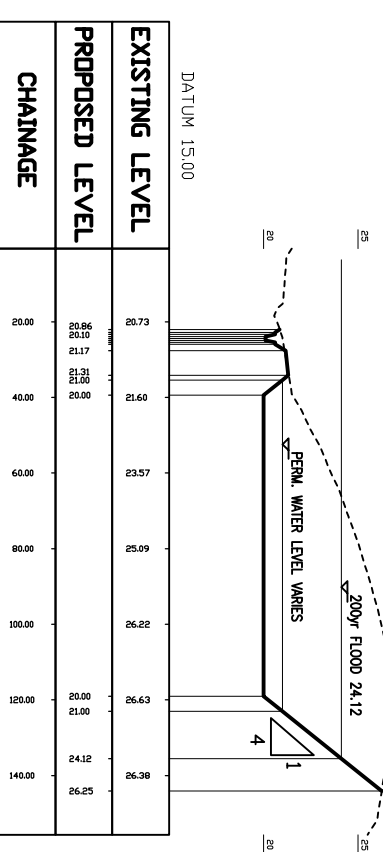

**FLOOD COMPENSATION STORAGE AREA 2**  
**SECTION D-D**

CLIENT



PROJECT TITLE

M74 JUNCTION 5,  
RAITH

This map is based on Ordnance Survey material with the permission of Ordnance Survey on behalf of the Controller of Her Majesty's Stationery Office Crown Copyright. Unauthorised reproduction infringes Crown copyright and may lead to prosecution or civil proceedings. Scottish Executive 100003510 Year of publication

ENGINEER



DRAWING TITLE  
STAGE 3 ENVIRONMENTAL STATEMENT  
LONGITUDINAL PROFILE  
OF UNNAMED BURN DIVERSION &  
CROSS-SECTIONS THROUGH  
COMPENSATORY STORAGE & SUDS

SCALE H 1:1000 V 1:200 @A1  
DRAWING NO Figure15.5  
REV -

DESIGN BY:	CHECKED BY:	DATE:	DATE:
VF	ELC	15/03/07	15/03/07
DRAWN BY:	APPROVED BY:	DATE:	DATE:
das	ELC	15/03/07	15/03/07

REVISIONS	BY	CHKD	APPD	DATE

AMENDMENTS	DATE

FINAL REPORT