

KILLIECRANKIE TO GLEN GARRY (SHEET 1 OF 13) - DMRB STAGE 3 DESIGN DEVELOPMENT

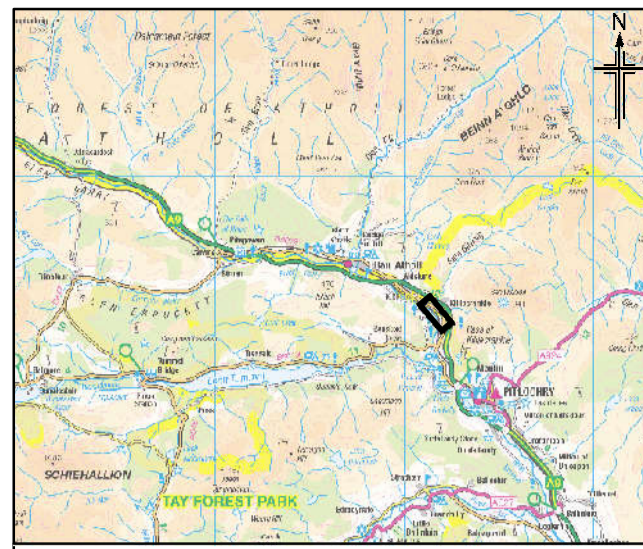

Legend - Design

- Proposed Scheme
- Cutting
- Embankment
- Graded Slope
- Structure

Legend - Constraints

- Existing Junction/Access
- Existing Structure
- Buildings
- Roads and Tracks
- Railway
- Existing Right of Way
- Existing NCN Route
- Existing Regional Cycle Network Route
- Existing Core Paths
- Existing Local Paths
- Listed Buildings
- Scheduled Monument
- Conservation Area
- Gardens and Designed Landscapes
- Battlefield Site
- Site of Special Scientific Interest (SSSI)
- Special Area of Conservation (SAC)
- Ancient Woodland Inventory
- River/Stream/Loch
- SEPA 1 in 200 Year Fluvial Flood Zone
- National Scenic Area
- Cairngorms National Park Boundary

Legend - Annotation

- Information
- Infrastructure
- Environment
- Property
- Watercourses

Please Note:

The preferred option shown on this drawing is indicative and is being developed further during the current DMRB (Design Manual for Roads and Bridges) Stage 3 period of design development. Environmental mitigation will also be added to the scheme design.

Ponds / basins (Sustainable Drainage Systems or SuDS) are proposed to treat and attenuate run-off from the proposed A9 dual carriageway which in turn enhances water quality, the local environment and reduces flood risk.

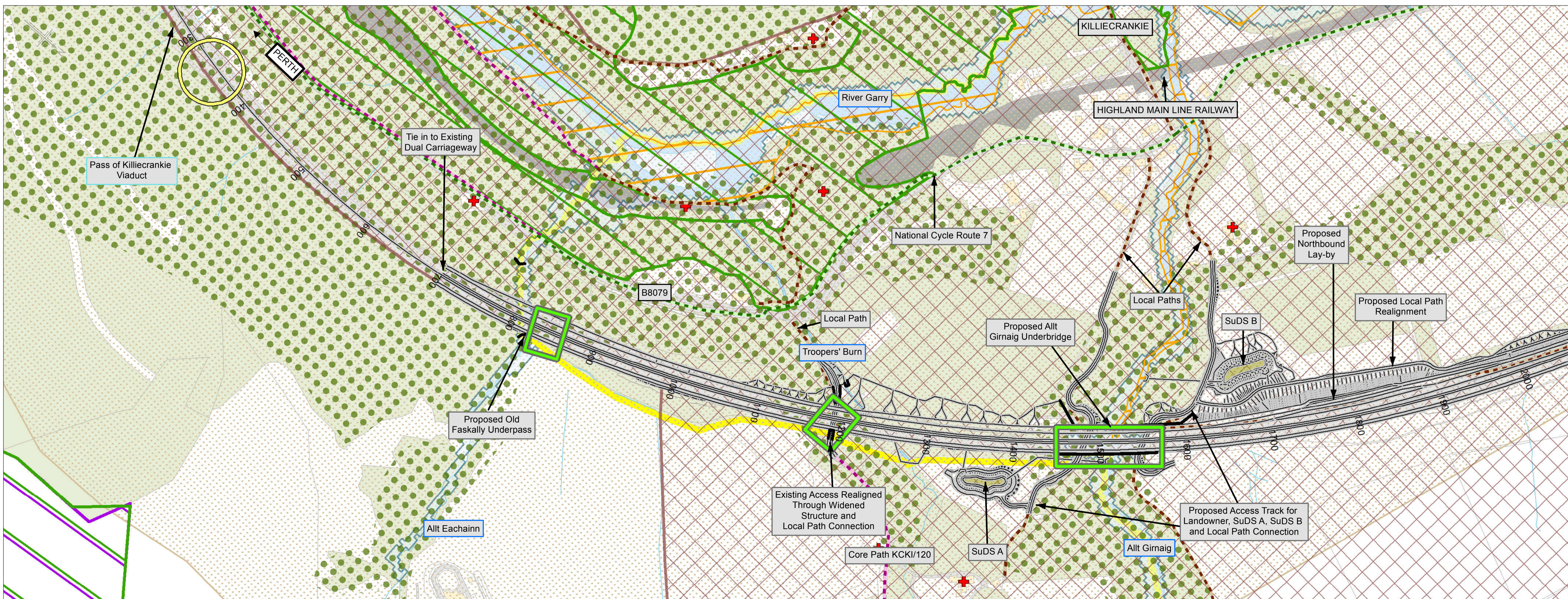

KILLIECRANKIE TO GLEN GARRY (SHEET 2 OF 13) - DMRB STAGE 3 DESIGN DEVELOPMENT

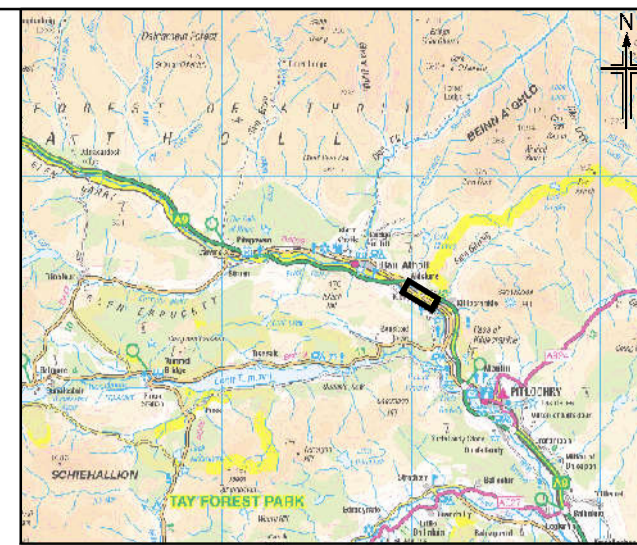

Legend - Design

- Proposed Scheme
- Cutting
- Embankment
- Graded Slope
- Structure

Legend - Constraints

- Existing Junction/Access
- Existing Structure
- Buildings
- Roads and Tracks
- Railway
- Existing Right of Way
- Existing NCN Route
- Existing Regional Cycle Network Route
- Existing Core Paths
- Existing Local Paths
- Listed Buildings
- Scheduled Monument
- Conservation Area
- Gardens and Designed Landscapes
- Battlefield Site
- Site of Special Scientific Interest (SSSI)
- Special Area of Conservation (SAC)
- Ancient Woodland Inventory
- River/Stream/Loch
- SEPA 1 in 200 Year Fluvial Flood Zone
- National Scenic Area
- Cairngorms National Park Boundary

Legend - Annotation

- Information
- Infrastructure
- Environment
- Property
- Watercourses

Please Note:
The preferred option shown on this drawing is indicative and is being developed further during the current DMRB (Design Manual for Roads and Bridges) Stage 3 period of design development. Environmental mitigation will also be added to the scheme design.

Ponds / basins (Sustainable Drainage Systems or SuDS) are proposed to treat and attenuate run-off from the proposed A9 dual carriageway which in turn enhances water quality, the local environment and reduces flood risk.

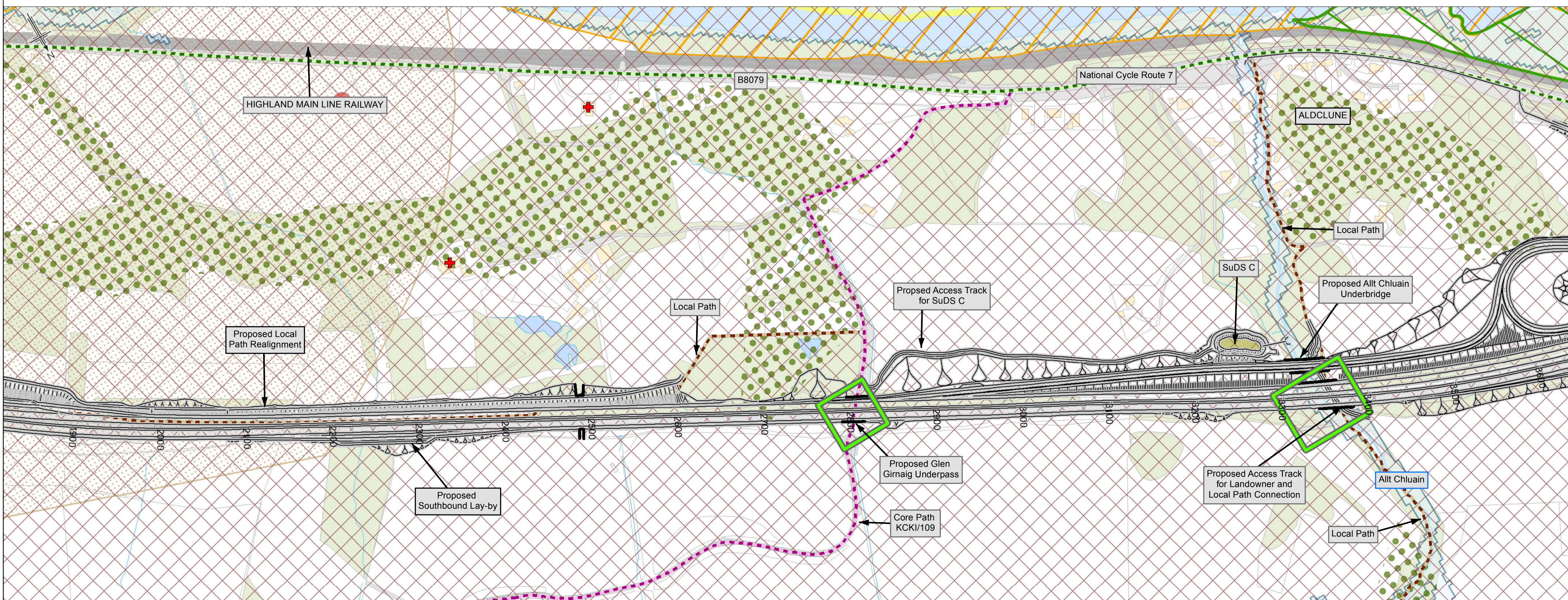

KILLIECRANKIE TO GLEN GARRY (SHEET 3 OF 13) - DMRB STAGE 3 DESIGN DEVELOPMENT

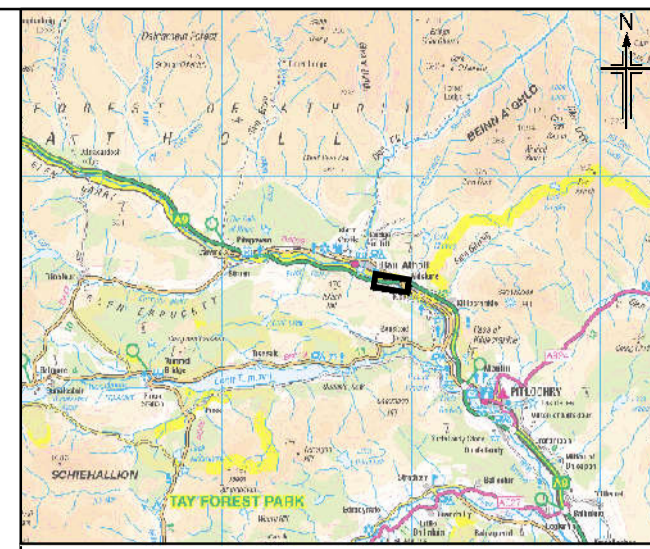
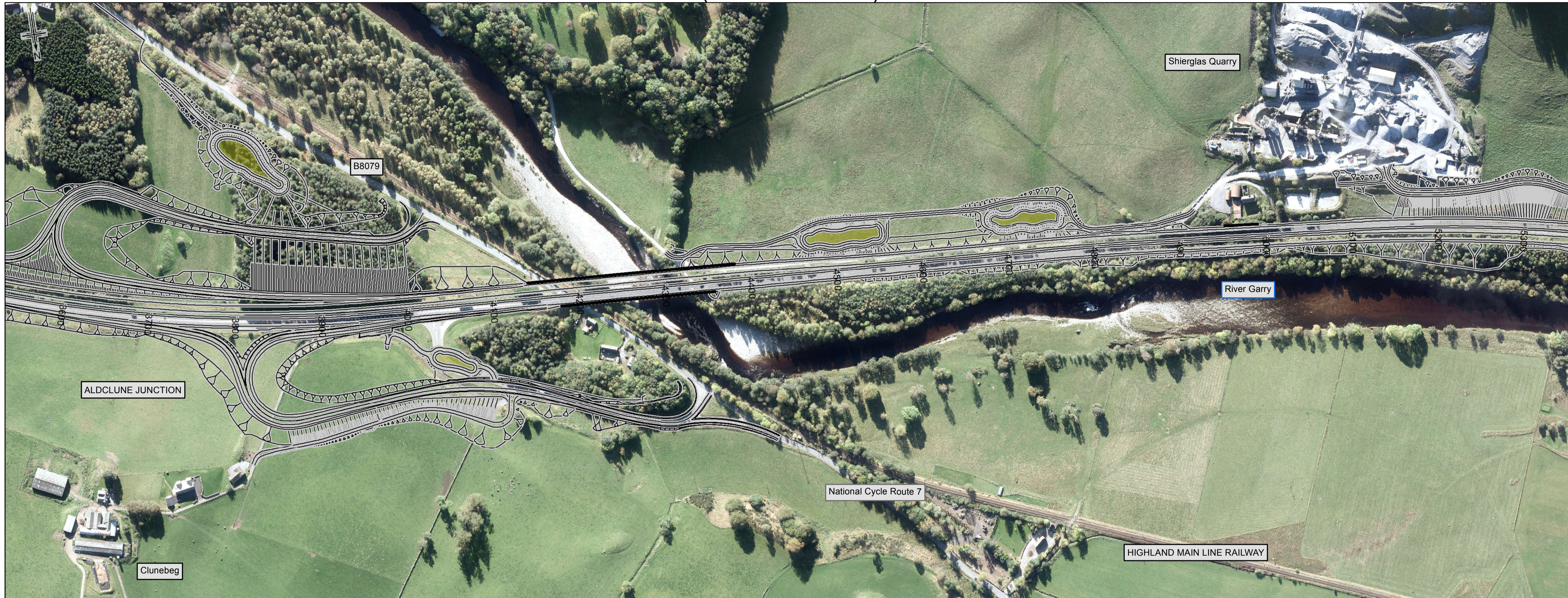

Legend - Design

- Proposed Scheme
- Cutting
- Embankment
- Graded Slope
- Structure

Legend - Constraints

- Existing Junction/Access
- Existing Structure
- Buildings
- Roads and Tracks
- Railway
- Existing Right of Way
- Existing NCN Route
- Existing Regional Cycle Network Route
- Existing Core Paths
- Existing Local Paths
- Listed Buildings
- Scheduled Monument
- Conservation Area
- Gardens and Designed Landscapes
- Battlefield Site
- Site of Special Scientific Interest (SSSI)
- Special Area of Conservation (SAC)
- Ancient Woodland Inventory
- River/Stream/Loch
- SEPA 1 in 200 Year Fluvial Flood Zone
- National Scenic Area
- Cairngorms National Park Boundary

Legend - Annotation

- Information
- Infrastructure
- Environment
- Property
- Watercourses

Please Note:

The preferred option shown on this drawing is indicative and is being developed further during the current DMRB (Design Manual for Roads and Bridges) Stage 3 period of design development. Environmental mitigation will also be added to the scheme design.

Ponds / basins (Sustainable Drainage Systems or SuDS) are proposed to treat and attenuate run-off from the proposed A9 dual carriageway which in turn enhances water quality, the local environment and reduces flood risk.

