

Plan on North Pier
Scale 1:100

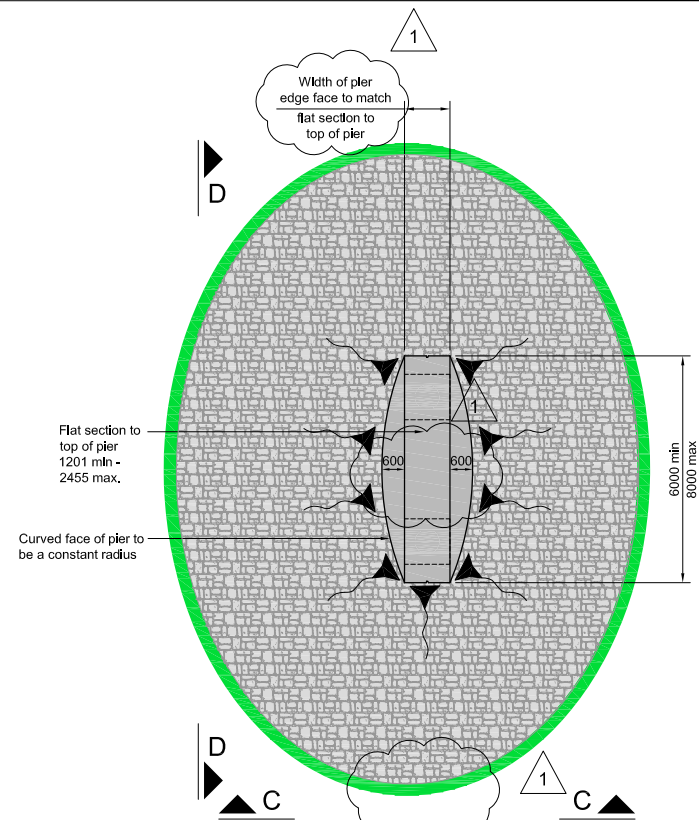

Plan on South Pier
Scale 1:100

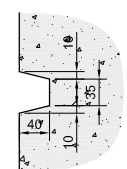

Typical Recess Detail
Scale 1:5

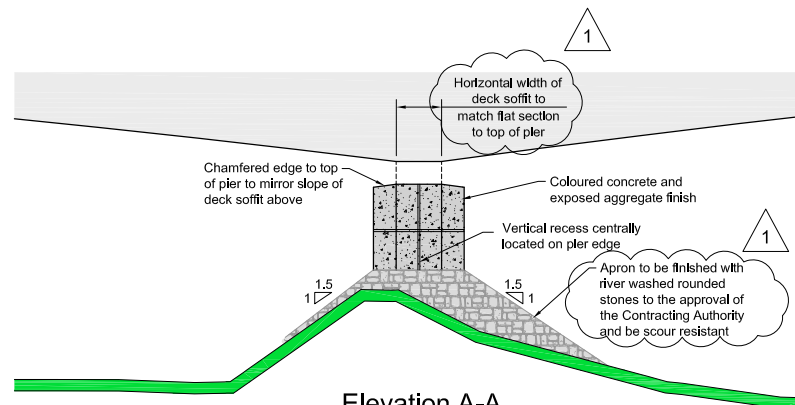

Elevation A-A
Scale 1:100

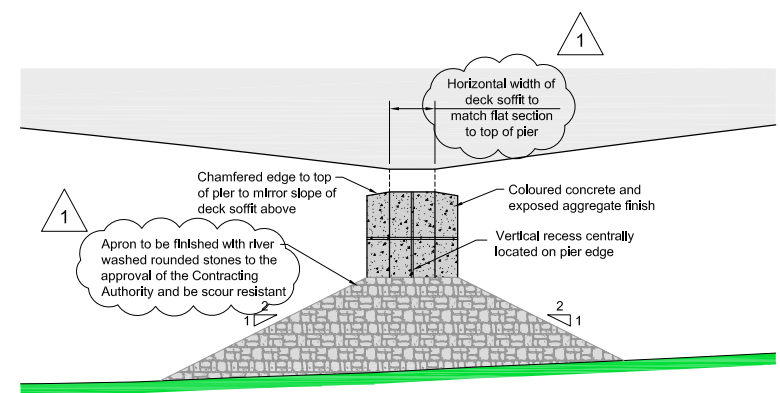

Elevation C-C
Scale 1:100

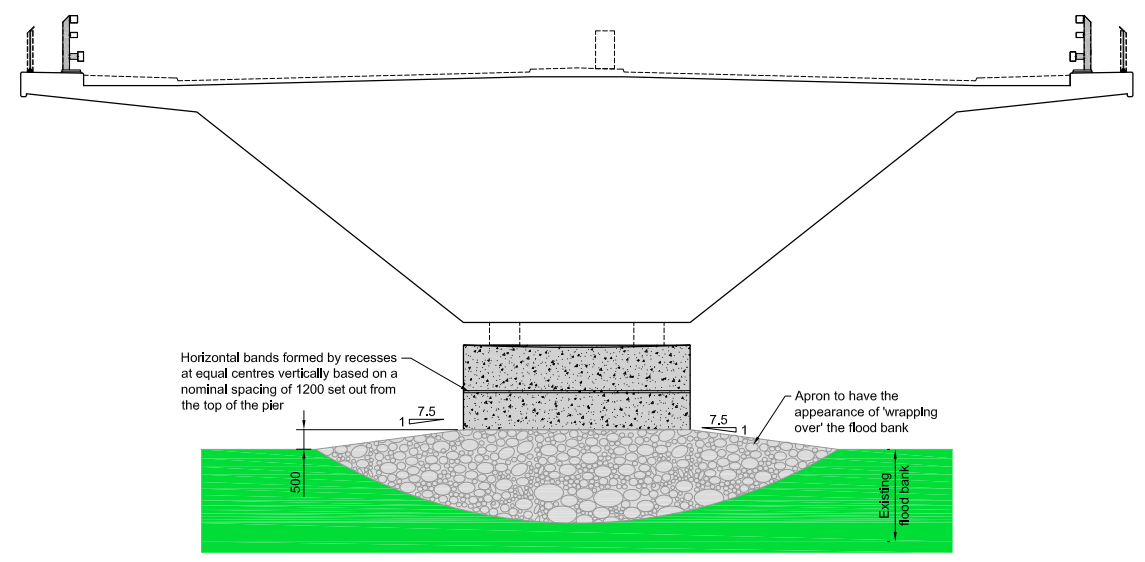

Sectional Elevation B-B
Scale 1:100

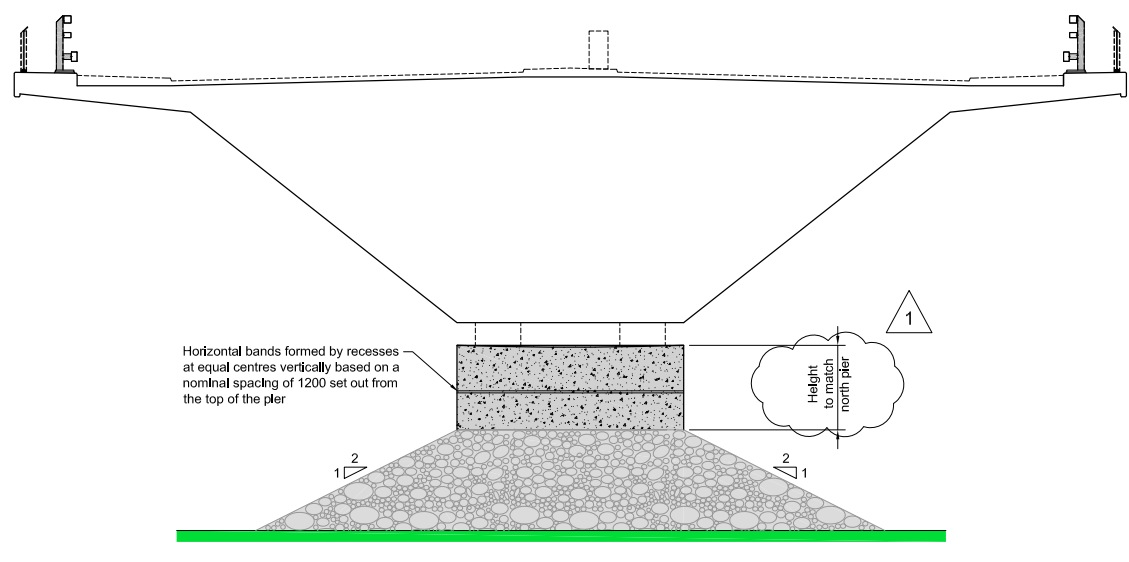

Sectional Elevation D-D
Scale 1:100

- Notes:
- All dimensions are in millimetres unless noted otherwise.
 - All dimensions shown meet the requirements of the New Works. Any deviation from these will require additional aesthetic consideration by the Contracting Authority.

1	21/1/2014	Changes clouded.	BA	DG	DG	JML
0	17/1/2014	First Issue	BA	DG	DG	JML
Rev	Rev. Date	Purpose of revision	Drawn	Checked	Rev'd	Approved

JACOBS
95 Bothwell St. Glasgow, G2 7HX
Tel: +44(0)141 243 8000 Fax: +44(0)141 228 3109
www.jacobs.com

Aberdeen Western Peripheral Route
Balmedie-Tipperty

Drawing title
**PS15 - RIVER DEE CROSSING
ALTERNATIVE PIER OPTION 1**

Drawing status
FOR DIALOGUE

Scale	AS SHOWN @ A1	DO NOT SCALE
Jacobs No.	0010332	
Drawing number	B1033200/CD/DEF/ST/021	Rev 1

This drawing is not to be used in whole or part other than for the intended purpose and project as defined on this drawing. Refer to the contract for full terms and conditions.