

See drawing number  
 B1033200/SD/500/042  
 for details in this area

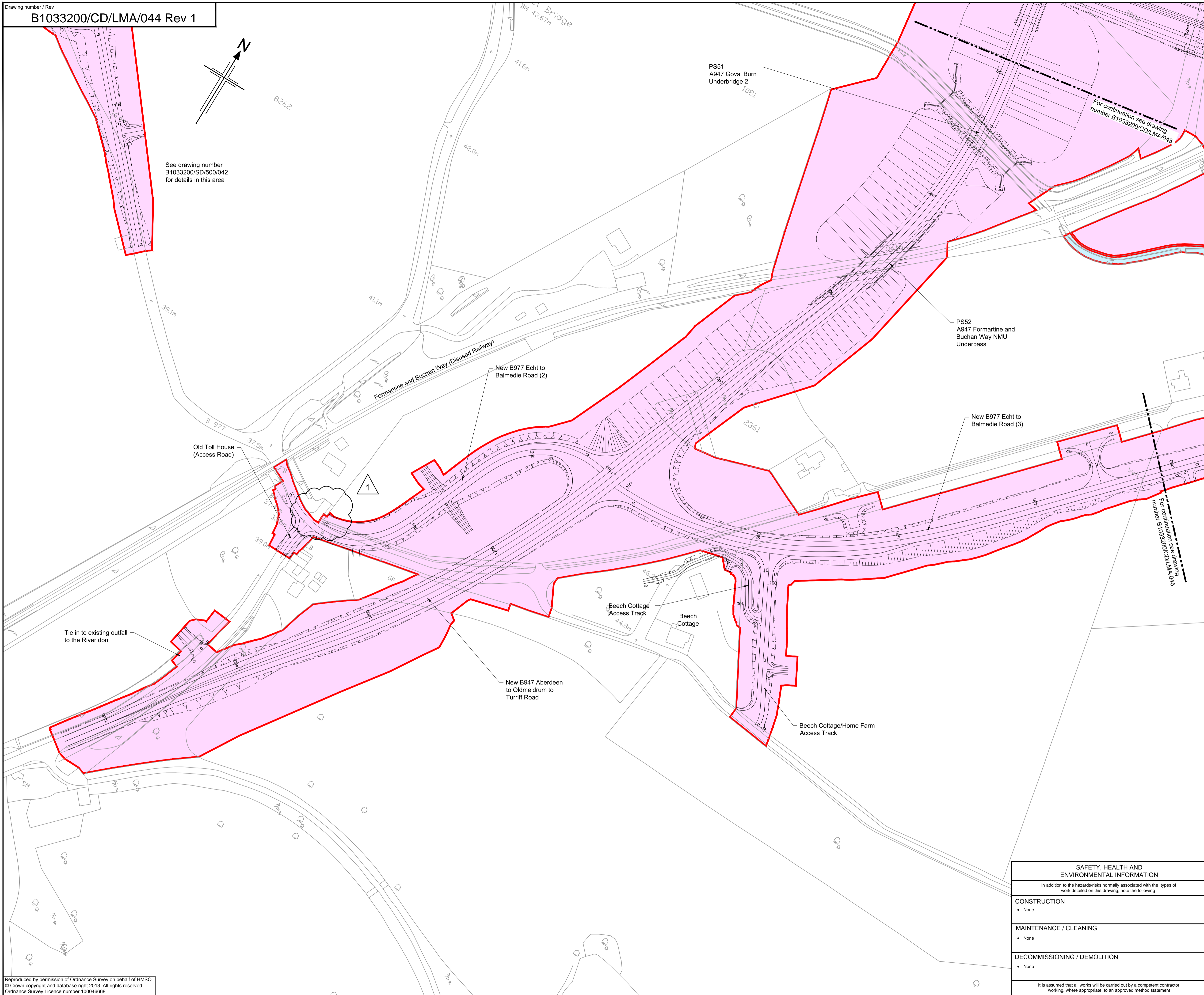

**LEGEND:**

**Non-Exclusive Availability**

Limit of Land Made Available by The Scottish Ministers for the New Works shown shaded pink and bounded by a red line including the red line.

**Restricted Availability**

The Access Rights over those parts of the New Works Site shown shaded light blue and bounded by a red line including the red line shall be restricted to servitude rights or wayleaves for the purposes of construction and maintenance of drainage works and associated works only.

The Access Rights over those parts of the New Works Site shown shaded light green and bounded by a red line including the red line shall be restricted to servitude rights or wayleaves for the purposes of construction and maintenance of field access works and associated works only.

The Access Rights over those parts of the New Works Site shown shaded purple and bounded by a red line including the red line shall be restricted to authorised bat workers for the purposes of maintenance of the existing bat house.

The Access Rights over those parts of the New Works Site shown shaded brown and bounded by a red line including the red line shall be restricted to temporary access for the purposes of construction of temporary road diversions and associated works only. Until issue of FTU or third party road completion certificate.

The Access Rights over those parts of the New Works Site shown cross-hatched in dark blue and bounded by a red line including the red line shall be for the purposes of construction and maintenance of bridge works and drainage works associated with Network Rail property and operational land. Access shall not be taken without the express written permission of Network Rail.

The Access Rights over those parts of the New Works Site shown cross-hatched in red and bounded by a red line including the red line shall not be for the purposes of using the part of the site so defined for temporary storage of materials or as a site compound.

File: C:\Temp\AcPublish\_2882\B1033200-CD-LMA-044.dwg Date: Aug 13, 2013 - 4:20pm Plotted by: Indiat

Reproduced by permission of Ordnance Survey on behalf of HMSO.  
 © Crown copyright and database right 2013. All rights reserved.  
 Ordnance Survey Licence number: 100046666.

1	13/08/13	For dialogue - LMA at the Old Toll House access road added.	TF	BM	BM	JML
0	14/05/13	For dialogue	TF	BM	BM	JML
Rev	Rev. Date	Purpose of revision	Drawn	Checked	Rev'd	Appr'd

**JACOBS**  
 95 Bothwell St, Glasgow, G2 7HX  
 Tel: +44(0)141 243 8000 Fax: +44(0)141 226 3109  
 www.jacobs.com

**Aberdeen Western Peripheral Route**  
 Balmedie-Tipperty

Drawing title  
**LAND MADE AVAILABLE BY THE SCOTTISH MINISTERS FOR THE NEW WORKS SHEET 44 OF 71**

Drawing status  
**FOR DIALOGUE**

Scale: 1:1,250 @ A1 DO NOT SCALE  
 Jacobs No. B1033200  
 Drawing number B1033200/CD/LMA/044 Rev 1

**SAFETY, HEALTH AND ENVIRONMENTAL INFORMATION**

In addition to the hazards/risks normally associated with the types of work detailed on this drawing, note the following:

**CONSTRUCTION**

- None

**MAINTENANCE / CLEANING**

- None

**DECOMMISSIONING / DEMOLITION**

- None

It is assumed that all works will be carried out by a competent contractor working, where appropriate, to an approved method statement.

This drawing is not to be used in whole or part other than for the intended purpose and project as defined on this drawing. Refer to the contract for full terms and conditions.