

This map is based upon Ordnance Survey material with the permission of Ordnance Survey on behalf of the Controller of Her Majesty's Stationery Office (c) Crown copyright 2010. Any unauthorised reproduction infringes Crown copyright and may lead to prosecution or civil proceedings. Scottish Executive Licence number: SE100020540 2010.

The A90 (Aberdeen Western Peripheral Route) Special Road
(Extinguishment of Public Rights of Way) Order 2010

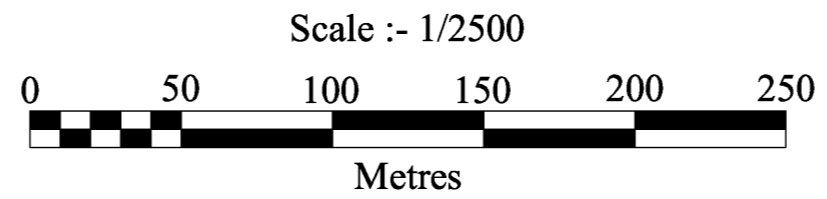

plan
ROW1



An agency of SCOTTISH EXECUTIVE

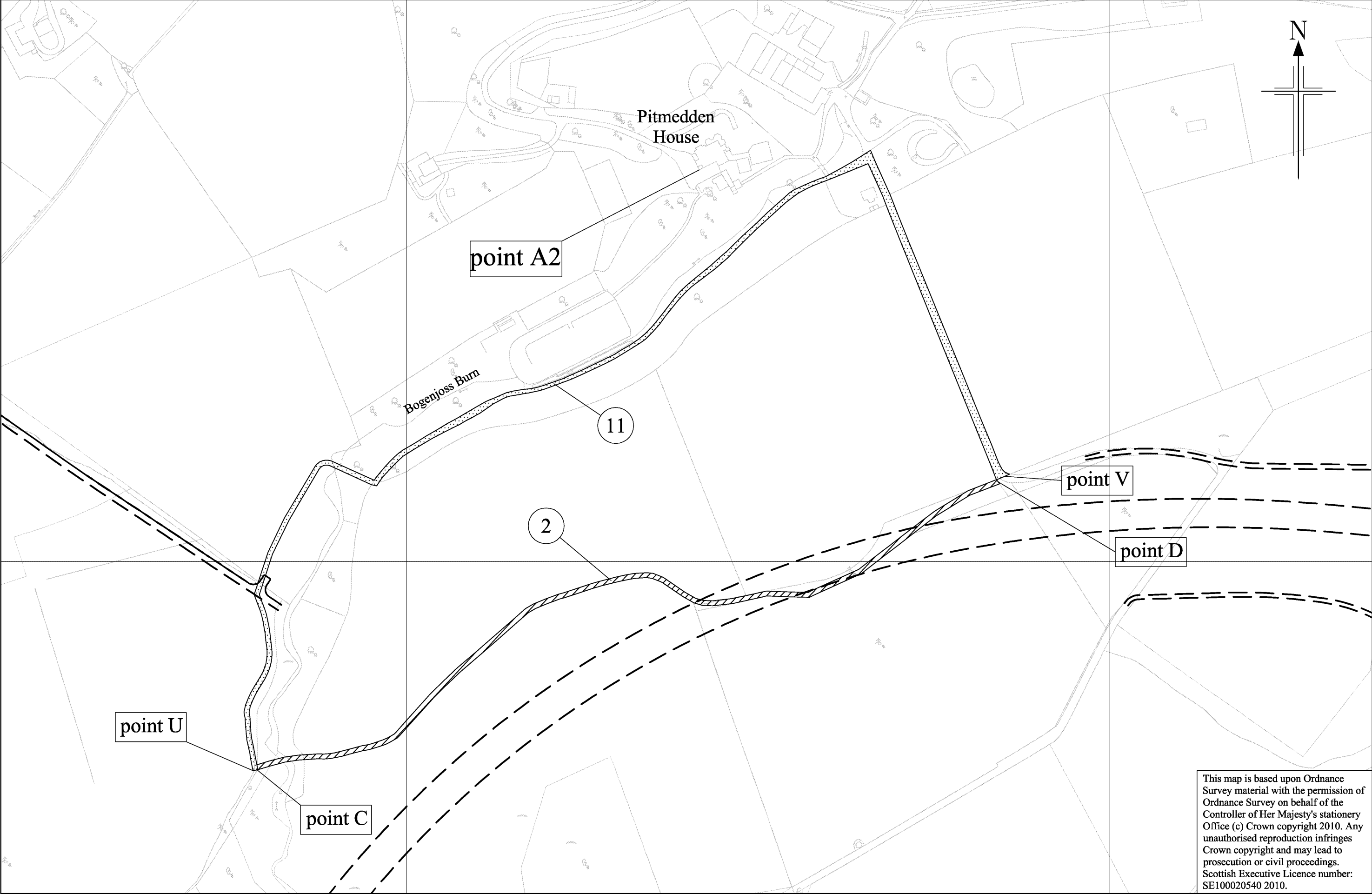

This map is based upon Ordnance Survey material with the permission of Ordnance Survey on behalf of the Controller of Her Majesty's Stationery Office (c) Crown copyright 2010. Any unauthorised reproduction infringes Crown copyright and may lead to prosecution or civil proceedings. Scottish Executive Licence number: SE100020540 2010.

The A90 (Aberdeen Western Peripheral Route) Special Road
(Extinguishment of Public Rights of Way) Order 2010

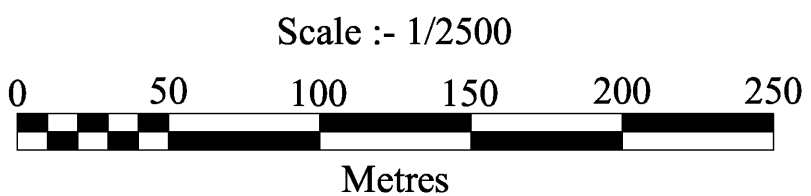

plan
ROW2



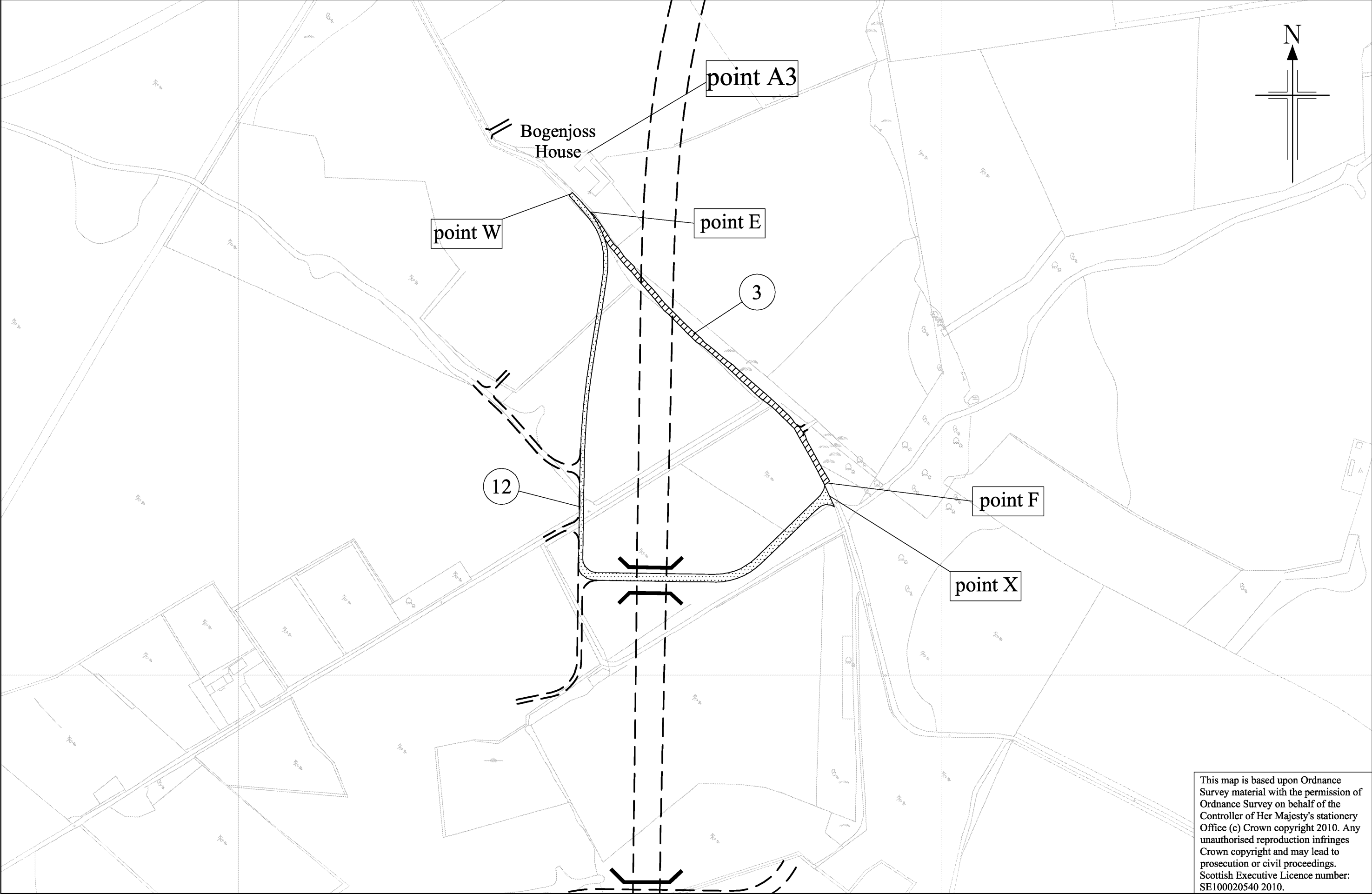

This map is based upon Ordnance Survey material with the permission of Ordnance Survey on behalf of the Controller of Her Majesty's stationery Office (c) Crown copyright 2010. Any unauthorised reproduction infringes Crown copyright and may lead to prosecution or civil proceedings. Scottish Executive Licence number: SE100020540 2010.

The A90 (Aberdeen Western Peripheral Route) Special Road
(Extinguishment of Public Rights of Way) Order 2010

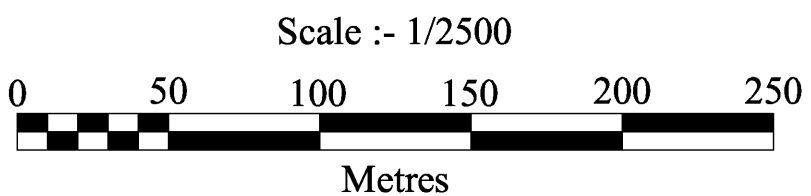

plan
ROW3



An agency of  SCOTTISH EXECUTIVE

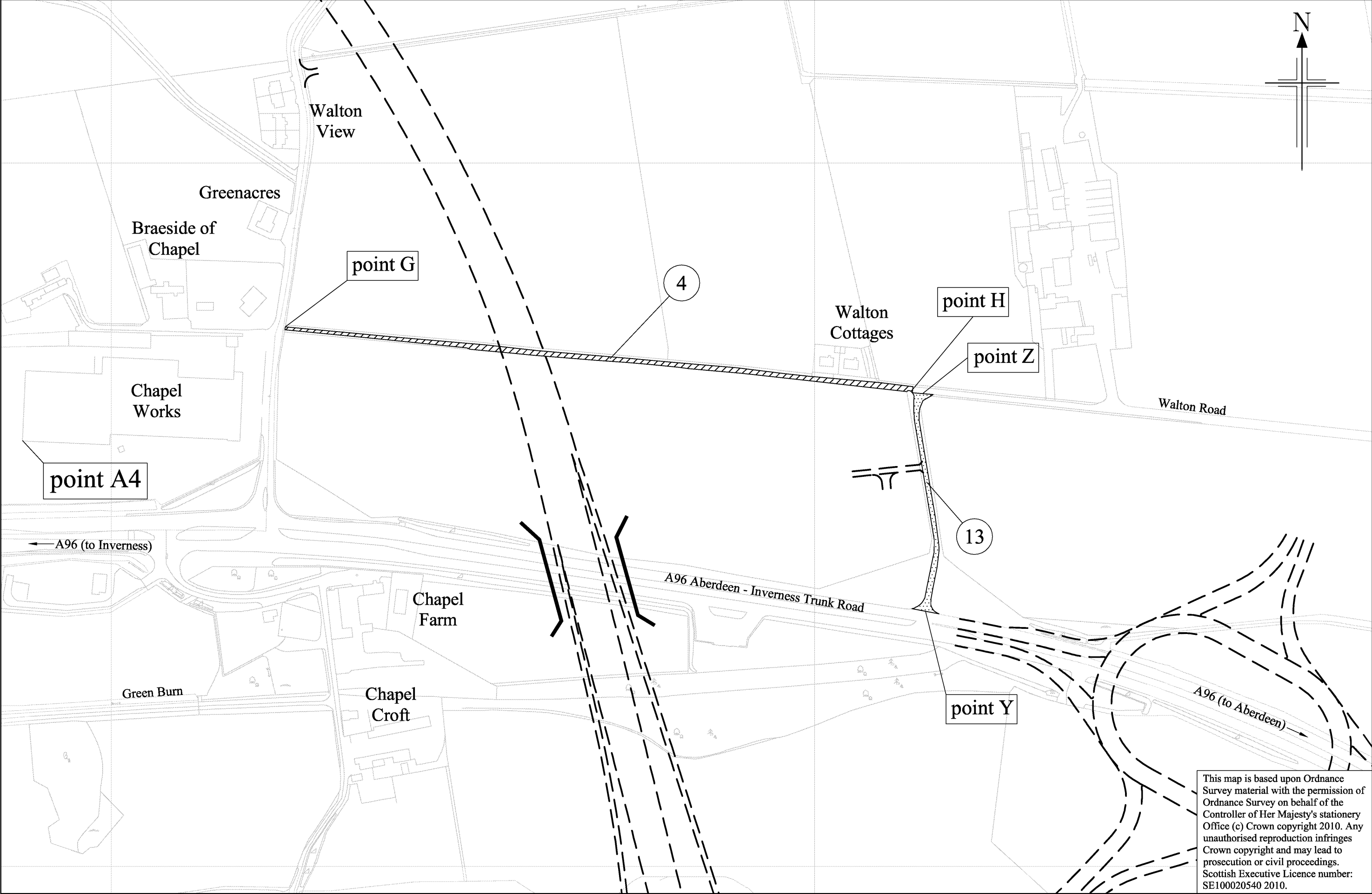
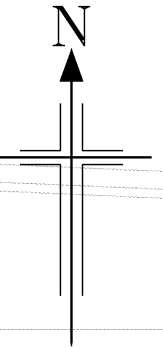

This map is based upon Ordnance Survey material with the permission of Ordnance Survey on behalf of the Controller of Her Majesty's Stationery Office (c) Crown copyright 2010. Any unauthorised reproduction infringes Crown copyright and may lead to prosecution or civil proceedings. Scottish Executive Licence number: SE100020540 2010.

The A90 (Aberdeen Western Peripheral Route) Special Road
(Extinguishment of Public Rights of Way) Order 2010

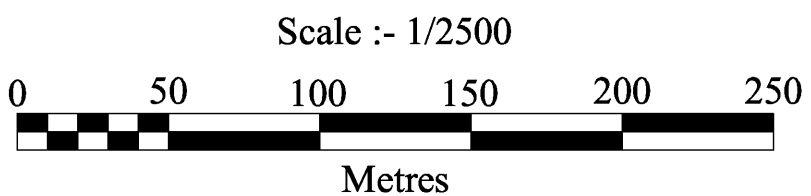

plan
ROW4



An agency of SCOTTISH EXECUTIVE

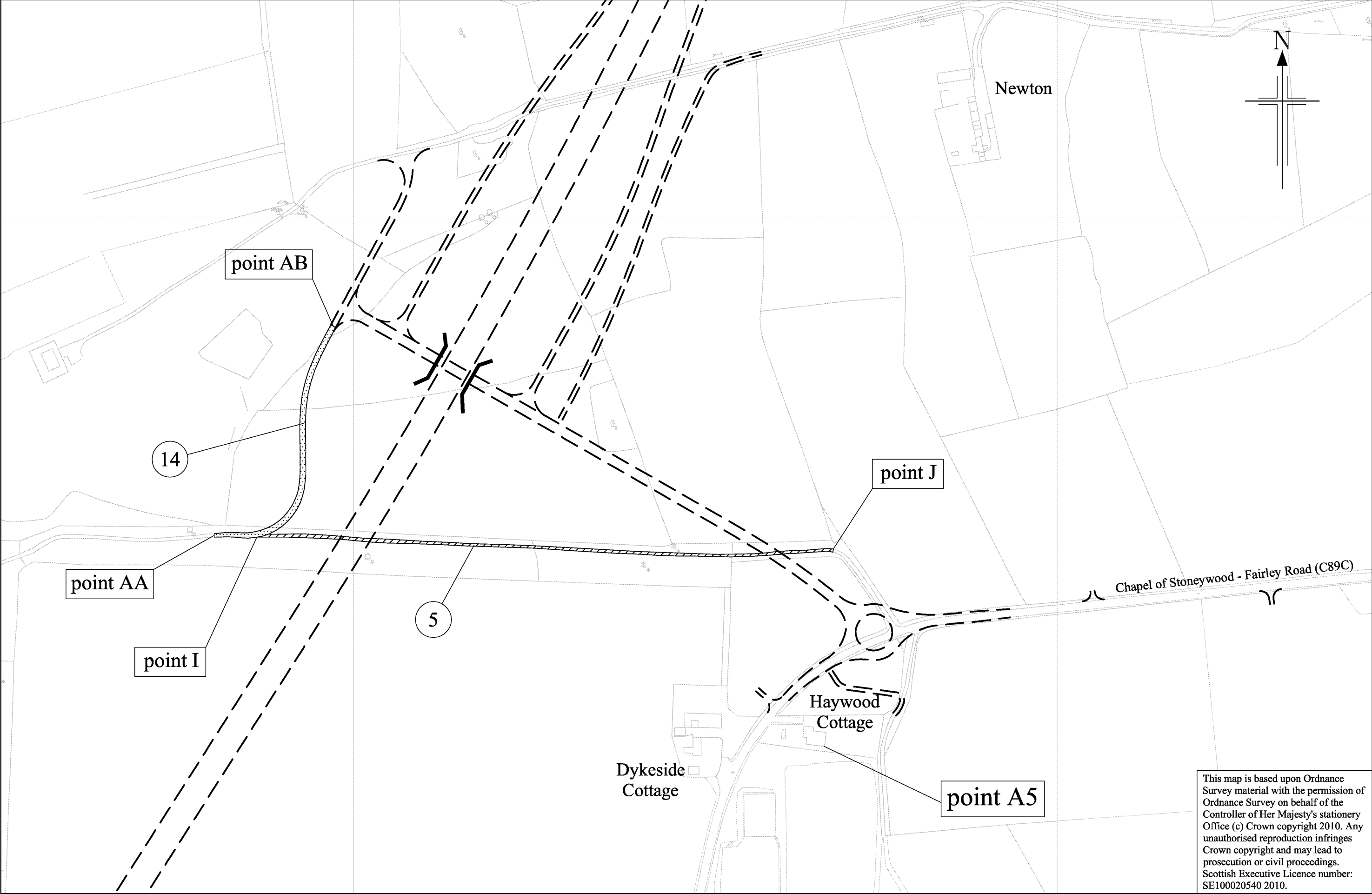

This map is based upon Ordnance Survey material with the permission of Ordnance Survey on behalf of the Controller of Her Majesty's stationery Office (c) Crown copyright 2010. Any unauthorised reproduction infringes Crown copyright and may lead to prosecution or civil proceedings. Scottish Executive Licence number: SE100020540 2010.

The A90 (Aberdeen Western Peripheral Route) Special Road
(Extinguishment of Public Rights of Way) Order 2010

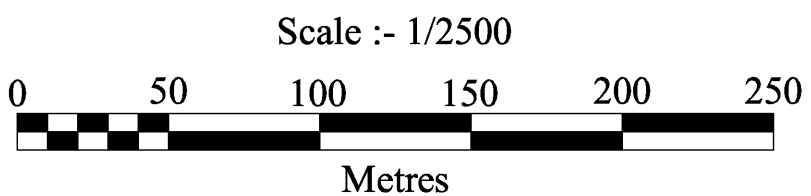

plan
ROW5



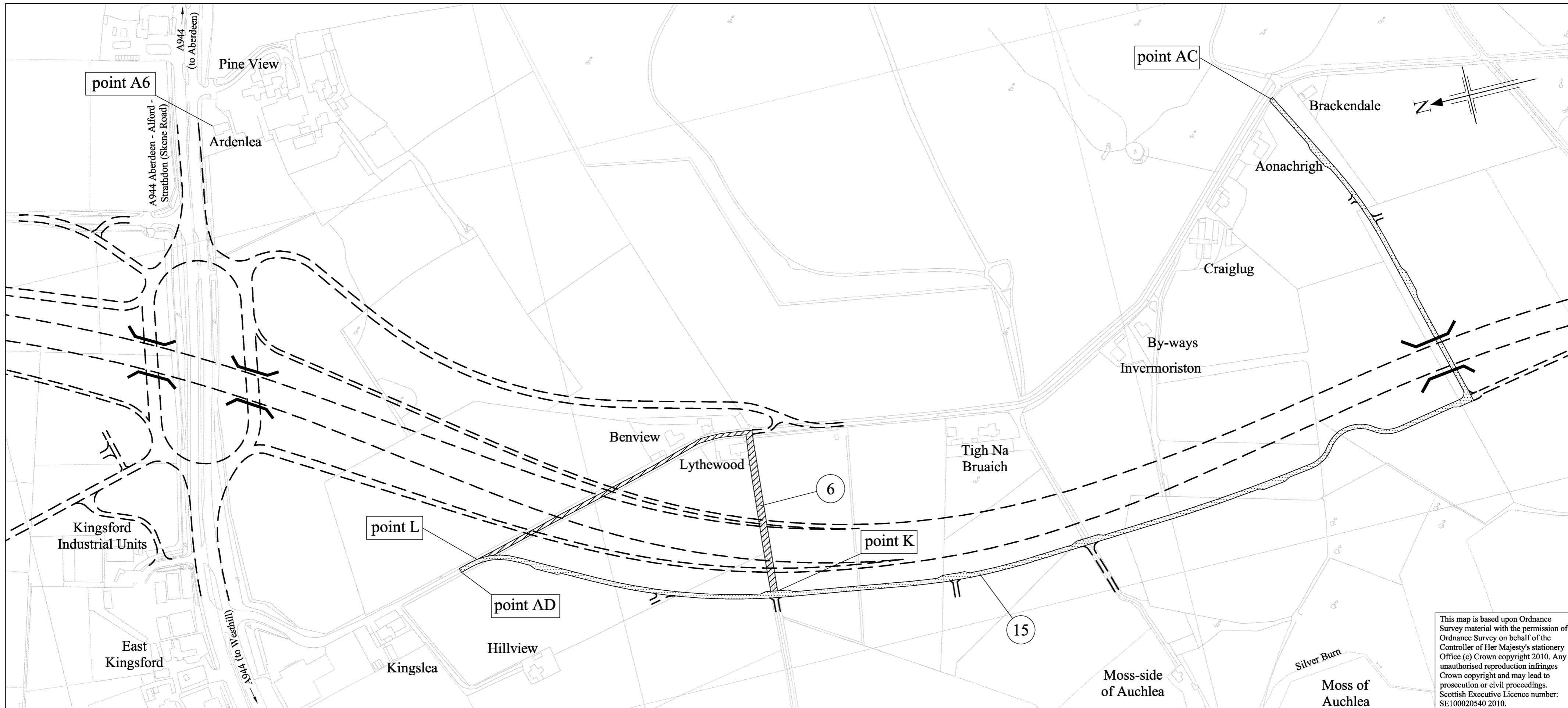

This map is based upon Ordnance Survey material with the permission of Ordnance Survey on behalf of the Controller of Her Majesty's Stationery Office (c) Crown copyright 2010. Any unauthorised reproduction infringes Crown copyright and may lead to prosecution or civil proceedings. Scottish Executive Licence number: SE100020540 2010.

The A90 (Aberdeen Western Peripheral Route) Special Road
(Extinguishment of Public Rights of Way) Order 2010

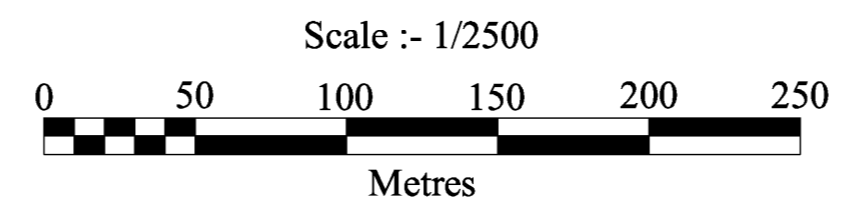

plan
ROW6



An agency of SCOTTISH EXECUTIVE

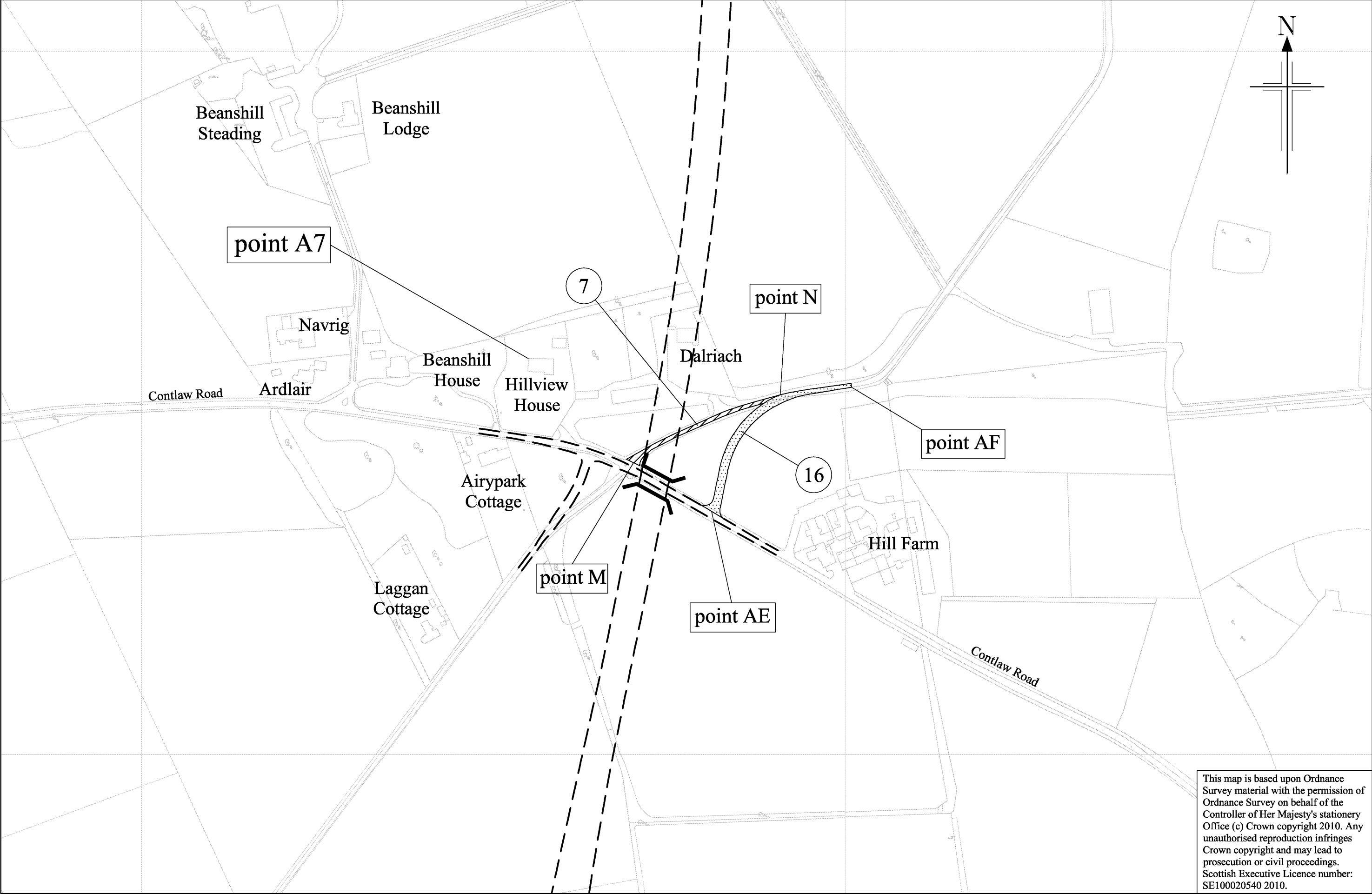

This map is based upon Ordnance Survey material with the permission of Ordnance Survey on behalf of the Controller of Her Majesty's Stationery Office (c) Crown copyright 2010. Any unauthorised reproduction infringes Crown copyright and may lead to prosecution or civil proceedings. Scottish Executive Licence number: SE100020540 2010.

The A90 (Aberdeen Western Peripheral Route) Special Road
(Extinguishment of Public Rights of Way) Order 2010

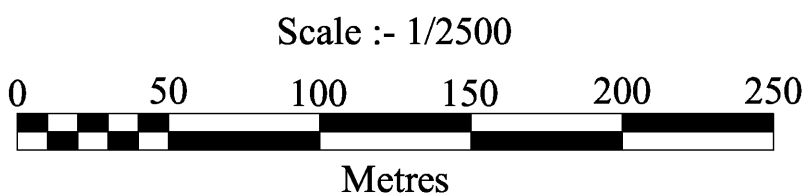

plan
ROW7



An agency of  SCOTTISH EXECUTIVE

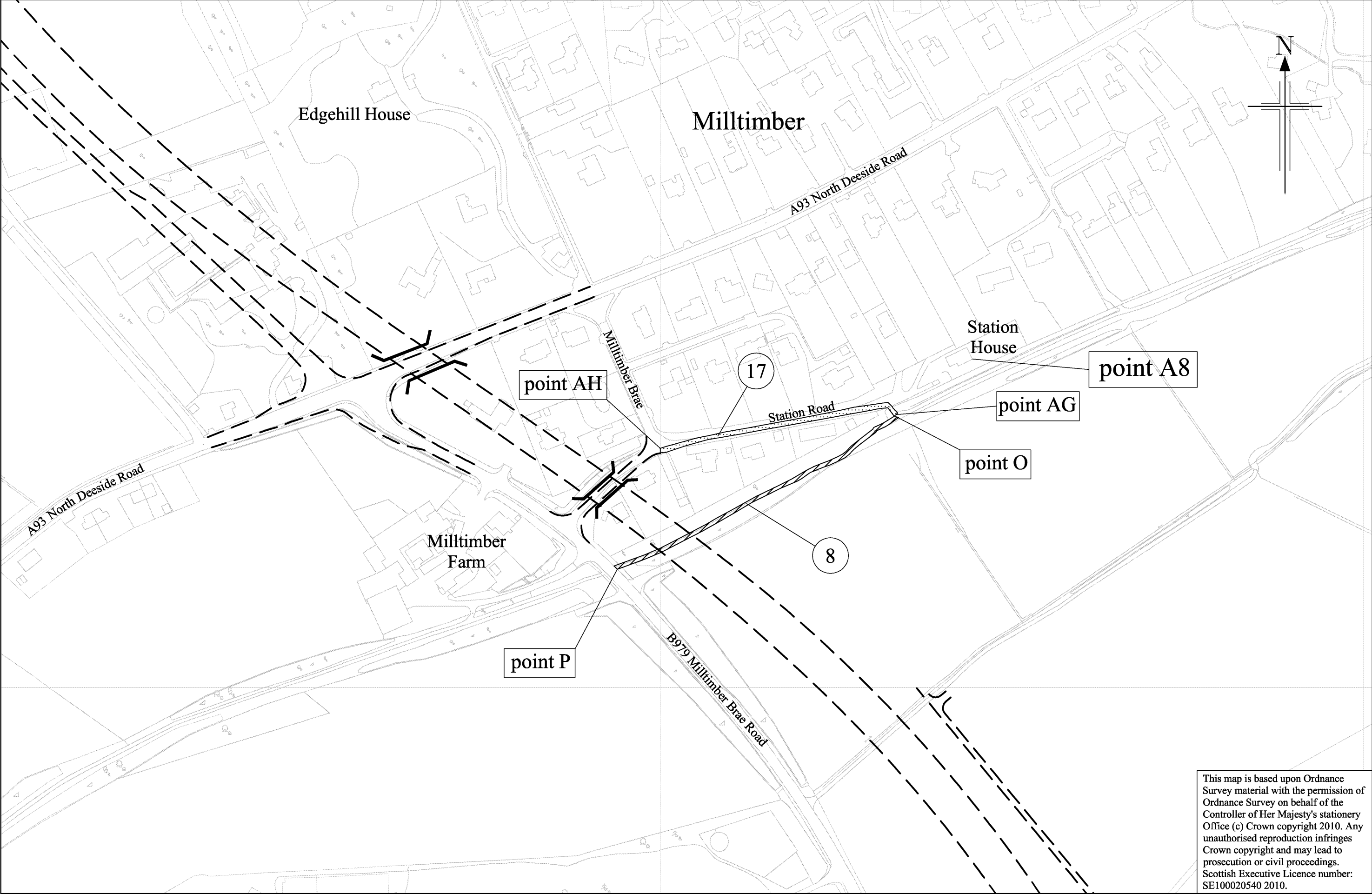

This map is based upon Ordnance Survey material with the permission of Ordnance Survey on behalf of the Controller of Her Majesty's Stationery Office (c) Crown copyright 2010. Any unauthorised reproduction infringes Crown copyright and may lead to prosecution or civil proceedings. Scottish Executive Licence number: SE100020540 2010.

The A90 (Aberdeen Western Peripheral Route) Special Road
(Extinguishment of Public Rights of Way) Order 2010

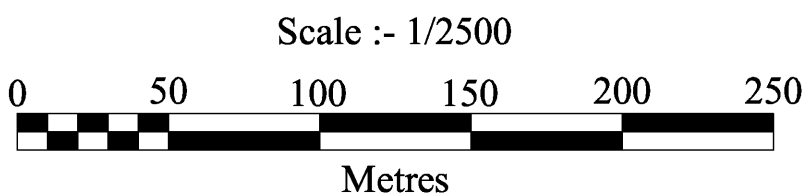

plan
ROW8



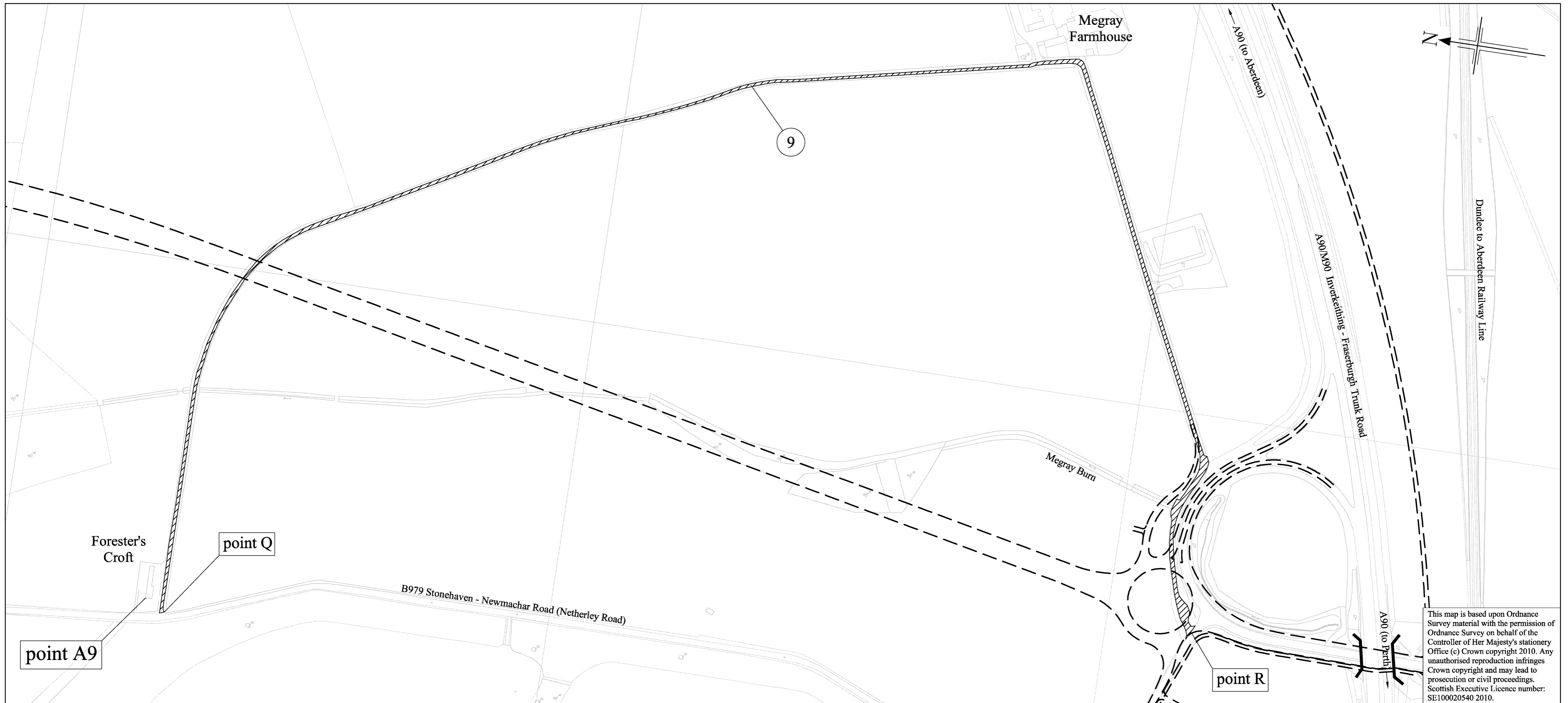

This map is based upon Ordnance Survey material with the permission of Ordnance Survey on behalf of the Controller of Her Majesty's Stationery Office (c) Crown copyright 2010. Any unauthorised reproduction infringes Crown copyright and may lead to prosecution or civil proceedings. Scottish Executive Licence number: SE100020540 2010.

The A90 (Aberdeen Western Peripheral Route) Special Road
(Extinguishment of Public Rights of Way) Order 2010

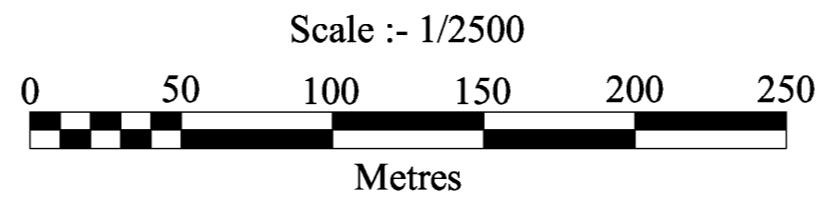

plan
ROW9



An agency of SCOTTISH EXECUTIVE