

THE A90 (ABERDEEN WESTERN PERIPHERAL ROUTE) SPECIAL ROAD AND
 THE A956 (ABERDEEN WESTERN PERIPHERAL ROUTE) SPECIAL ROAD
 NOTICE OF WORKS IN RELATION TO WATERS

Plan No.
 RYC/G109/36/53

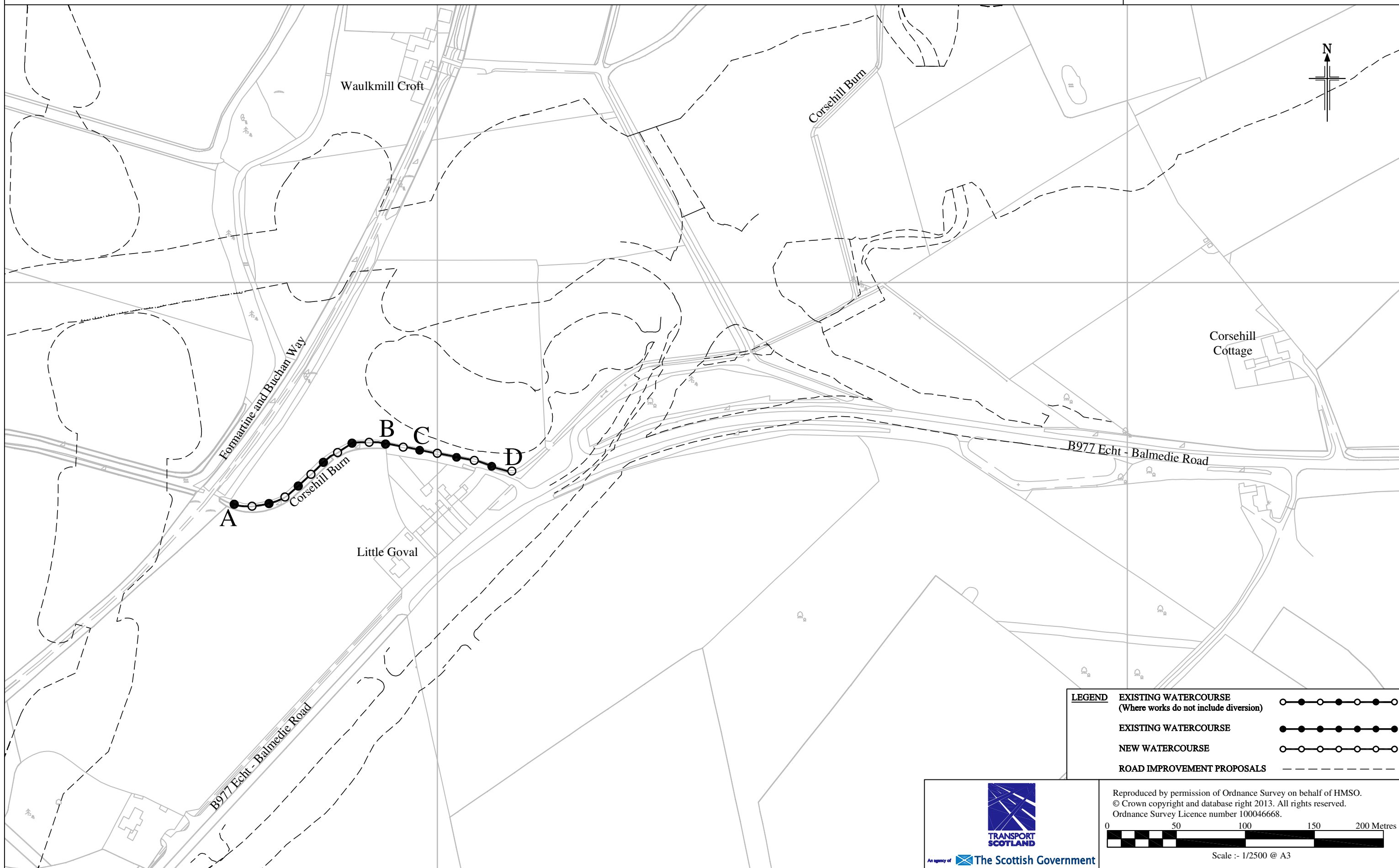

LEGEND	
EXISTING WATERCOURSE (Where works do not include diversion)	
EXISTING WATERCOURSE	
NEW WATERCOURSE	
ROAD IMPROVEMENT PROPOSALS	



Reproduced by permission of Ordnance Survey on behalf of HMSO.
 © Crown copyright and database right 2013. All rights reserved.
 Ordnance Survey Licence number 100046668.

0 50 100 150 200 Metres

Scale :- 1/2500 @ A3