

See drawing number
 B1033200/CD/O&MLMA/042
 for details in this area

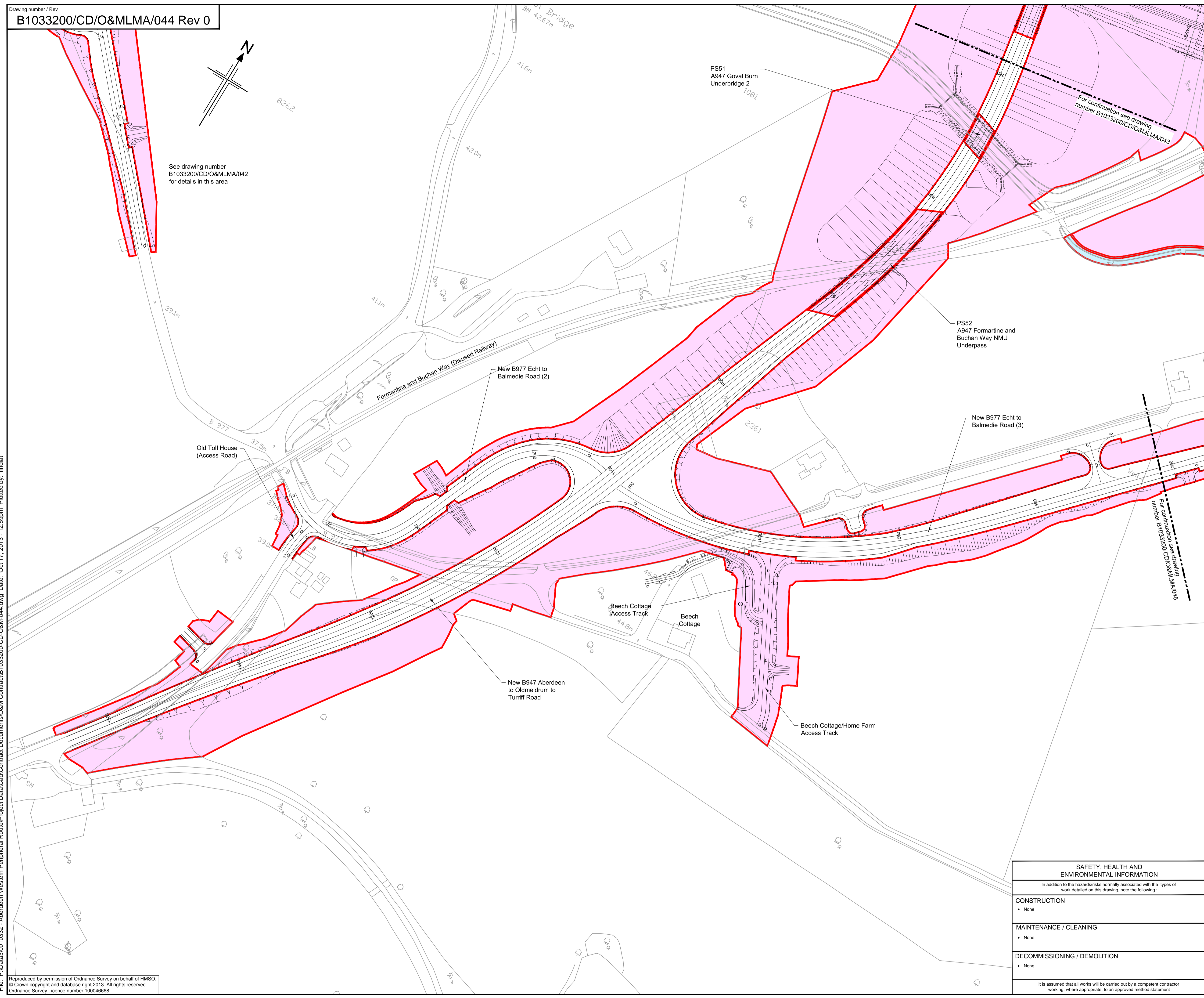

LEGEND:

Non-Exclusive Availability
 Limit of Land Made Available by The Scottish Ministers for the O&M Works shown shaded pink and bounded by a red line including the red line.

Restricted Availability
 The Access Rights over those parts of the O&M Works Site shown shaded light blue and bounded by a red line including the red line shall be restricted to servitude rights or wayleaves for the purposes of construction and maintenance of drainage works and associated works only.

The Access Rights over those parts of the O&M Works Site shown shaded purple and bounded by a red line shall be restricted to authorised bat workers for the purposes of maintenance of the existing bat house.

The Access Rights over those parts of the O&M Works Site shown cross-hatched in dark blue and bounded by a red line including the red line shall be for the purposes of construction and maintenance of bridge works and drainage works associated with Network Rail property and operational land. Access shall not be taken without the express written permission of Network Rail.

The Access Rights over those parts of the O&M Works Site shown cross-hatched in red and bounded by a red line including the red line shall not be for the purposes of using the part of the site so defined for temporary storage of materials or as a site compound.

The Access Rights over those parts of the O&M Works Site shown cross-hatched in green and bounded by a red line including the red line shall be for the purposes of Restricted Services only and shall cease on the Restricted Services completion date.

File: P:\Data\30010332 - Aberdeen Western Peripheral Route\Project Data\CadContract Documents\O&M Contract\B1033200-CD-O&M-044.dwg Date: Oct 17, 2013 - 12:59pm Plotted by: findat

Reproduced by permission of Ordnance Survey on behalf of HMSO.
 © Crown copyright and database right 2013. All rights reserved.
 Ordnance Survey Licence number 100046668.

0	04/10/13	For dialogue	TF	BM	BM	JML
Rev	Rev. Date	Purpose of revision	Drawn	Checkd	Rev'd	Apprv'd

JACOBS
 95 Bothwell St, Glasgow, G2 7HX
 Tel: +44(0)141 243 8000 Fax: +44(0)141 226 3109
 www.jacobs.com

Aberdeen Western Peripheral Route
 Balmedie-Tipperty

Drawing title
LAND MADE AVAILABLE BY THE SCOTTISH MINISTERS FOR THE O&M WORKS SHEET 44 OF 71

Drawing status
FOR DIALOGUE

Scale	1:1,250 @ A1	DO NOT SCALE
Jacobs No.	B1033200	
Drawing number	B1033200/CD/O&MLMA/044	Rev 0

This drawing is not to be used in whole or part other than for the intended purpose and project as defined on this drawing. Refer to the contract for full terms and conditions.

SAFETY, HEALTH AND ENVIRONMENTAL INFORMATION	
In addition to the hazards/risks normally associated with the types of work detailed on this drawing, note the following:	
CONSTRUCTION	• None
MAINTENANCE / CLEANING	• None
DECOMMISSIONING / DEMOLITION	• None
It is assumed that all works will be carried out by a competent contractor working, where appropriate, to an approved method statement	