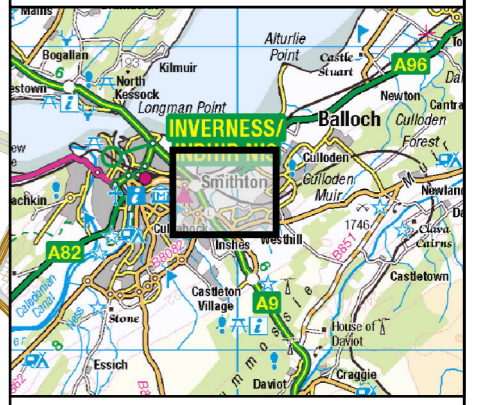

Figure 11.4a



- Legend**
- Proposed Scheme (DMRB Stage 3 design)
 - A96 Dualling Inverness to Nairn (including Nairn Bypass) Scheme Proposals
 - Consented Development Under Construction (as of April 2019)
 - 30m Roost Survey Study Area
 - 250m Ground-based Assessment Study Area

C00	SEPT 2019	EAIR Publication	CS	RBH	KL	DGC
Rev.	Rev. Date	Purpose of revision	Orig/Dwn	Checkd	Rev'd	Apprv'd



Client
A9/A96 Inshes to Smithton

Drawing title
**DMRB Stage 3 EAIR
Bat Roost Survey Results
Key Plan** Sheet 1 of 9

Drawing Status	A - APPROVED AS STAGE COMPLETE		
Scale	1:10,000	@ A3	DO NOT SCALE
Jacobs No.	B2103501		
BIM No.	A9-A96IS-JAC-EGN-XXX-FG-EN-1104		
Drawing number	Figure 11.4a	Rev	C00

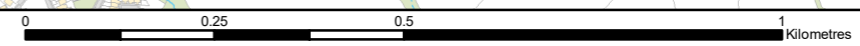

© Copyright 2019 Jacobs U.K. Limited. The concepts and information contained in this document are the property of Jacobs. Use or copying of this document in whole or in part without the written permission of Jacobs constitutes an infringement of copyright. This drawing has been prepared on behalf of, and for the exclusive use of Jacobs' Client, and is subject to, and issued in accordance with, the provisions of the contract between Jacobs and the Client. Jacobs accepts no liability or responsibility whatsoever for, or in respect of, any use of, or reliance upon, this drawing by any third party.

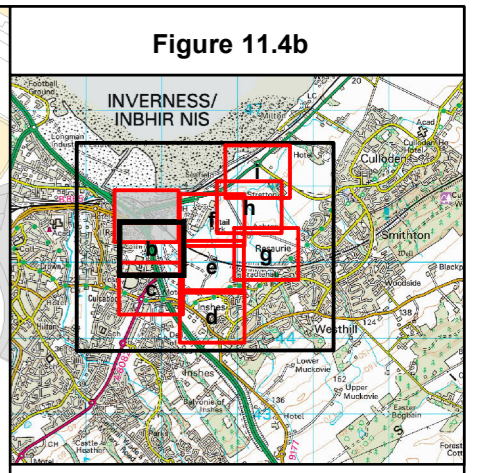
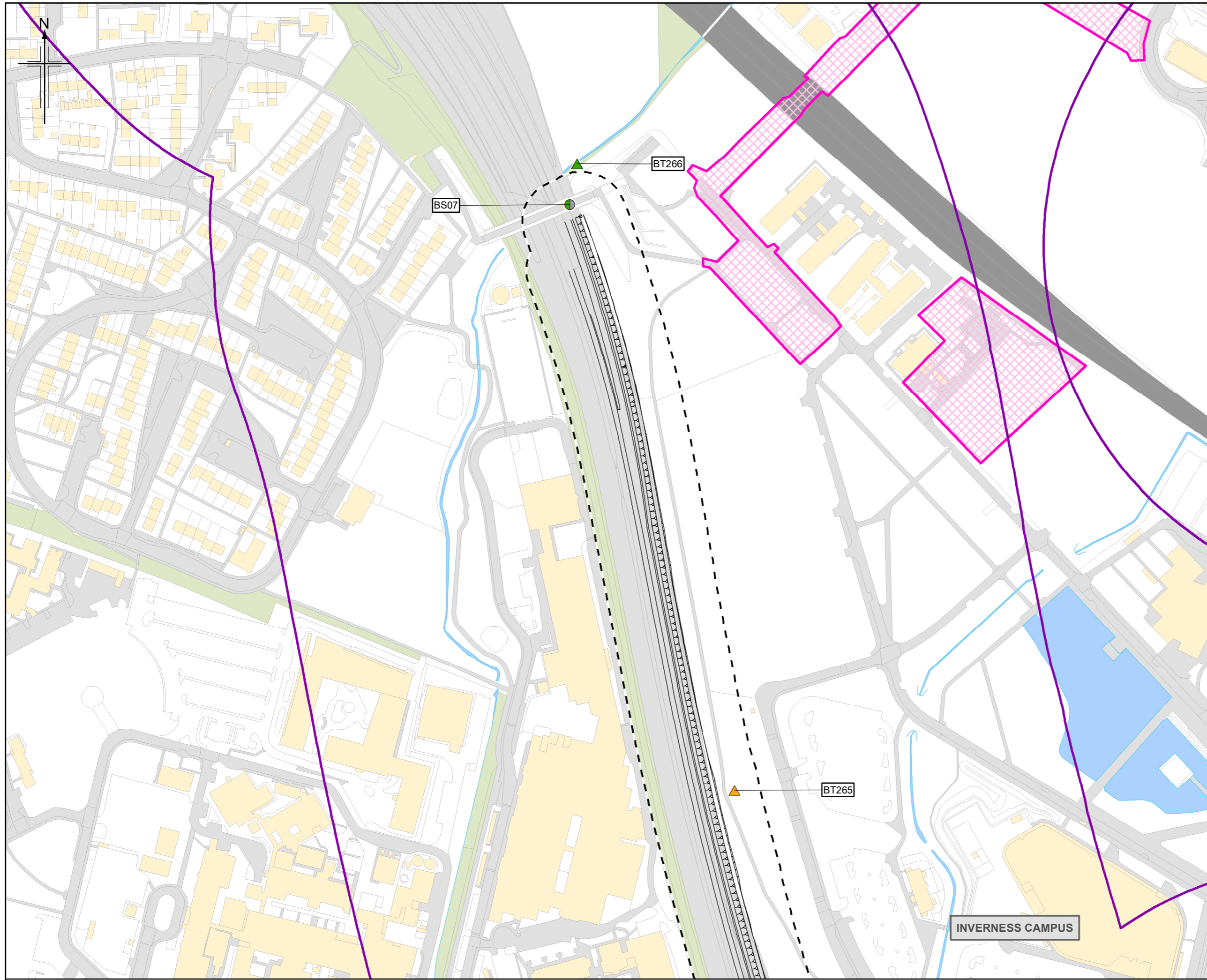

- Legend**
- Proposed Scheme (DMRB Stage 3 design)
 - A96 Dualling Inverness to Nairn (including Nairn Bypass) Scheme Proposals
 - Consented Development Under Construction (as of April 2019)
 - 30m Roost Survey Study
 - 250m Ground-based Assessment Study Area
- Bat Survey Results**
- Structure
 - Building
 - Tree
- Bat Roost Potential**
- High
 - Moderate
 - Low
 - Negligible
- *SRP - Summer Roosting Potential
WRP - Winter Roosting Potential

CS0	SEPT 2019	EAIR Publication	CS	RBH	KL	DGC
Rev.	Rev. Date	Purpose of revision	Orig/Dwn	Checkd	Rev'd	Apprv'd

JACOBS
95 Botwell Street, Glasgow, G2 7HX, UK
Tel: +44(0)141 243 9000
www.jacobs.com

Client

TRANSPORT SCOTLAND
COMHDAIL ALBA

Project **A9/A96 Inshes to Smithton**

Drawing title **DMRB Stage 3 EAIR
Bat Roost Survey Results**

Sheet 2 of 9

Drawing Status	A - APPROVED AS STAGE COMPLETE		
Scale	1:2,500	@ A3	DO NOT SCALE
Jacobs No.	B2103501		
BIM No.	A9-A96IS-JAC-EGN-XXX-FG-EN-1105		
Drawing number	Figure 11.4b	Rev	C00

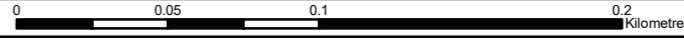

© Copyright 2019 Jacobs U.K. Limited. The concepts and information contained in this document are the property of Jacobs. Use or copying of this document in whole or in part without the written permission of Jacobs constitutes an infringement of copyright. Limitation: This drawing has been prepared on behalf of, and for the exclusive use of Jacobs' Client, and is subject to, and issued in accordance with, the provisions of the contract between Jacobs and the Client. Jacobs accepts no liability or responsibility whatsoever for, or in respect of, any use of, or reliance upon, this drawing by any third party.

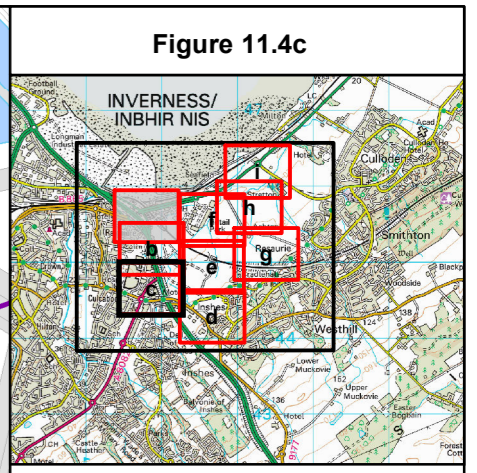
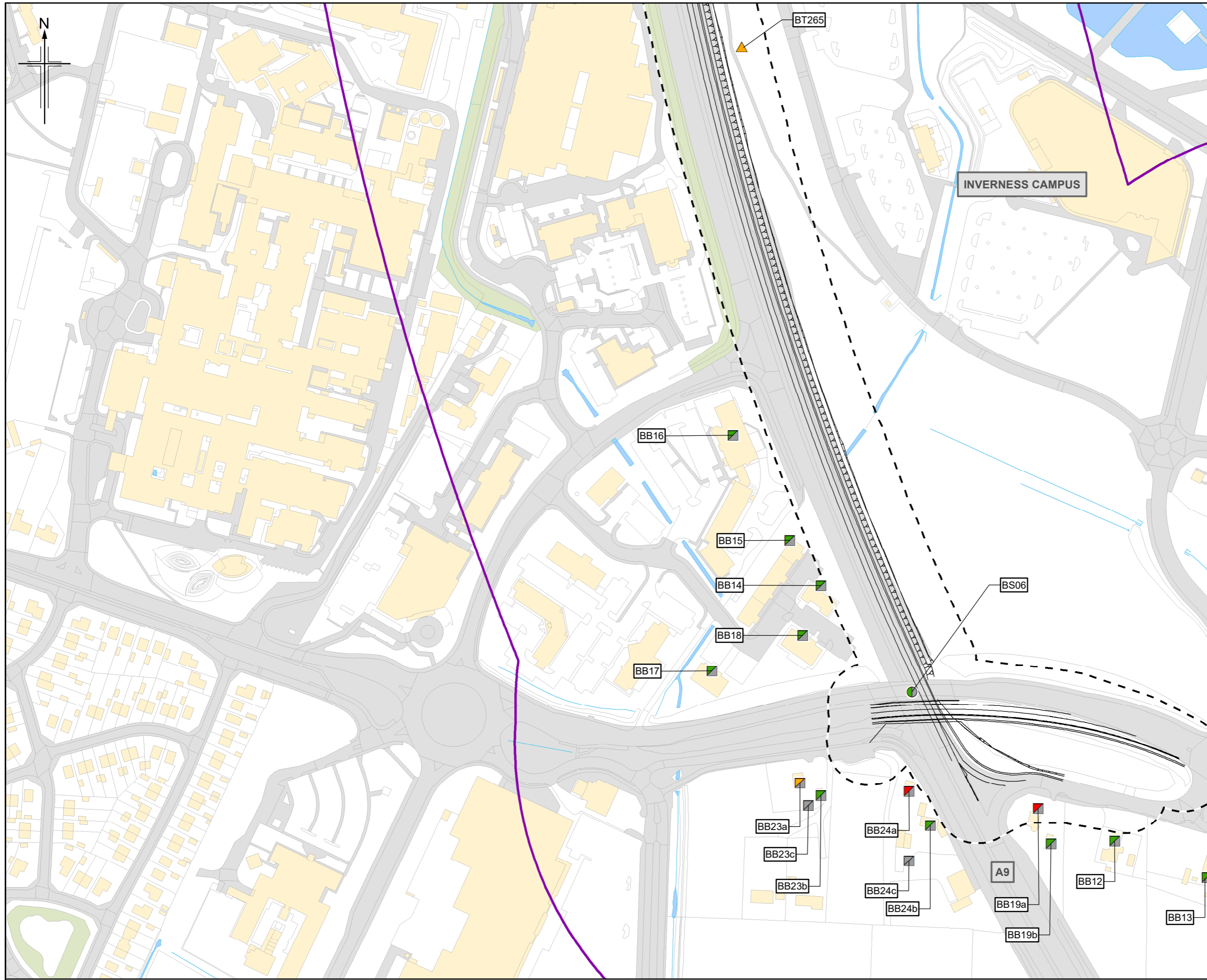

Legend

- Proposed Scheme (DMRB Stage 3 design)
- A96 Dualling Inverness to Nairn (including Nairn Bypass) Scheme Proposals
- Consented Development Under Construction (as of April 2019)
- 30m Roost Survey Study
- 250m Ground-based Assessment Study Area

Bat Survey Results

- SRP* WRP* Structure
- SRP* WRP* Building
- SRP* WRP* Tree

Bat Roost Potential

- High
- Moderate
- Low
- Negligible

*SRP - Summer Roosting Potential
WRP - Winter Roosting Potential

CS0	SEPT 2019	EAIR Publication	CS	RBH	KL	DGC
Rev.	Rev. Date	Purpose of revision	Orig/Dwn	Checkd	Rev'd	Apprv'd

JACOBS
95 Botwell Street, Glasgow, G2 7HX, UK
Tel: +44(0)141 243 9000
www.jacobs.com

Client

TRANSPORT SCOTLAND
COMHDAIL ALBA

Project
A9/A96 Inshes to Smihton

Drawing title
**DMRB Stage 3 EAIR
Bat Roost Survey Results**

Sheet 3 of 9

Drawing Status	A - APPROVED AS STAGE COMPLETE		
Scale	1:2,500	@ A3	DO NOT SCALE
Jacobs No.	B2103501		
BIM No.	A9-A96IS-JAC-EGN-XXX-FG-EN-1106		
Drawing number	Figure 11.4c	Rev	C00

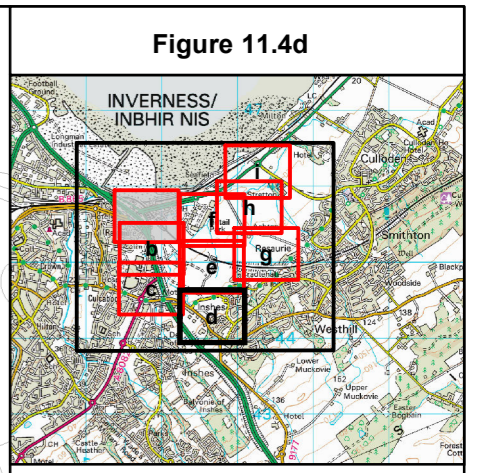
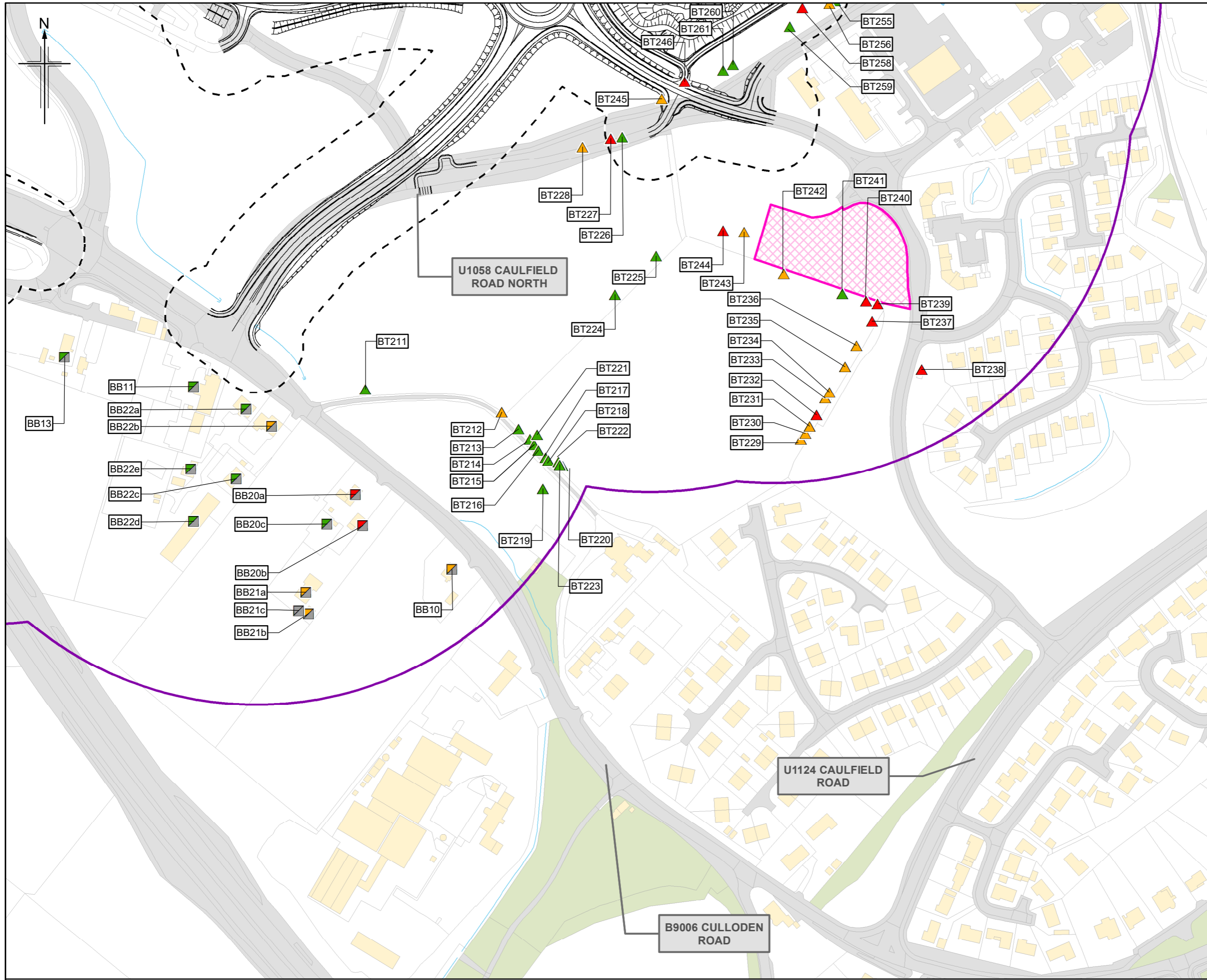

Legend

- Proposed Scheme (DMRB Stage 3 design)
- A96 Dualling Inverness to Nairn (including Nairn Bypass) Scheme Proposals
- Consented Development Under Construction (as of April 2019)
- 30m Roost Survey Study
- 250m Ground-based Assessment Study Area

Bat Survey Results

- SRP* WRP* Structure
- SRP* WRP* Building
- SRP* WRP* Tree

Bat Roost Potential

- High
- Moderate
- Low
- Negligible

*SRP - Summer Roosting Potential
WRP - Winter Roosting Potential

CS0	SEPT 2019	EAIR Publication	CS	RBH	KL	DGC
Rev.	Rev. Date	Purpose of revision	Orig/Dwn	Checkd	Rev'd	Apprv'd

JACOBS
95 Botwell Street, Glasgow, G2 7HX, UK
Tel: +44(0)141 243 9000
www.jacobs.com

Client

TRANSPORT SCOTLAND
COMHDAHL ALBA

Project
A9/A96 Inshes to Smihton

Drawing title
**DMRB Stage 3 EAIR
Bat Roost Survey Results**

Sheet 4 of 9

Drawing Status	A - APPROVED AS STAGE COMPLETE		
Scale	1:2,500	@ A3	DO NOT SCALE
Jacobs No.	B2103501		
BIM No.	A9-A96IS-JAC-EGN-XXX-FG-EN-1107		
Drawing number	Figure 11.4d	Rev	C00

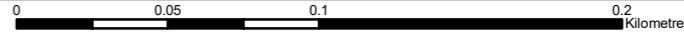

© Copyright 2019 Jacobs U.K. Limited. The concepts and information contained in this document are the property of Jacobs. Use or copying of this document in whole or in part without the written permission of Jacobs constitutes an infringement of copyright. Limitation: This drawing has been prepared on behalf of, and for the exclusive use of Jacobs' Client, and is subject to, and issued in accordance with, the provisions of the contract between Jacobs and the Client. Jacobs accepts no liability or responsibility whatsoever for, or in respect of, any use of, or reliance upon, this drawing by any third party.

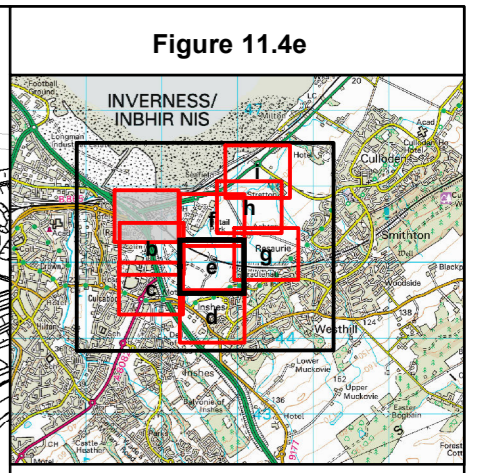
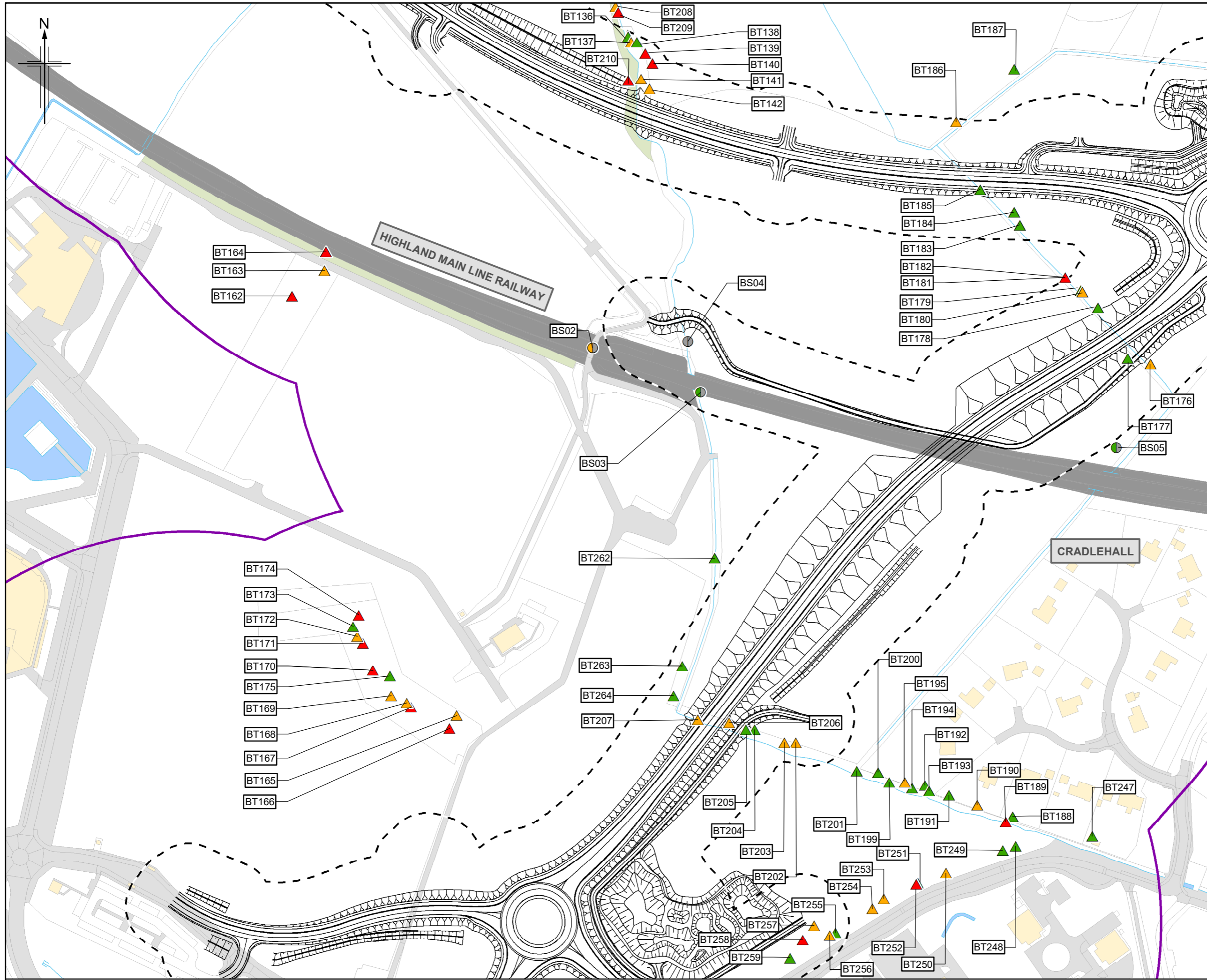

Legend

- Proposed Scheme (DMRB Stage 3 design)
- A96 Dualling Inverness to Nairn (including Nairn Bypass) Scheme Proposals
- Consented Development Under Construction (as of April 2019)
- 30m Roost Survey Study
- 250m Ground-based Assessment Study Area

Bat Survey Results

- SRP* WRP* Structure
- SRP* WRP* Building
- SRP* WRP* Tree

Bat Roost Potential

- High
- Moderate
- Low
- Negligible

*SRP - Summer Roosting Potential
WRP - Winter Roosting Potential

C90	SEPT 2019	EAIR Publication	CS	RBH	KL	DGC
Rev.	Rev. Date	Purpose of revision	Orig/Dwn	Checkd	Rev'd	Apprv'd
JACOBS 95 Botwell Street, Glasgow, G2 7HX, UK Tel: +44(0)141 243 9000 www.jacobs.com						
Client						
 TRANSPORT SCOTLAND COMHDAIL ALBA						
Project						
A9/A96 Inshes to Smihton						
Drawing title						
DMRB Stage 3 EAIR Bat Roost Survey Results						
Sheet 5 of 9						
Drawing Status						
A - APPROVED AS STAGE COMPLETE						
Scale						
1:2,500 @ A3 DO NOT SCALE						
Jacobs No.						
B2103501						
BIM No.						
A9-A96IS-JAC-EGN-XXX-FG-EN-1108						
Drawing number						
Figure 11.4e						Rev C00
© Copyright 2019 Jacobs U.K. Limited. The concepts and information contained in this document are the property of Jacobs. Use or copying of this document in whole or in part without the written permission of Jacobs constitutes an infringement of copyright. Limitation: This drawing has been prepared on behalf of, and for the exclusive use of Jacobs' Client, and is subject to, and issued in accordance with, the provisions of the contract between Jacobs and the Client. Jacobs accepts no liability or responsibility whatsoever for, or in respect of, any use of, or reliance upon, this drawing by any third party.						

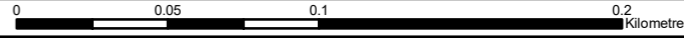

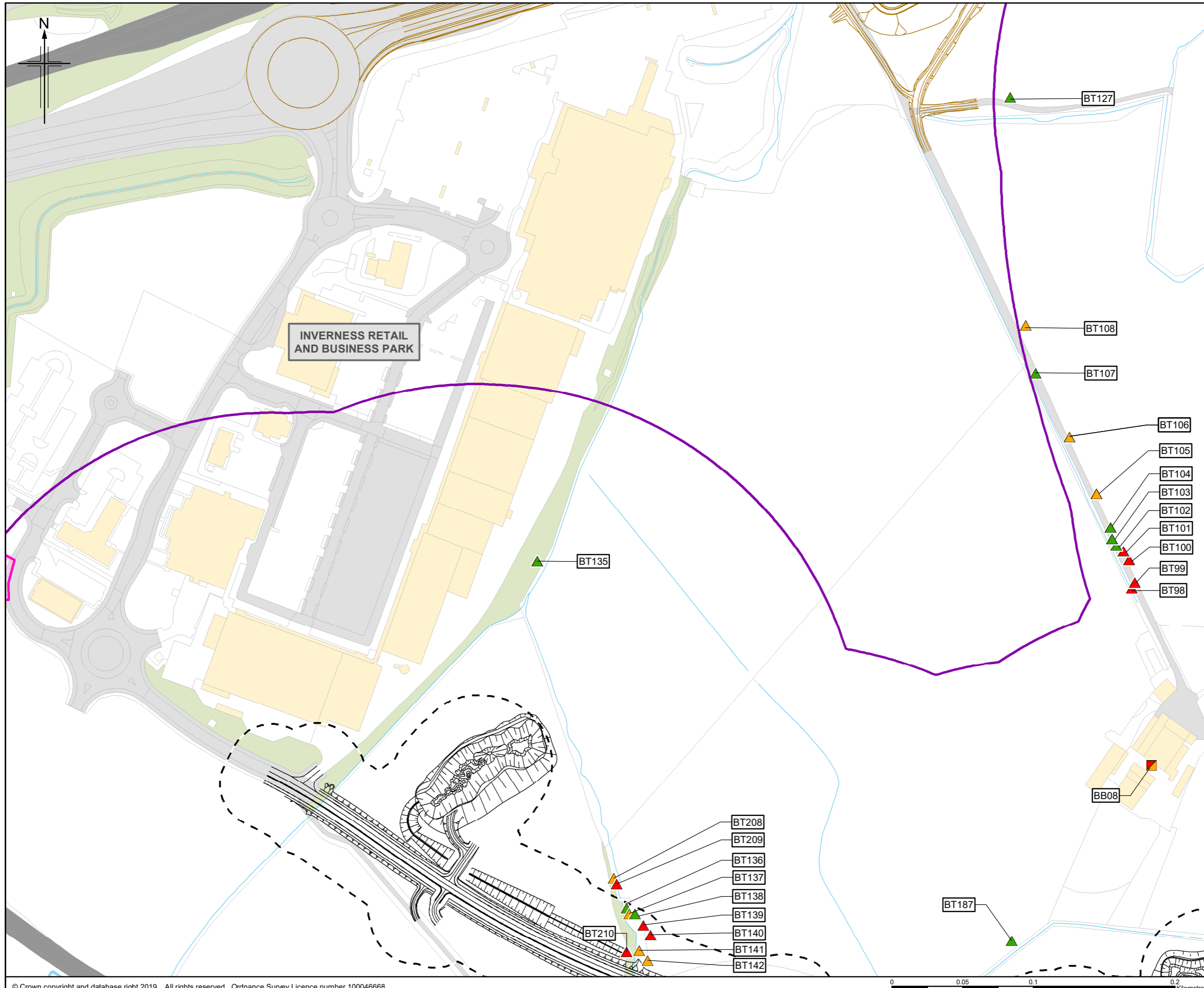

Figure 11.4f



Legend

- Proposed Scheme (DMRB Stage 3 design)
- A96 Dualling Inverness to Nairn (including Nairn Bypass) Scheme Proposals
- Consented Development Under Construction (as of April 2019)
- 30m Roost Survey Study
- 250m Ground-based Assessment Study Area

Bat Survey Results

- SRP* WRP* Structure
- SRP* WRP* Building
- SRP* WRP* Tree

Bat Roost Potential

- High
- Moderate
- Low
- Negligible

*SRP - Summer Roosting Potential
WRP - Winter Roosting Potential

C00	SEPT 2019	EIAR Publication	CS	RBH	KL	DGC
Rev.	Rev. Date	Purpose of revision	Orig/Dwn	Checkd	Rev'd	Apprv'd



Project: **A9/A96 Inshes to Smithton**

Drawing title: **DMRB Stage 3 EIAR Bat Roost Survey Results**

Sheet 6 of 9

Drawing Status	A - APPROVED AS STAGE COMPLETE		
Scale	1:2,500	@ A3	DO NOT SCALE
Jacobs No.	B2103501		
BIM No.	A9-A96IS-JAC-EGN-XXX-FG-EN-1109		
Drawing number	Figure 11.4f	Rev	C00

© Copyright 2019 Jacobs U.K. Limited. The concepts and information contained in this document are the property of Jacobs. Use or copying of this document in whole or in part without the written permission of Jacobs constitutes an infringement of copyright. Limitation: This drawing has been prepared on behalf of, and for the exclusive use of Jacobs' Client, and is subject to, and issued in accordance with, the provisions of the contract between Jacobs and the Client. Jacobs accepts no liability or responsibility whatsoever for, or in respect of, any use of, or reliance upon, this drawing by any third party.

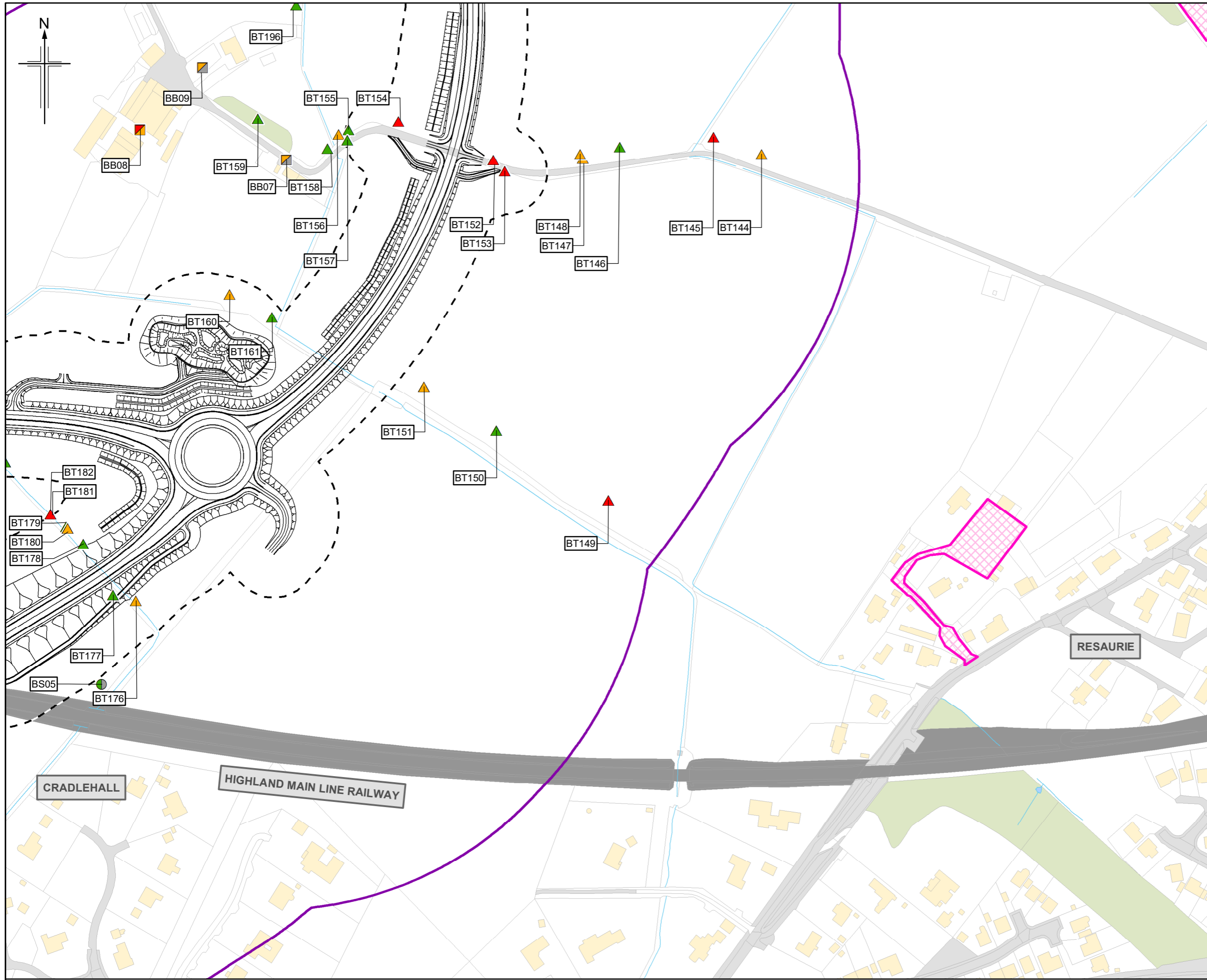
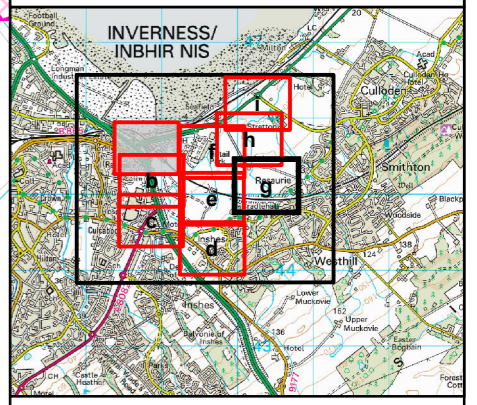

Figure 11.4g



Legend

- Proposed Scheme (DMRB Stage 3 design)
- A96 Dualling Inverness to Nairn (including Nairn Bypass) Scheme Proposals
- Consented Development Under Construction (as of April 2019)
- 30m Roost Survey Study
- 250m Ground-based Assessment Study Area

Bat Survey Results

- SRP* WRP* Structure
- SRP* WRP* Building
- SRP* Tree

Bat Roost Potential

- High
- Moderate
- Low
- Negligible

*SRP - Summer Roosting Potential
WRP - Winter Roosting Potential

C00	SEPT 2019	EIAR Publication	CS	RBH	KL	DGC
Rev.	Rev. Date	Purpose of revision	Orig/Dwn	Checkd	Rev'd	Apprv'd



Project: **A9/A96 Inshes to Smihton**

Drawing title: **DMRB Stage 3 EIAR
Bat Roost Survey Results**

Drawing Status	A - APPROVED AS STAGE COMPLETE		
Scale	1:2,500	@ A3	DO NOT SCALE
Jacobs No.	B2103501		
BIM No.	A9-A96IS-JAC-EGN-XXX-FG-EN-1110		
Drawing number	Figure 11.4g	Rev	C00

© Copyright 2019 Jacobs U.K. Limited. The concepts and information contained in this document are the property of Jacobs. Use or copying of this document in whole or in part without the written permission of Jacobs constitutes an infringement of copyright. Limitation: This drawing has been prepared on behalf of, and for the exclusive use of Jacobs' Client, and is subject to, and issued in accordance with, the provisions of the contract between Jacobs and the Client. Jacobs accepts no liability or responsibility whatsoever for, or in respect of, any use of, or reliance upon, this drawing by any third party.

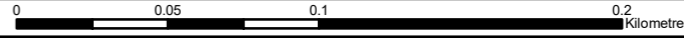

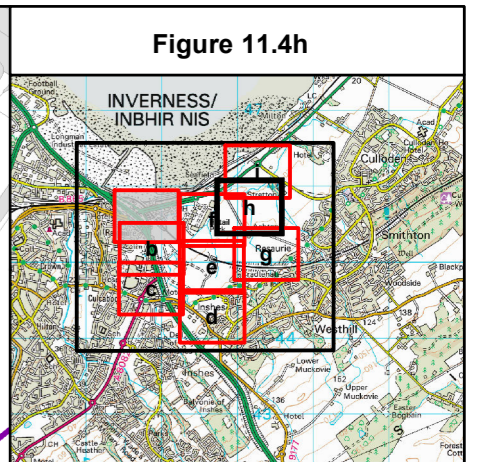
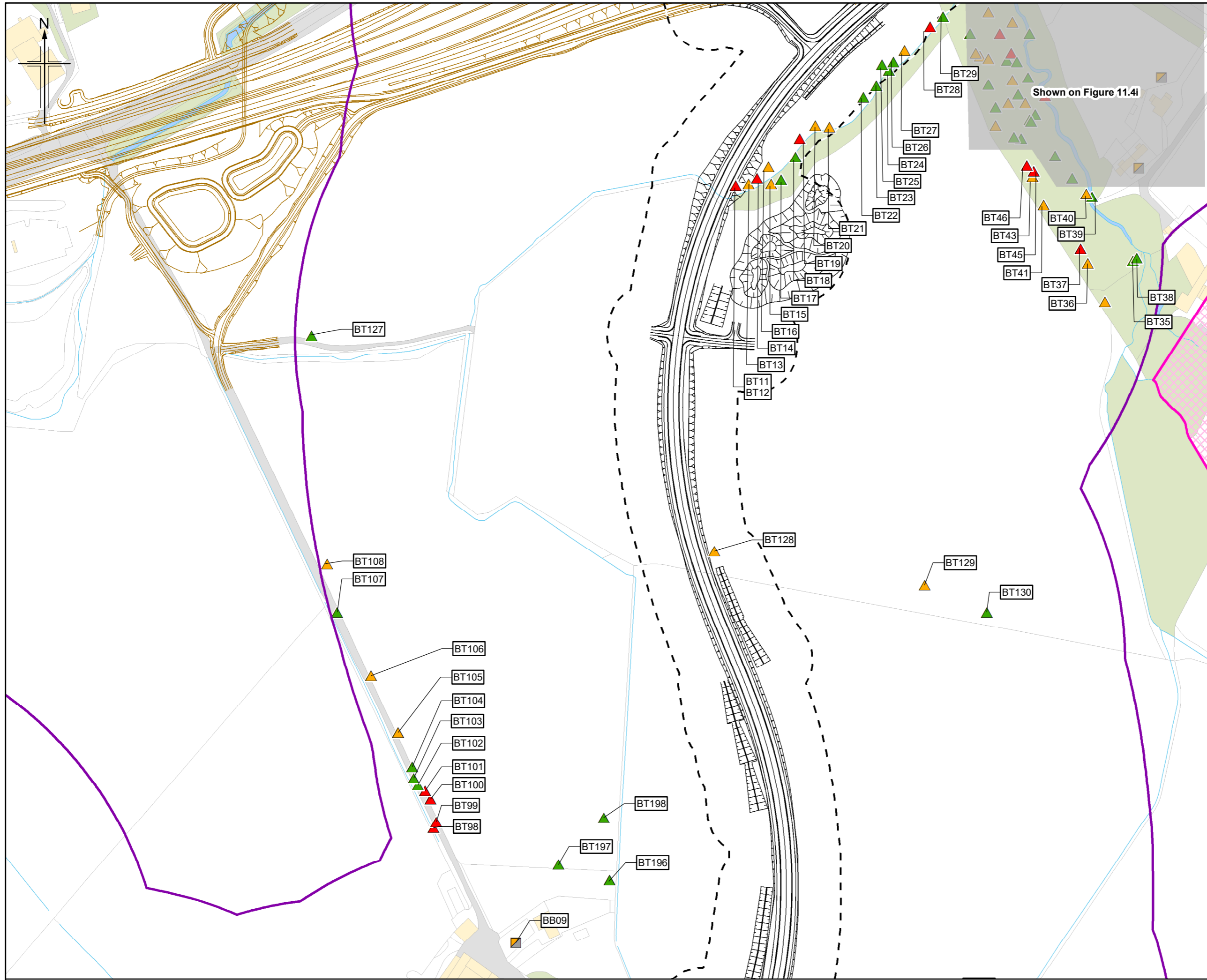

Legend

- Proposed Scheme (DMRB Stage 3 design)
- A96 Dualling Inverness to Nairn (including Nairn Bypass) Scheme Proposals
- Consented Development Under Construction (as of April 2019)
- 30m Roost Survey Study
- 250m Ground-based Assessment Study Area

Bat Survey Results

- SRP* WRP* Structure
- SRP* WRP* Building
- SRP* Tree

Bat Roost Potential

- High
- Moderate
- Low
- Negligible

*SRP - Summer Roosting Potential
WRP - Winter Roosting Potential

C00	SEPT 2019	EIAR Publication	CS	RBH	KL	DGC
Rev.	Rev. Date	Purpose of revision	Orig/Dwn	Checkd	Rev'd	Apprv'd

JACOBS
95 Botwell Street, Glasgow, G2 7HX, UK
Tel: +44(0)141 243 9000
www.jacobs.com

Client

TRANSPORT SCOTLAND
COMHDAIL ALBA

Project
A9/A96 Inshes to Smihton

Drawing title
**DMRB Stage 3 EIAR
Bat Roost Survey Results**

Sheet 8 of 9

Drawing Status	A - APPROVED AS STAGE COMPLETE		
Scale	1:2,500	@ A3	DO NOT SCALE
Jacobs No.	B2103501		
BIM No.	A9-A96IS-JAC-EGN-XXX-FG-EN-1111		
Drawing number	Figure 11.4h	Rev	C00

Figure 11.4i

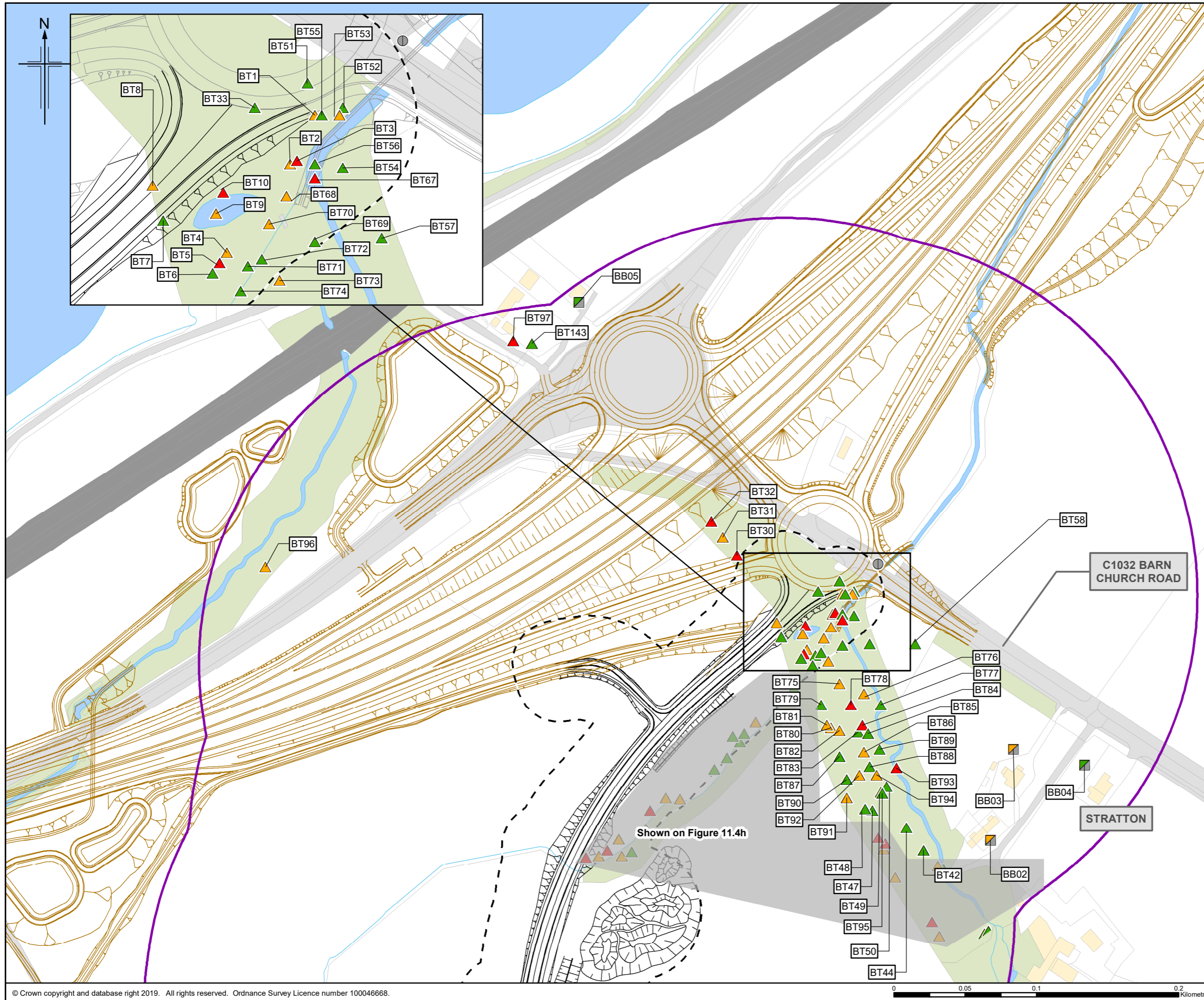
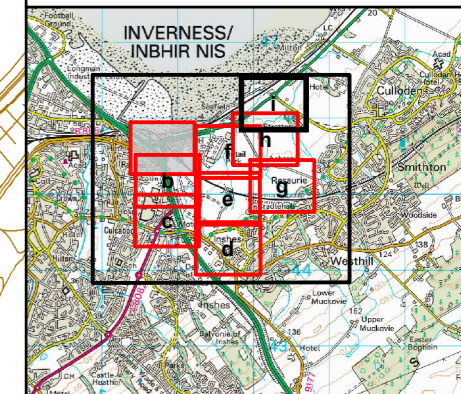

Legend

- Proposed Scheme (DMRB Stage 3 design)
- A96 Dualling Inverness to Nairn (including Nairn Bypass) Scheme Proposals
- Consented Development Under Construction (as of April 2019)
- 30m Roost Survey Study Area
- 250m Ground-based Assessment Study Area

Bat Survey Results

- SRP* WRP* Structure
- SRP* WRP* Building
- SRP* Tree

Bat Roost Potential

- High
- Moderate
- Low
- Negligible

*SRP - Summer Roosting Potential
WRP - Winter Roosting Potential

C00	SEPT 2019	EAIR Publication	CS	RBH	KL	DGC
Rev.	Rev. Date	Purpose of revision	Orig/Dwn	Checkd	Rev'd	Apprv'd



Client

TRANSPORT SCOTLAND
COMHDAIL ALBA

Project
A9/A96 Inshes to Smihton

Drawing title
**DMRB Stage 3 EAIR
Bat Roost Survey Results**

Drawing Status	A - APPROVED AS STAGE COMPLETE		
Scale	1:2,500	@ A3	DO NOT SCALE
Jacobs No.	B2103501		
BIM No.	A9-A96IS-JAC-EGN-XXX-FG-EN-1112		
Drawing number	Figure 11.4i	Rev	C00

© Copyright 2019 Jacobs U.K. Limited. The concepts and information contained in this document are the property of Jacobs. Use or copying of this document in whole or in part without the written permission of Jacobs constitutes an infringement of copyright. Limitation: This drawing has been prepared on behalf of, and for the exclusive use of Jacobs' Client, and is subject to, and issued in accordance with, the provisions of the contract between Jacobs and the Client. Jacobs accepts no liability or responsibility whatsoever for, or in respect of, any use of, or reliance upon, this drawing by any third party.

