

- Legend**
- Proposed Scheme (DMRB Stage 3 design)
  - A96 Dualling Inverness to Nairn (including Nairn Bypass) Scheme Proposals
  - 500m Study Area
  - Draft Compulsory Purchase Order (CPO) Boundary and Scottish Ministers Land
- Impact**
- Individual Tree/Group of Trees**
- No Perceived Impact
  - Potential/Partial Removal
  - Removal
- Root Protection Area (RPA)**
- No Perceived Impact
  - Potential/Partial Removal

C00	SEPT 2019	EAIR Publication	GB	DH	KL	DGC
Rev.	Rev. Date	Purpose of revision	Orig/Dwn	Checkd	Rev'd	Apprv'd

**JACOBS**  
95 Botwell Street, Glasgow, G2 7HX, UK  
Tel: +44(0)141 243 9000  
www.jacobs.com



Client  
**A9/A96 Inshes to Smithton**

Drawing title  
**DMRB Stage 3 EAIR  
Tree Constraints Plan**

Drawing Status	<b>A – APPROVED AS STAGE COMPLETE</b>		
Scale	<b>1:10,500</b>	@ A3	DO NOT SCALE
Jacobs No.	<b>B2103501</b>		
BIM No.	<b>A9-A96IS-JAC-EGN-XXX-FG-EN-1504</b>		
Drawing number	<b>Figure 15.3a</b>	Rev	<b>C00</b>

© Copyright 2019 Jacobs U.K. Limited. The concepts and information contained in this document are the property of Jacobs. Use or copying of this document in whole or in part without the written permission of Jacobs constitutes an infringement of copyright. Limitation: This drawing has been prepared on behalf of, and for the exclusive use of Jacobs' Client, and is subject to, and issued in accordance with, the provisions of the contract between Jacobs and the Client. Jacobs accepts no liability or responsibility whatsoever for, or in respect of, any use of, or reliance upon, this drawing by any third party.

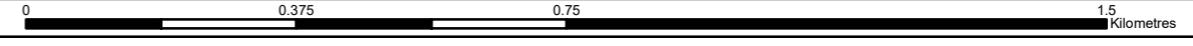

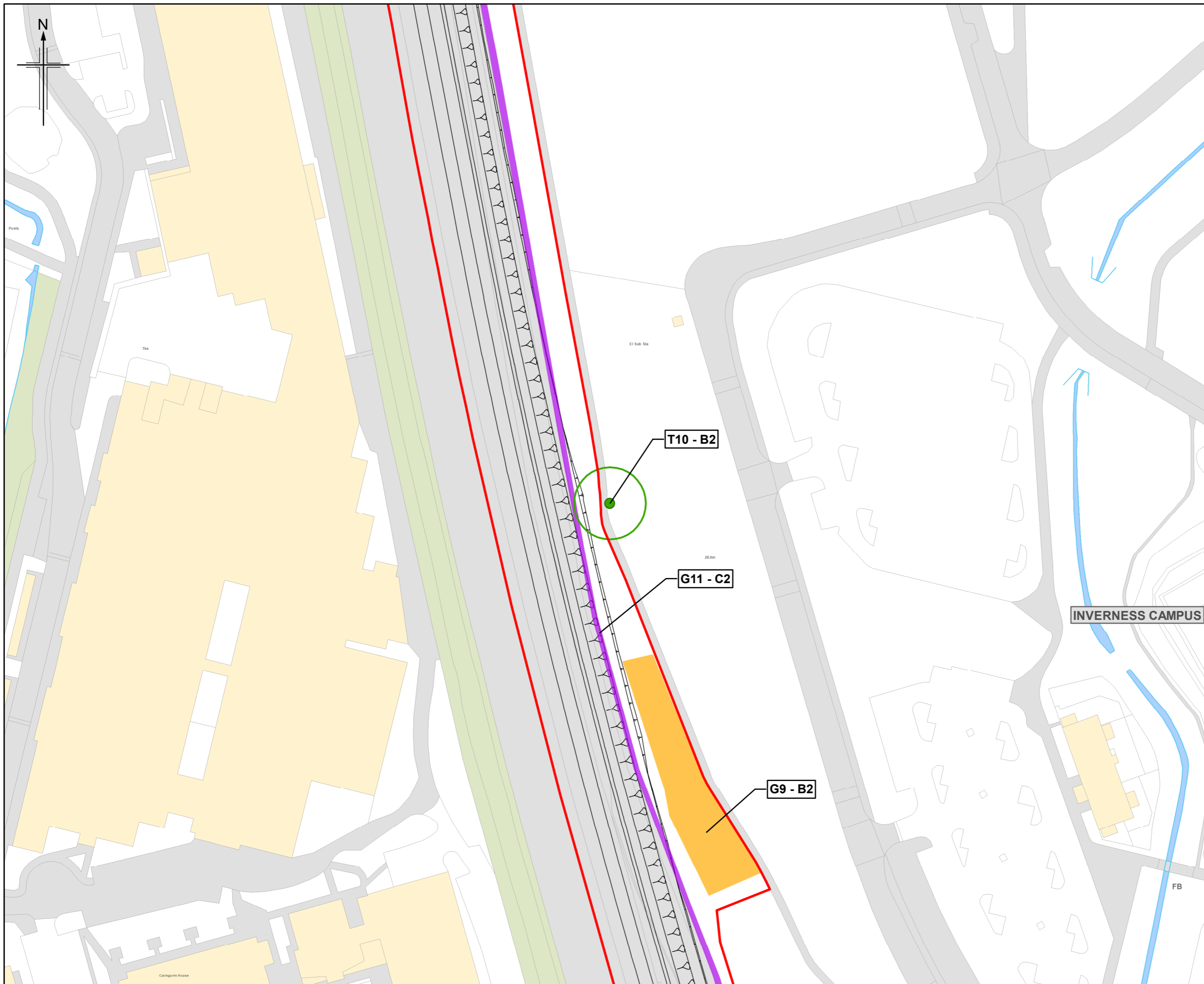
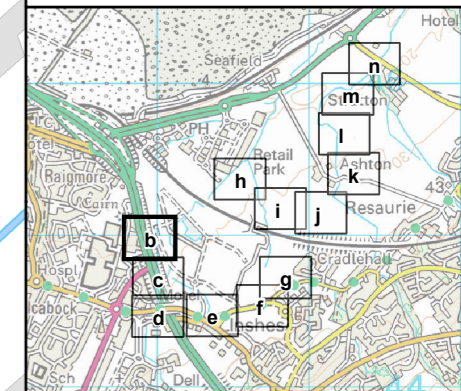

Figure 15.3b



**Legend**

- Proposed Scheme (DMRB Stage 3 design)
- A96 Dualling Inverness to Nairn (including Nairn Bypass) Scheme Proposals
- 500m Study Area
- Draft Compulsory Purchase Order (CPO) Boundary and Scottish Ministers Land

**Impact**

**Individual Tree/Group of Trees**

- No Perceived Impact
- Potential/Partial Removal
- Removal

**Root Protection Area (RPA)**

- No Perceived Impact
- Potential/Partial Removal

**Tree Identification**

- T Individual Tree
- G Group of Trees
- 123 Reference Number
- A1 Arboriculture Classification (see below table)

	1	2	3
A	High arboricultural quality	High landscape quality	High cultural / conservation quality
B	Moderate arboricultural quality	Moderate landscape quality	Moderate cultural / conservation quality
C	Low arboricultural quality	Low landscape quality	Low cultural / conservation quality
U	Trees that have a serious structural defect, trees that are dead or moribund, trees that are infected with pathogens of significance to the health and/or safety to other trees nearby, or very low quality trees suppressing adjacent trees of better quality.		

Rev.	Rev. Date	Purpose of revision	Onp/Dwn	Checkd	Rev'd	Apprv'd
C00	SEPT 2019	EIAR Publication	GB	DH	KL	DGC

**JACOBS**  
95 Botwell Street, Glasgow, G2 7HX, UK  
Tel: +44(0)141 243 9000  
www.jacobs.com



Client  
**A9/A96 Inshes to Smithton**

Project  
**DMRB Stage 3 EIAR Tree Constraints Plan**

Sheet 2 of 14

Drawing Status	<b>A - APPROVED AS STAGE COMPLETE</b>		
Scale	<b>1:1,000</b>	@ A3	<b>DO NOT SCALE</b>
Jacobs No.	<b>B2103501</b>		
BIM No.	<b>A9-A96IS-JAC-EGN-XXX-FG-EN-1505</b>		
Drawing number	<b>Figure 15.3b</b>	Rev	<b>C00</b>

© Copyright 2019 Jacobs U.K. Limited. The concepts and information contained in this document are the property of Jacobs. Use or copying of this document in whole or in part without the written permission of Jacobs constitutes an infringement of copyright. Limitation: This drawing has been prepared on behalf of, and for the exclusive use of Jacobs' Client, and is subject to, and issued in accordance with, the provisions of the contract between Jacobs and the Client. Jacobs accepts no liability or responsibility whatsoever for, or in respect of, any use of, or reliance upon, this drawing by any third party.

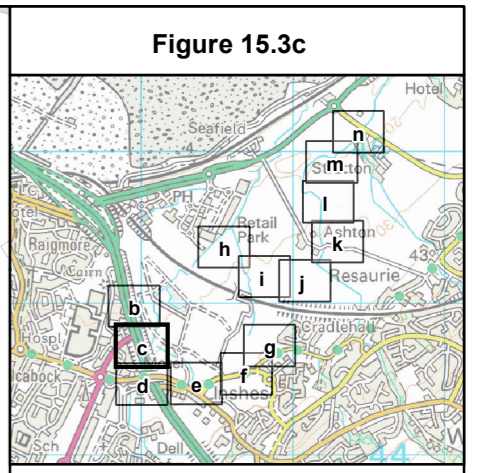
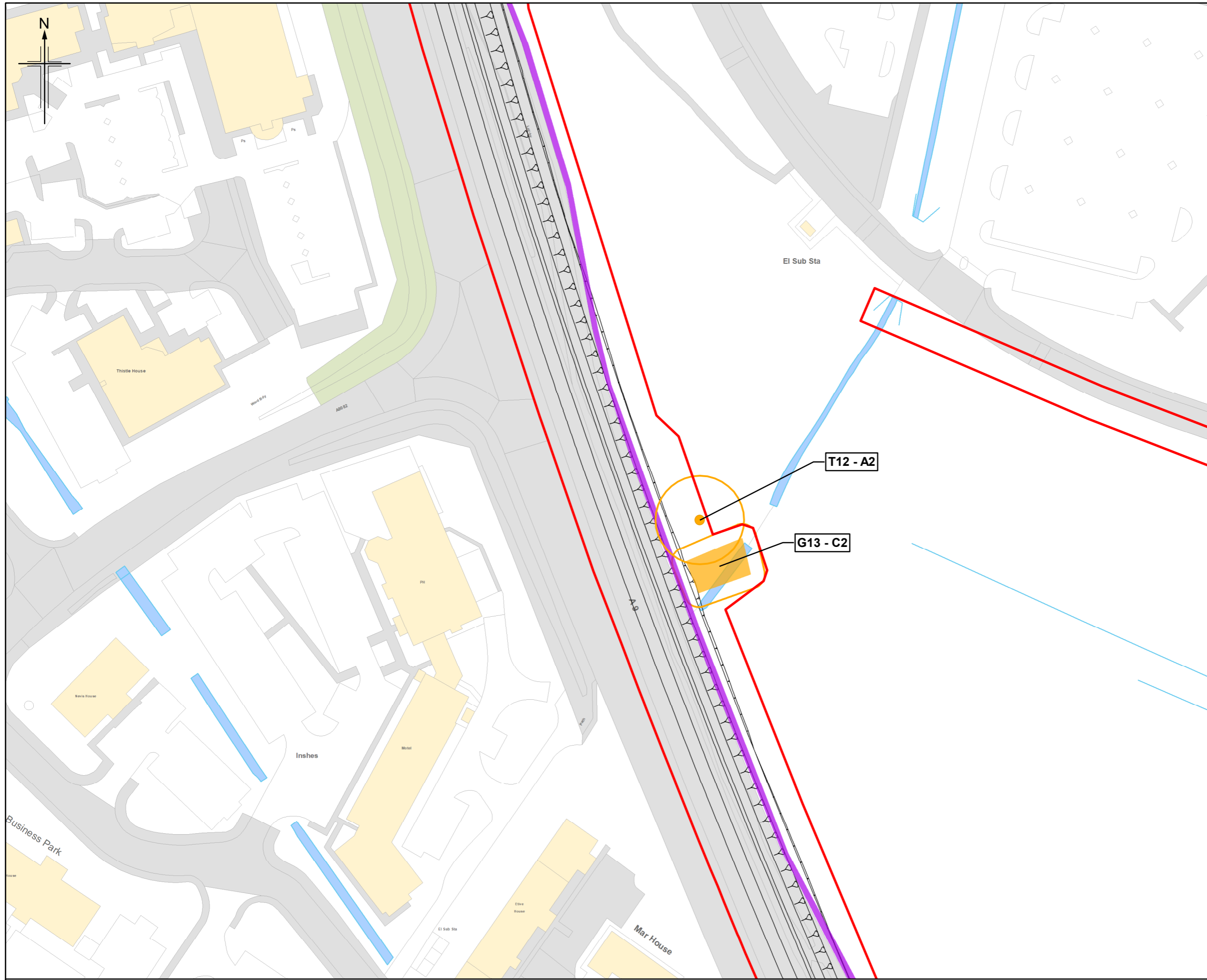

- Legend**
- Proposed Scheme (DMRB Stage 3 design)
  - A96 Dualling Inverness to Nairn (including Nairn Bypass) Scheme Proposals
  - 500m Study Area
  - Draft Compulsory Purchase Order (CPO) Boundary and Scottish Ministers Land

- Impact**
- Individual Tree/Group of Trees**
- No Perceived Impact
  - Potential/Partial Removal
  - Removal

- Root Protection Area (RPA)**
- No Perceived Impact
  - Potential/Partial Removal

- Tree Identification**
- T Individual Tree
  - G Group of Trees
  - 123 Reference Number
  - A1 Arboriculture Classification (see below table)

	1	2	3
A	High arboricultural quality	High landscape quality	High cultural / conservation quality
B	Moderate arboricultural quality	Moderate landscape quality	Moderate cultural / conservation quality
C	Low arboricultural quality	Low landscape quality	Low cultural / conservation quality
U	Trees that have a serious structural defect, trees that are dead or moribund, trees that are infected with pathogens of significance to the health and/or safety to other trees nearby, or very low quality trees suppressing adjacent trees of better quality.		

Rev.	Rev. Date	Purpose of revision	Onp/Dwn	Checkd	Rev'd	Apprv'd
C00	SEPT 2019	EIAR Publication	GB	DH	KL	DGC

**JACOBS**  
 95 Botwell Street, Glasgow, G2 7HX, UK  
 Tel: +44(0)141 243 9200  
 www.jacobs.com



Client  
**A9/A96 Inshes to Smithton**

Project  
**DMRB Stage 3 EIAR Tree Constraints Plan**

**Sheet 3 of 14**

Drawing Status	<b>A - APPROVED AS STAGE COMPLETE</b>		
Scale	<b>1:1,000</b>	@ A3	DO NOT SCALE
Jacobs No.	<b>B2103501</b>		
BIM No.	<b>A9-A96IS-JAC-EGN-XXX-FG-EN-1506</b>		
Drawing number	<b>Figure 15.3c</b>	Rev	<b>C00</b>

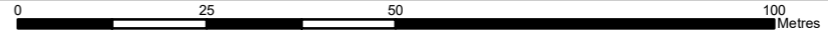

© Copyright 2019 Jacobs U.K. Limited. The concepts and information contained in this document are the property of Jacobs. Use or copying of this document in whole or in part without the written permission of Jacobs constitutes an infringement of copyright. Limitation: This drawing has been prepared on behalf of, and for the exclusive use of Jacobs' Client, and is subject to, and issued in accordance with, the provisions of the contract between Jacobs and the Client. Jacobs accepts no liability or responsibility whatsoever for, or in respect of, any use of, or reliance upon, this drawing by any third party.

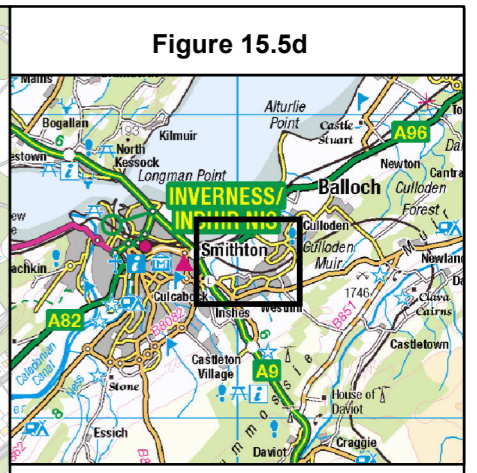
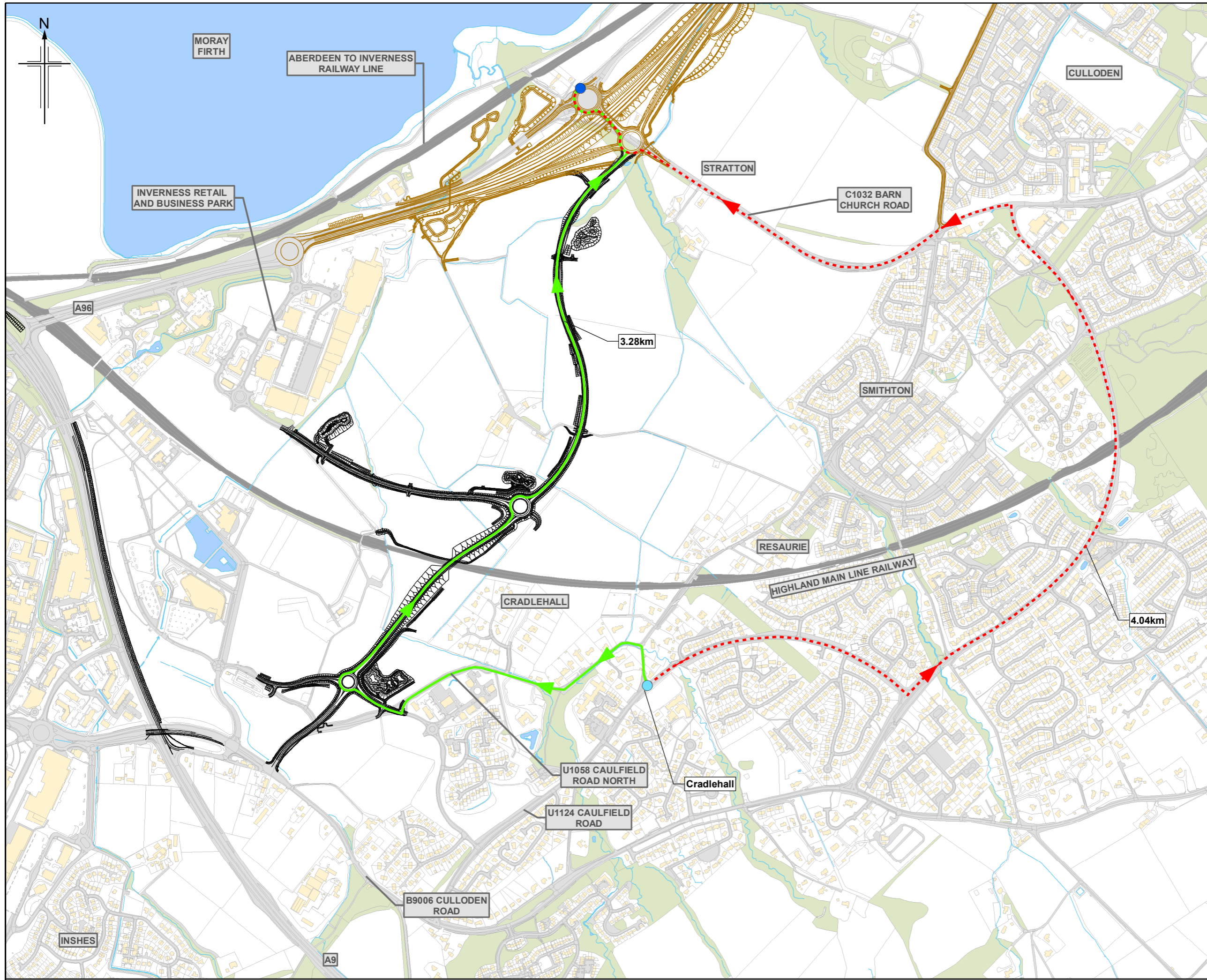

- Legend**
- Proposed Scheme (DMRB Stage 3 design)
  - A96 Dualling Inverness to Nairn (including Nairn Bypass) Scheme Proposals
- Category**
- Residential Area
  - Connection to the A96
  - Current Access Route
  - Change in Access Route

C00	SEPT 2019	EAIR Publication	CS	AN	KL	DGC
Rev.	Rev. Date	Purpose of revision	Orig/Dwn	Checkd	Rev'd	Apprv'd

**JACOBS**  
 95 Botwell Street, Glasgow, G2 7HX, UK  
 Tel: +44(0)141 243 8000  
 www.jacobs.com

Client

TRANSPORT SCOTLAND  
 COMHDAIL ALBA

Project **A9/A96 Inshes to Smيثton**

Drawing title **DMRB Stage 3 EIAR Change in Vehicle Access**

Sheet 4 of 21

Drawing Status	A - APPROVED AS STAGE COMPLETE	
Scale	1:10,000 @ A3	DO NOT SCALE
Jacobs No.	B2103501	
BIM No.	A9-A96IS-JAC-EGN-XXX-FG-EN-1525	
Drawing number	<b>Figure 15.5d</b>	Rev <b>C00</b>

Figure 15.3e

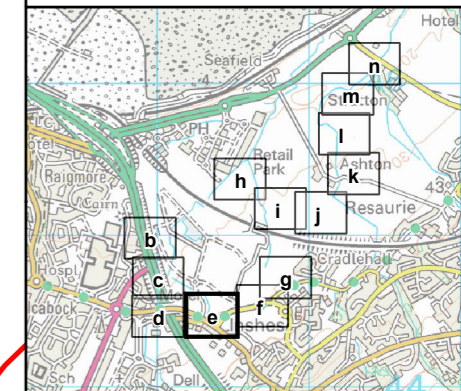

**Legend**

- Proposed Scheme (DMRB Stage 3 design)
- A96 Dualling Inverness to Nairn (including Nairn Bypass) Scheme Proposals
- 500m Study Area
- Draft Compulsory Purchase Order (CPO) Boundary and Scottish Ministers Land

**Impact**

**Individual Tree/Group of Trees**

- No Perceived Impact
- Potential/Partial Removal
- Removal

**Root Protection Area (RPA)**

- No Perceived Impact
- Potential/Partial Removal

**Tree Identification**

- T Individual Tree
- G Group of Trees
- 123 Reference Number
- A1 Arboriculture Classification (see below table)

	1	2	3
A	High arboricultural quality	High landscape quality	High cultural / conservation quality
B	Moderate arboricultural quality	Moderate landscape quality	Moderate cultural / conservation quality
C	Low arboricultural quality	Low landscape quality	Low cultural / conservation quality
U	Trees that have a serious structural defect, trees that are dead or moribund, trees that are infected with pathogens of significance to the health and/or safety to other trees nearby, or very low quality trees suppressing adjacent trees of better quality.		

Rev.	Rev. Date	Purpose of revision	Ons/Dwn	Checkd	Rev'd	Apprv'd
C00	SEPT 2019	EIAR Publication	GB	DH	KL	DGC



Project **A9/A96 Inshes to Smitton**

Drawing title **DMRB Stage 3 EIAR Tree Constraints Plan**

Sheet 5 of 14

Drawing Status	<b>A - APPROVED AS STAGE COMPLETE</b>		
Scale	<b>1:1,000</b>	@ A3	DO NOT SCALE
Jacobs No.	<b>B2103501</b>		
BIM No.	<b>A9-A96IS-JAC-EGN-XXX-FG-EN-1508</b>		
Drawing number	<b>Figure 15.3e</b>	Rev	<b>C00</b>

© Copyright 2019 Jacobs U.K. Limited. The concepts and information contained in this document are the property of Jacobs. Use or copying of this document in whole or in part without the written permission of Jacobs constitutes an infringement of copyright. Limitation: This drawing has been prepared on behalf of, and for the exclusive use of Jacobs' Client, and is subject to, and issued in accordance with, the provisions of the contract between Jacobs and the Client. Jacobs accepts no liability or responsibility whatsoever for, or in respect of, any use of, or reliance upon, this drawing by any third party.

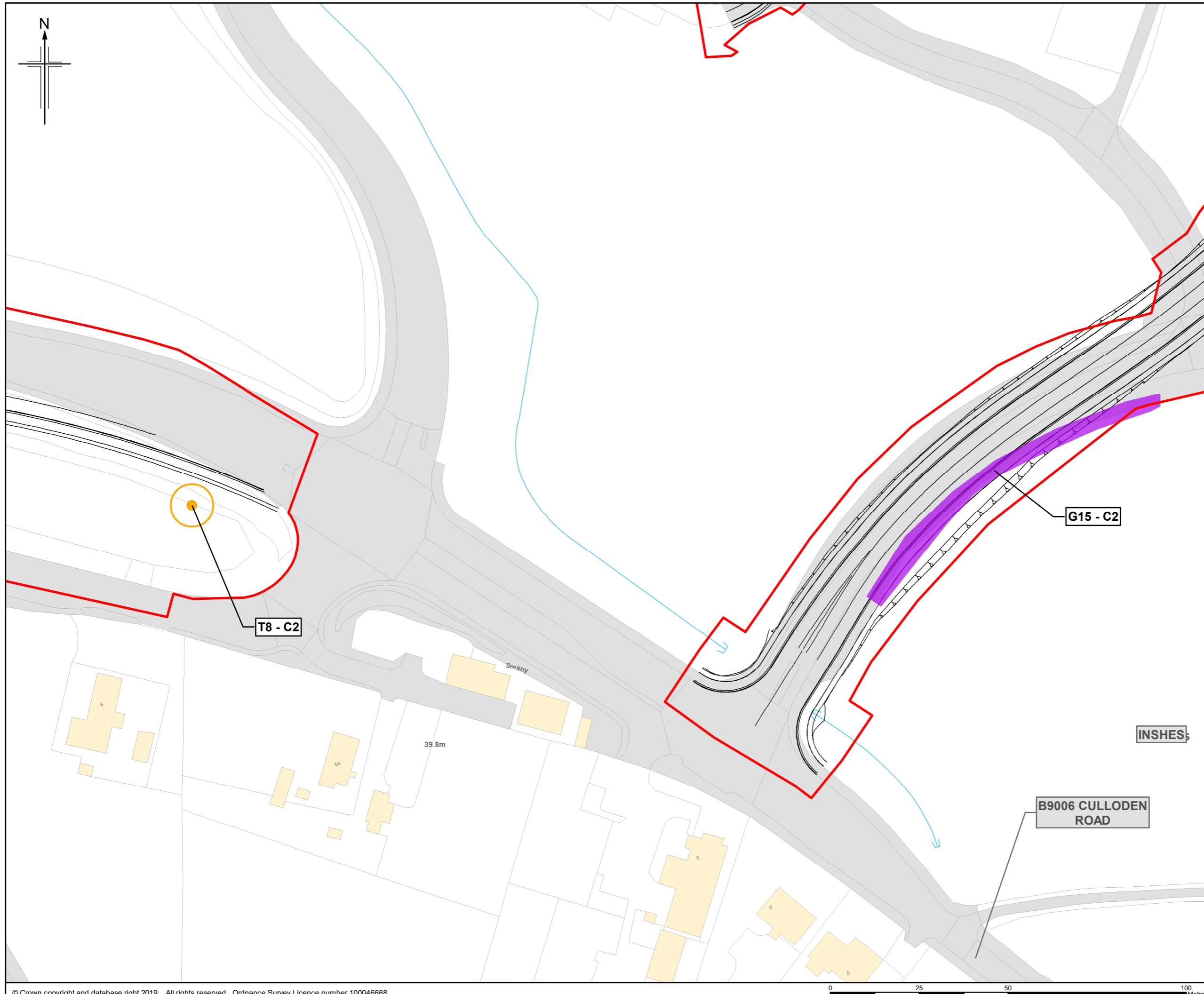

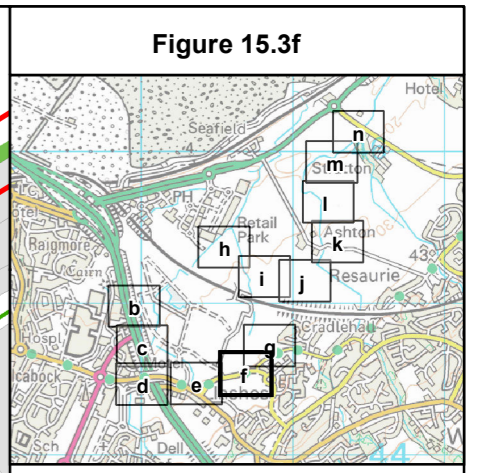
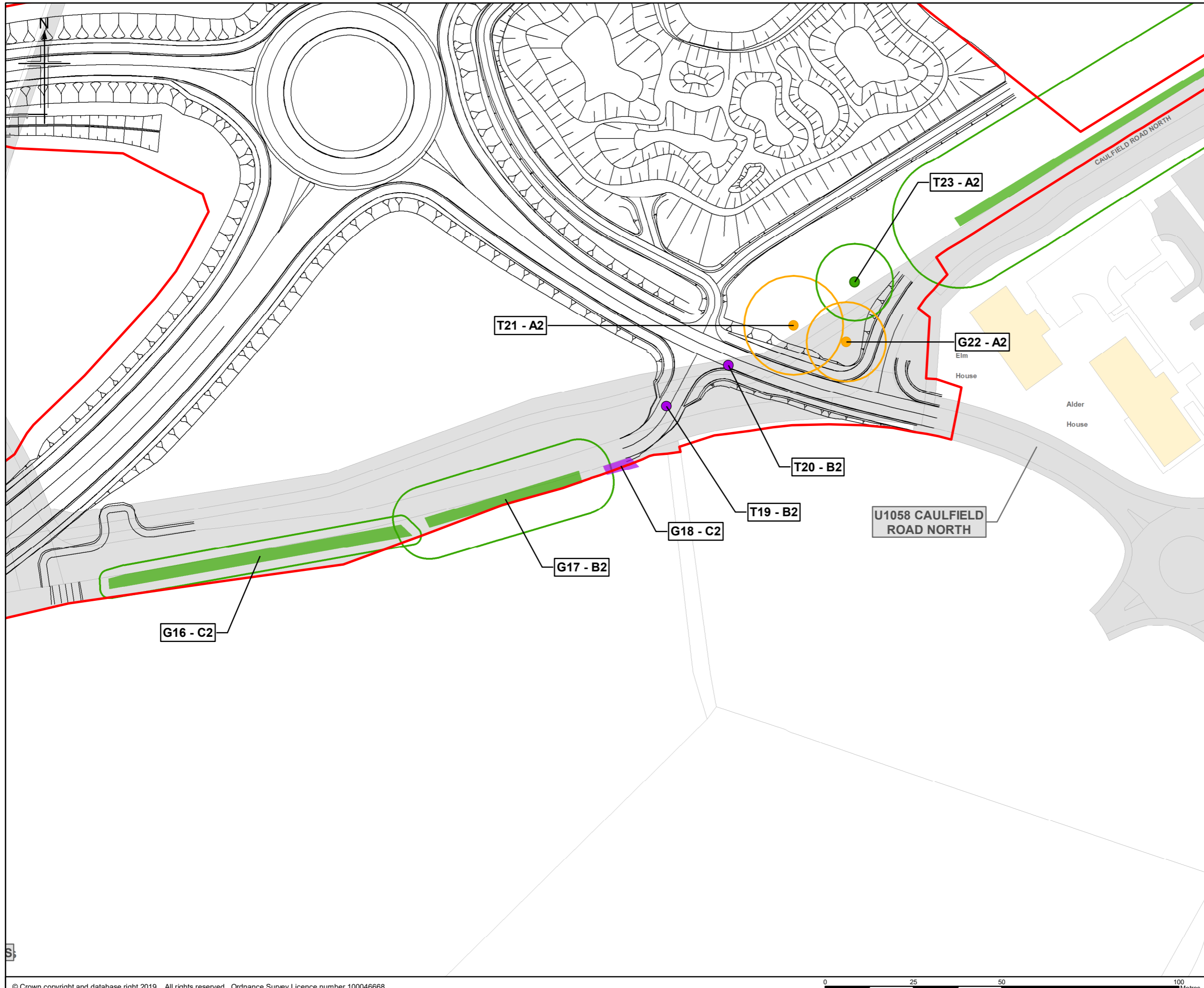

- Legend**
- Proposed Scheme (DMRB Stage 3 design)
  - A96 Dualling Inverness to Nairn (including Nairn Bypass) Scheme Proposals
  - 500m Study Area
  - Draft Compulsory Purchase Order (CPO) Boundary and Scottish Ministers Land

- Impact**
- Individual Tree/Group of Trees**
- No Perceived Impact
  - Potential/Partial Removal
  - Removal

- Root Protection Area (RPA)**
- No Perceived Impact
  - Potential/Partial Removal

- Tree Identification**
- T Individual Tree
  - G Group of Trees
  - 123 Reference Number
  - A1 Arboriculture Classification (see below table)

	1	2	3
A	High arboricultural quality	High landscape quality	High cultural / conservation quality
B	Moderate arboricultural quality	Moderate landscape quality	Moderate cultural / conservation quality
C	Low arboricultural quality	Low landscape quality	Low cultural / conservation quality
U	Trees that have a serious structural defect, trees that are dead or moribund, trees that are infected with pathogens of significance to the health and/or safety to other trees nearby, or very low quality trees suppressing adjacent trees of better quality.		

Rev.	Rev. Date	Purpose of revision	Ongr/Dwn	Checkd	Rev'd	Apprv'd
C00	SEPT 2019	EIAR Publication	GB	DH	KL	DGC

**JACOBS**  
 95 Botwell Street, Glasgow, G2 7HX, UK  
 Tel: +44(0)141 243 9000  
 www.jacobs.com

Client

TRANSPORT SCOTLAND  
 COMH-DHAIL ALBA

Project  
**A9/A96 Inshes to Smithton**

Drawing title  
**DMRB Stage 3 EIAR Tree Constraints Plan**

Sheet 6 of 14

Drawing Status	A – APPROVED AS STAGE COMPLETE		
Scale	1:1,000 @ A3	DO NOT SCALE	
Jacobs No.	B2103501		
BIM No.	A9-A96IS-JAC-EGN-XXX-FG-EN-1509		
Drawing number	Figure 15.3f	Rev	C00

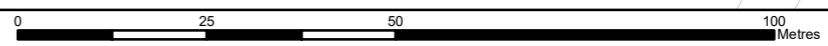

© Copyright 2019 Jacobs U.K. Limited. The concepts and information contained in this document are the property of Jacobs. Use or copying of this document in whole or in part without the written permission of Jacobs constitutes an infringement of copyright. Limitation: This drawing has been prepared on behalf of, and for the exclusive use of Jacobs' Client, and is subject to, and issued in accordance with, the provisions of the contract between Jacobs and the Client. Jacobs accepts no liability or responsibility whatsoever for, or in respect of, any use of, or reliance upon, this drawing by any third party.

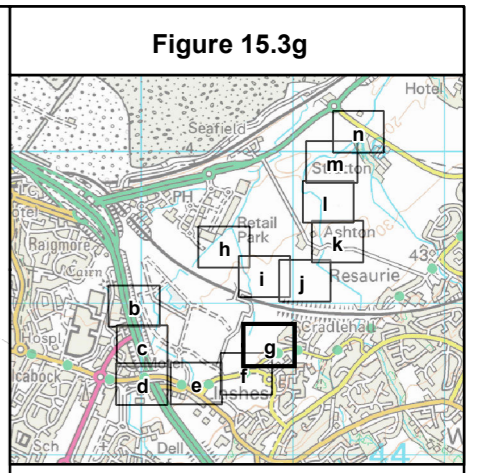
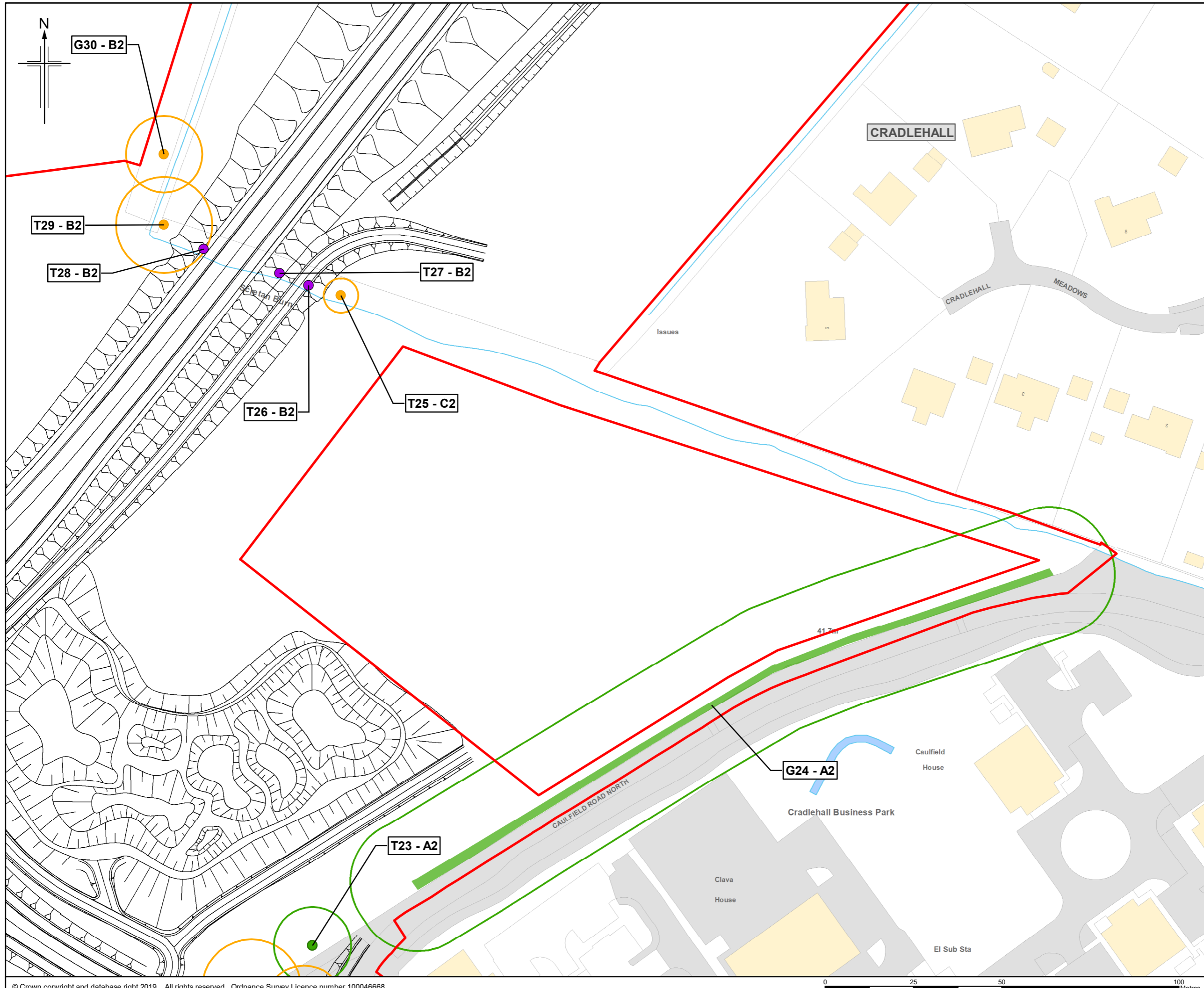

- Legend**
- Proposed Scheme (DMRB Stage 3 design)
  - A96 Dualling Inverness to Nairn (including Nairn Bypass) Scheme Proposals
  - 500m Study Area
  - Draft Compulsory Purchase Order (CPO) Boundary and Scottish Ministers Land

- Impact**
- Individual Tree/Group of Trees**
- No Perceived Impact
  - Potential/Partial Removal
  - Removal

- Root Protection Area (RPA)**
- No Perceived Impact
  - Potential/Partial Removal

- Tree Identification**
- T Individual Tree
  - G Group of Trees
  - 123 Reference Number
  - A1 Arboriculture Classification (see below table)

	1	2	3
A	High arboricultural quality	High landscape quality	High cultural / conservation quality
B	Moderate arboricultural quality	Moderate landscape quality	Moderate cultural / conservation quality
C	Low arboricultural quality	Low landscape quality	Low cultural / conservation quality
U	Trees that have a serious structural defect, trees that are dead or moribund, trees that are infected with pathogens of significance to the health and/or safety to other trees nearby, or very low quality trees suppressing adjacent trees of better quality.		

C00	SEPT 2019	EAIR Publication	GB	DH	KL	DGC
Rev.	Rev. Date	Purpose of revision	Orig/Dwn	Checkd	Rev'd	Apprv'd

**JACOBS**  
 95 Botwell Street, Glasgow, G2 7HX, UK  
 Tel: +44(0)141 243 9000  
 www.jacobs.com

Client

TRANSPORT SCOTLAND  
 COMHDAIL ALBA

Project  
**A9/A96 Inshes to Smitton**

Drawing title  
**DMRB Stage 3 EAIR Tree Constraints Plan**

Sheet 7 of 14

Drawing Status	<b>A - APPROVED AS STAGE COMPLETE</b>		
Scale	<b>1:1,000</b>	@ A3	DO NOT SCALE
Jacobs No.	<b>B2103501</b>		
BIM No.	<b>A9-A96IS-JAC-EGN-XXX-FG-EN-1510</b>		
Drawing number	<b>Figure 15.3g</b>	Rev	<b>C00</b>

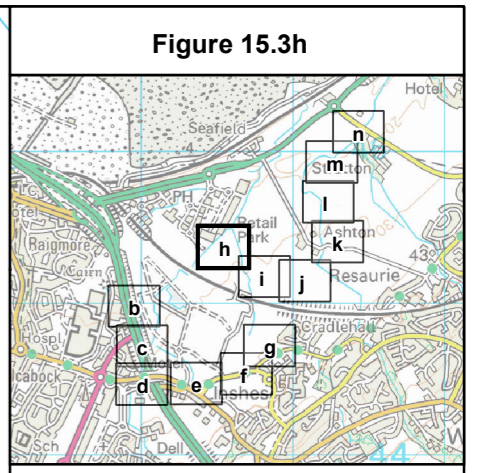
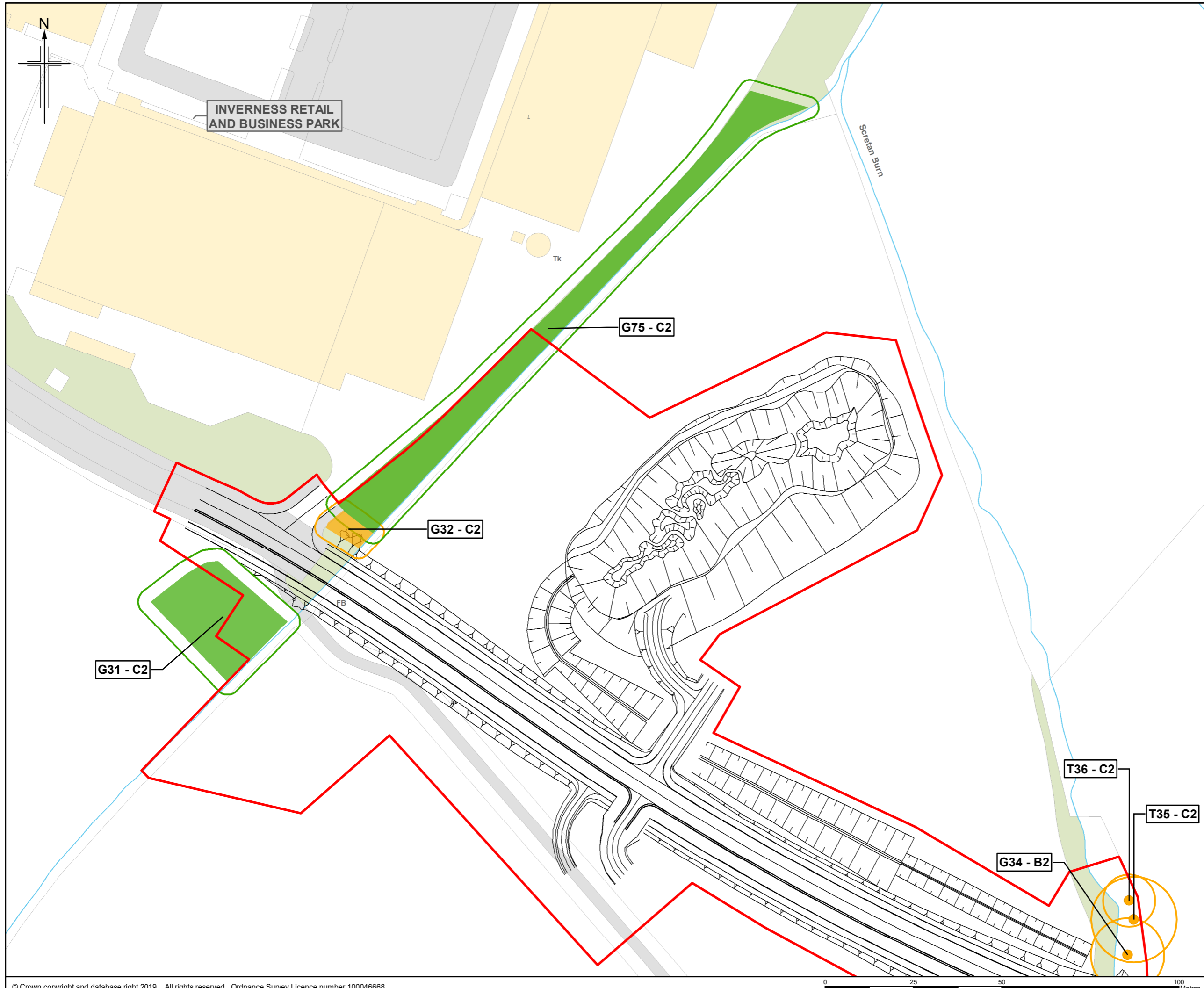

- Legend**
- Proposed Scheme (DMRB Stage 3 design)
  - A96 Dualling Inverness to Nairn (including Nairn Bypass) Scheme Proposals
  - 500m Study Area
  - Draft Compulsory Purchase Order (CPO) Boundary and Scottish Ministers Land

- Impact**
- Individual Tree/Group of Trees**
- No Perceived Impact
  - Potential/Partial Removal
  - Removal

- Root Protection Area (RPA)**
- No Perceived Impact
  - Potential/Partial Removal

- Tree Identification**
- T Individual Tree
  - G Group of Trees
  - 123 Reference Number
  - A1 Arboriculture Classification (see below table)

	1	2	3
A	High arboricultural quality	High landscape quality	High cultural / conservation quality
B	Moderate arboricultural quality	Moderate landscape quality	Moderate cultural / conservation quality
C	Low arboricultural quality	Low landscape quality	Low cultural / conservation quality
U	Trees that have a serious structural defect, trees that are dead or moribund, trees that are infected with pathogens of significance to the health and/or safety to other trees nearby, or very low quality trees suppressing adjacent trees of better quality.		

Rev.	Rev. Date	Purpose of revision	Ons/Dwn	Checkd	Rev'd	Apprv'd
C00	SEPT 2019	EAIR Publication	GB	DH	KL	DGC

**JACOBS**  
 95 Botwell Street, Glasgow, G2 7HX, UK  
 Tel: +44(0)141 243 9000  
 www.jacobs.com



Client  
**Transport Scotland**

Project  
**A9/A96 Inshes to Smithton**

Drawing title  
**DMRB Stage 3 EAIR Tree Constraints Plan**

Drawing number  
**Figure 15.3h**

Rev  
**C00**



Figure 15.3i

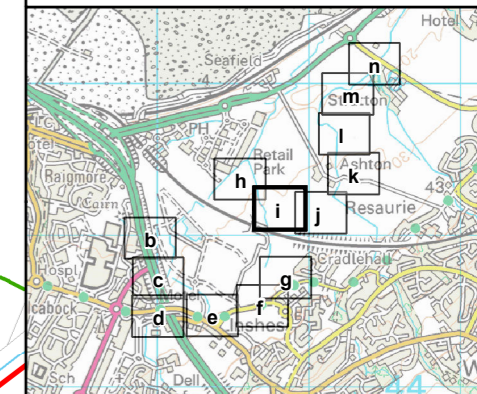
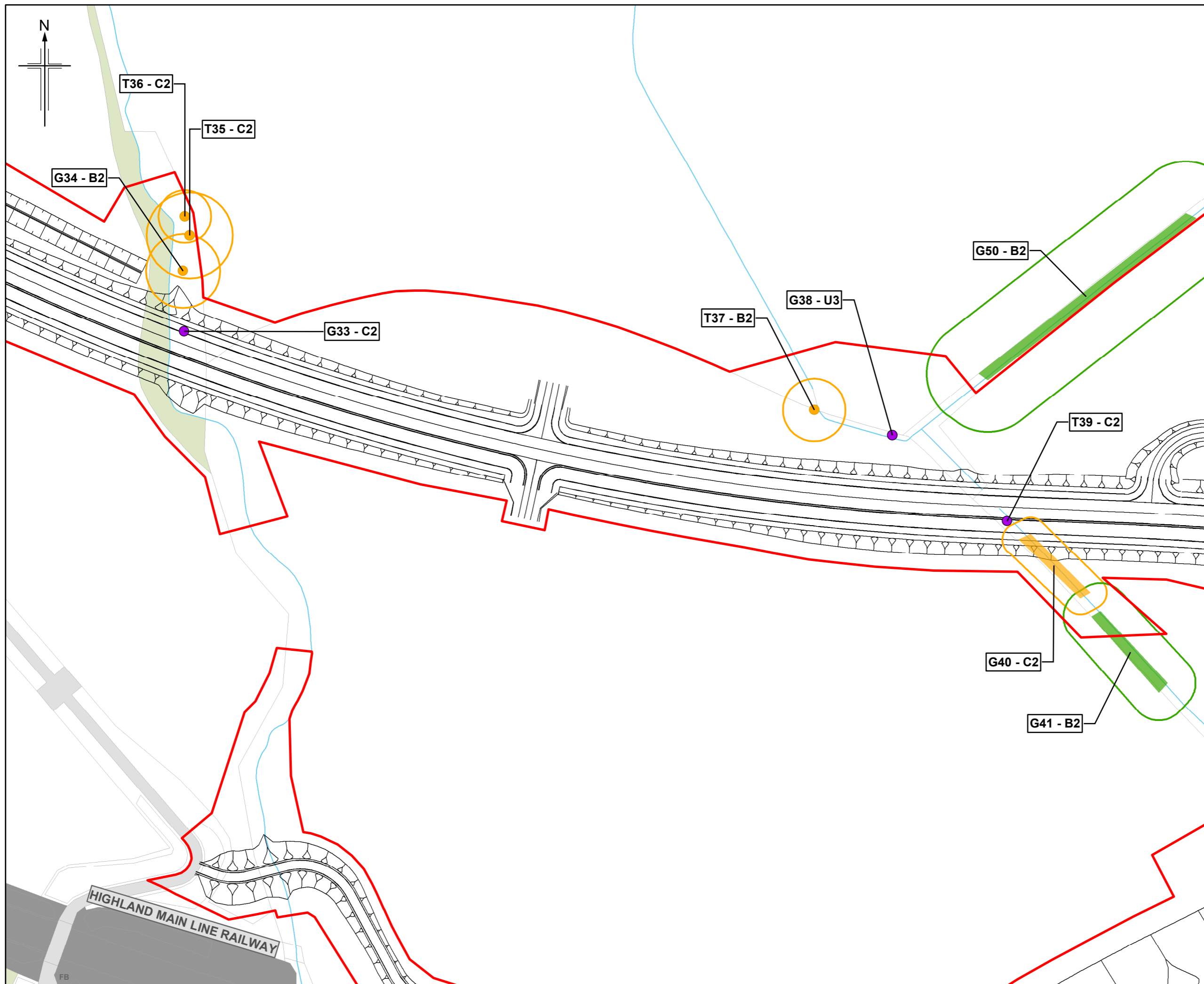

- Legend**
- Proposed Scheme (DMRB Stage 3 design)
  - A96 Dualling Inverness to Nairn (including Nairn Bypass) Scheme Proposals
  - 500m Study Area
  - Draft Compulsory Purchase Order (CPO) Boundary and Scottish Ministers Land

- Impact**
- Individual Tree/Group of Trees**
- No Perceived Impact
  - Potential/Partial Removal
  - Removal

- Root Protection Area (RPA)**
- No Perceived Impact
  - Potential/Partial Removal

- Tree Identification**
- T Individual Tree
  - G Group of Trees
  - 123 Reference Number
  - A1 Arboriculture Classification (see below table)

	1	2	3
A	High arboricultural quality	High landscape quality	High cultural / conservation quality
B	Moderate arboricultural quality	Moderate landscape quality	Moderate cultural / conservation quality
C	Low arboricultural quality	Low landscape quality	Low cultural / conservation quality
U	Trees that have a serious structural defect, trees that are dead or moribund, trees that are infected with pathogens of significance to the health and/or safety to other trees nearby, or very low quality trees suppressing adjacent trees of better quality.		

Rev.	Rev. Date	Purpose of revision	Onp/Dwn	Checkd	Rev'd	Apprv'd
C00	SEPT 2019	EAIR Publication	GB	DH	KL	DGC

**JACOBS**  
95 Botwell Street, Glasgow, G2 7HX, UK  
Tel: +44(0)141 243 9000  
www.jacobs.com



Client  
**A9/A96 Inshes to Smithton**

Drawing title  
**DMRB Stage 3 EAIR Tree Constraints Plan**

Sheet 9 of 14

Drawing Status	A – APPROVED AS STAGE COMPLETE		
Scale	1:1,000	@ A3	DO NOT SCALE
Jacobs No.	B2103501		
BIM No.	A9-A96IS-JAC-EGN-XXX-FG-EN-1512		
Drawing number	Figure 15.3i	Rev	C00

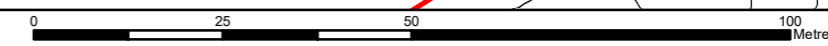

© Copyright 2019 Jacobs U.K. Limited. The concepts and information contained in this document are the property of Jacobs. Use or copying of this document in whole or in part without the written permission of Jacobs constitutes an infringement of copyright. Limitation: This drawing has been prepared on behalf of, and for the exclusive use of Jacobs' Client, and is subject to, and issued in accordance with, the provisions of the contract between Jacobs and the Client. Jacobs accepts no liability or responsibility whatsoever for, or in respect of, any use of, or reliance upon, this drawing by any third party.

Figure 15.3j

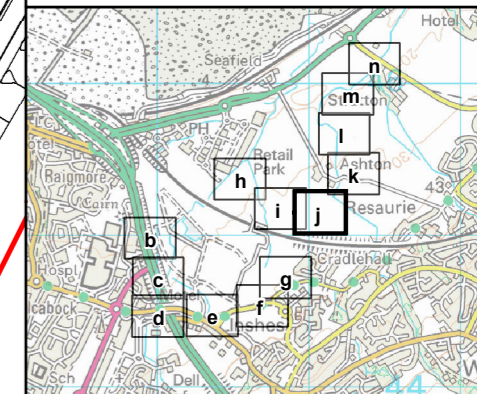
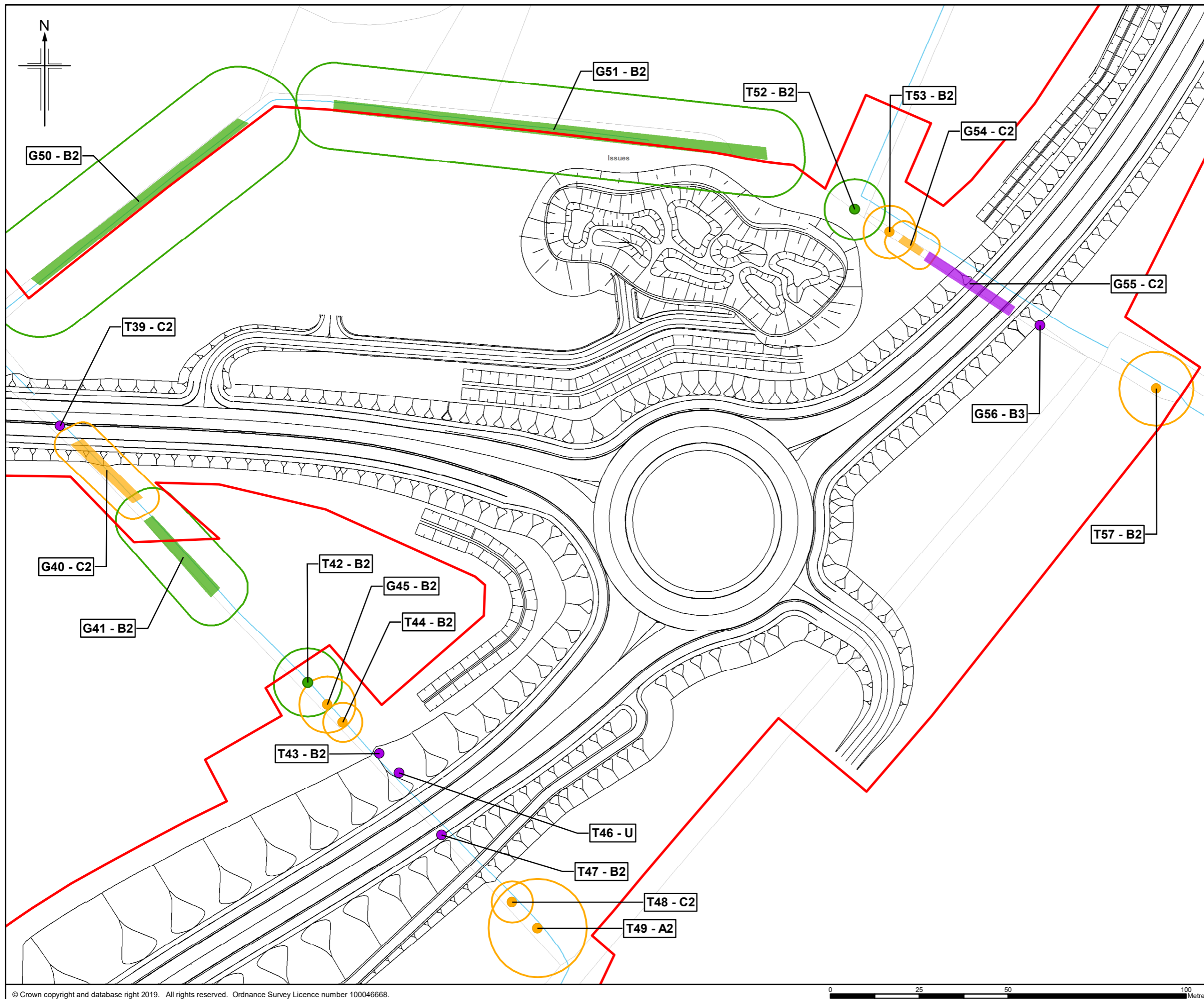

- Legend**
- Proposed Scheme (DMRB Stage 3 design)
  - A96 Dualling Inverness to Nairn (including Nairn Bypass) Scheme Proposals
  - 500m Study Area
  - Draft Compulsory Purchase Order (CPO) Boundary and Scottish Ministers Land

- Impact**
- Individual Tree/Group of Trees**
- No Perceived Impact
  - Potential/Partial Removal
  - Removal

- Root Protection Area (RPA)**
- No Perceived Impact
  - Potential/Partial Removal

- Tree Identification**
- T Individual Tree
  - G Group of Trees
  - 123 Reference Number
  - A1 Arboriculture Classification (see below table)

	1	2	3
A	High arboricultural quality	High landscape quality	High cultural / conservation quality
B	Moderate arboricultural quality	Moderate landscape quality	Moderate cultural / conservation quality
C	Low arboricultural quality	Low landscape quality	Low cultural / conservation quality
U	Trees that have a serious structural defect, trees that are dead or moribund, trees that are infected with pathogens of significance to the health and/or safety to other trees nearby, or very low quality trees suppressing adjacent trees of better quality.		

Rev.	Rev. Date	Rev. Date	Purpose of revision	Ons/Dwn	Checkd	Rev'd	Apprv'd
C00	SEPT 2019		EIAR Publication	GB	DH	KL	DGC

**JACOBS**  
 95 Botwell Street, Glasgow, G2 7HX, UK  
 Tel: +44(0)141 243 9000  
 www.jacobs.com

Client

TRANSPORT SCOTLAND  
 COMHDAIL ALBA

Project  
**A9/A96 Inshes to Smithton**

Drawing title  
**DMRB Stage 3 EIAR Tree Constraints Plan**

Sheet 10 of 14

Drawing Status	A - APPROVED AS STAGE COMPLETE		
Scale	1:1,000	@ A3	DO NOT SCALE
Jacobs No.	B2103501		
BIM No.	A9-A96IS-JAC-EGN-XXX-FG-EN-1513		
Drawing number	Figure 15.3j	Rev	C00

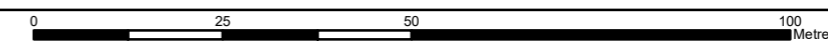

© Copyright 2019 Jacobs U.K. Limited. The concepts and information contained in this document are the property of Jacobs. Use or copying of this document in whole or in part without the written permission of Jacobs constitutes an infringement of copyright. Limitation: This drawing has been prepared on behalf of, and for the exclusive use of Jacobs' Client, and is subject to, and issued in accordance with, the provisions of the contract between Jacobs and the Client. Jacobs accepts no liability or responsibility whatsoever for, or in respect of, any use of, or reliance upon, this drawing by any third party.