

- Notes:
- OS Mastermap was obtained in February 2019 and is for illustration purposes only.
 - The design shown is for information only and is subject to further development.
 - All chainages are in metres unless noted otherwise.

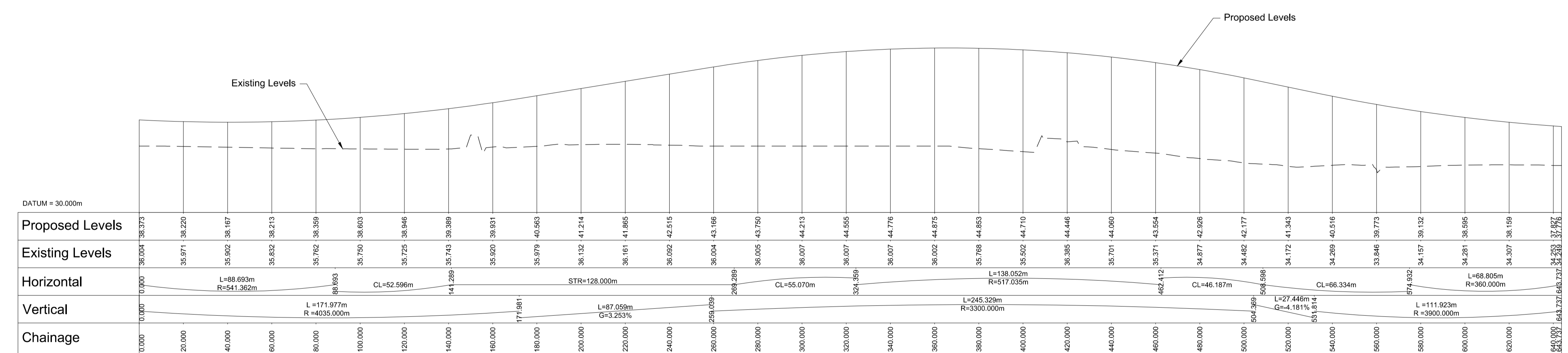

Reproduced by permission of Ordnance Survey on behalf of HMSO. © Crown copyright and database right 2019. All rights reserved. Ordnance Survey Licence number 100046668.



LINK 2 : CRADLEHALL ROUNDABOUT TO EASTFIELD WAY ROUNDABOUT LONGITUDINAL SECTION (CH. 0 - 644)
Scale 1:1250H & 1:250V @ A1

Rev	Rev. Date	Purpose of revision	Drawn	Checkd	Rev'd	Apprv'd
P00.3	20/09/19	FINAL ISSUE				

JACOBS
95 Bothwell St, Glasgow, G2 7HX
Tel: +44(0)141 243 8200 Fax: +44(0)141 226 3109
www.jacobs.com



Project: **A9/A96 INSHES TO SMITHTON**

Drawing title: **DMRB STAGE 3 SCHEME ASSESSMENT REPORT LOCAL ROAD, PLAN AND PROFILE FIGURE 3.1B**

Drawing status: **S2 - SUITABLE FOR INFORMATION**

Scale: **AS SHOWN@A1 DO NOT SCALE**

Jacobs No. **B2103501**

Drawing number: **A9-A96IS-JAC-HSR-MULTI-DR-CI-0002** Rev **P00.3**



© Copyright 2019 Jacobs U.K. Limited. The concepts and information contained in this document are the property of Jacobs. Use or copying of this document in whole or in part without the written permission of Jacobs constitutes an infringement of copyright. Limitation. This drawing has been prepared on behalf of, and for the exclusive use of, the Client, and is subject to, and issued in accordance with, the provisions of the contract between Jacobs and the Client. Jacobs accepts no liability or responsibility whatsoever for, or in respect of, any use of, or reliance upon, this drawing by any third party.