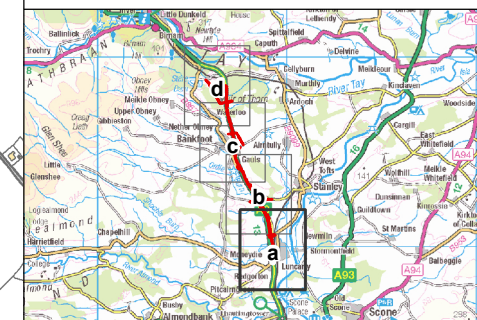
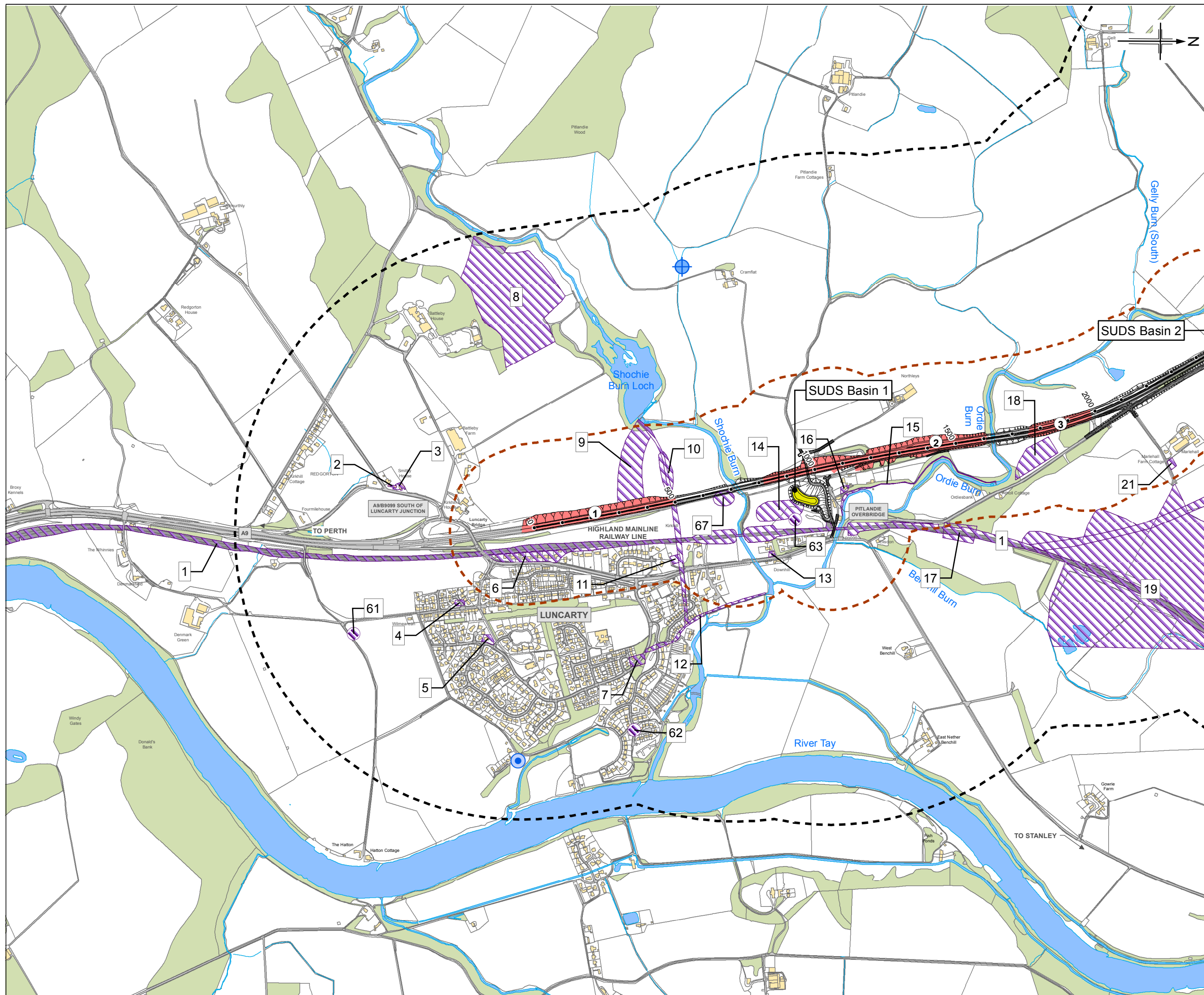

FIGURE 8.1a



- Legend**
- Proposed Scheme (DMRB Stage 3 Design)
  - 250m Study Area
  - 850m Study Area
  - Private Water Supply Users
  - Spring
  - Well
  - Unnamed pond
  - SUDS Basin
  - Contaminated Land
  - Mainline Excavation Area
  - Peat According to BGS Information
  - Peat Encountered During 2013 Ground Investigation
  - Site of Special Scientific Interest (SSSI)



0	MAR 2014	ES Publication	KA	SCRN	VSM	AG
Rev	Date	Purpose of revision	Drawn	Check'd	Rev'd	Appr'd

**JACOBS**  
 95 Botwell Street, Glasgow, G2 7HX, UK.  
 Tel: +44(0)141 204 2511 Fax: +44(0)141 226 3109  
 www.jacobs.com

**TRANSPORT SCOTLAND**  
 An agency of The Scottish Government

**A9 DUALLING**  
 PERTH TO INVERNESS  
 Luncarty to Pass of Birnam

Client	TRANSPORT SCOTLAND				
Project	A9 Dualling: Luncarty to Pass of Birnam				
Drawing Title	Potentially Contaminated Land and Hydrogeology Features				
Drawing Status	FINAL				
Scale @A3	1:12,500	DO NOT SCALE			
Jacobs No.	B1557602				
Client No.					
Drawing No.	FIGURE 8.1a	Rev	0		

Reproduced by permission of Ordnance Survey on behalf of HMSO. © Crown copyright and database right 2013. All rights reserved. Ordnance Survey Licence number 100046668.

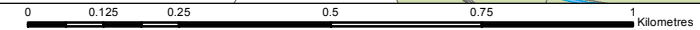

This drawing is not to be used in whole or in part other than for the intended purpose and project as defined on this drawing. Refer to the contract for full terms and conditions.

FIGURE 8.1b

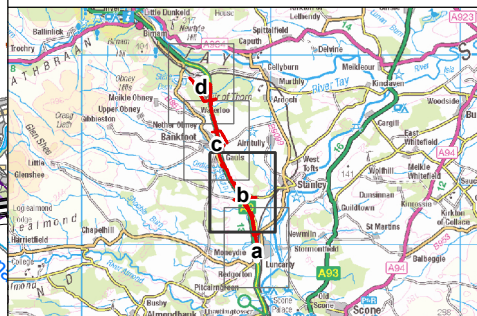
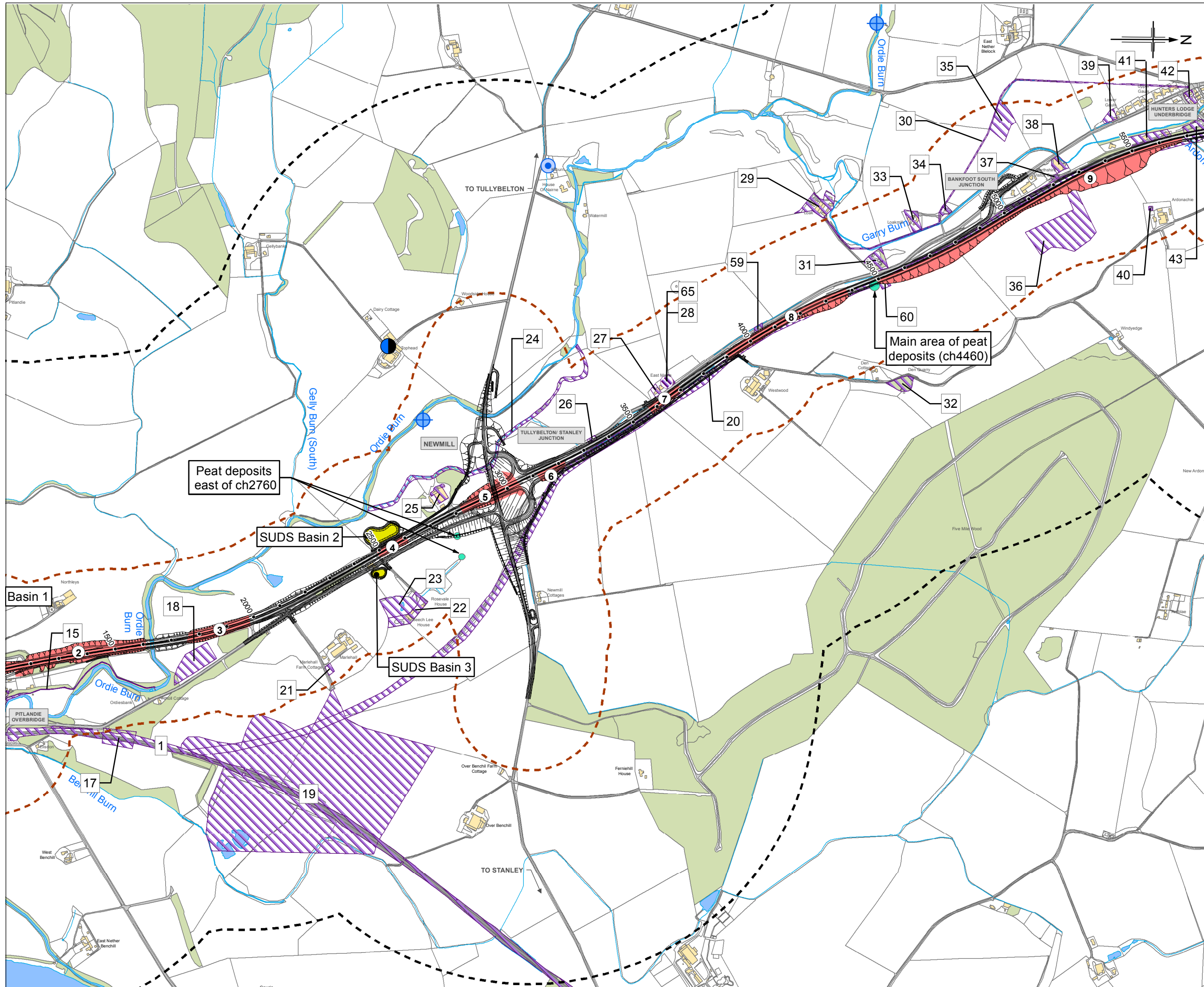

- Legend**
- Proposed Scheme (DMRB Stage 3 Design)
  - 250m Study Area
  - 850m Study Area
  - Private Water Supply Users
  - Spring
  - Well
  - Unnamed pond
  - SUDS Basin
  - Contaminated Land
  - Mainline Excavation Area
  - Peat According to BGS Information
  - Peat Encountered During 2013 Ground Investigation
  - Site of Special Scientific Interest (SSSI)

Peat deposits east of ch2760

SUDS Basin 2

SUDS Basin 3

Main area of peat deposits (ch4460)

0	MAR 2014	ES Publication	KA	SCRN	VSM	AG
Rev	Date	Purpose of revision	Drawn	Check'd	Rev'd	Appr'd

**JACOBS**  
 55 Bellfield Street, Glasgow, G2 7HX, UK.  
 Tel: +44(0)141 204 2511 Fax: +44(0)141 226 3109  
 www.jacobs.com



Client	Transport Scotland The Scottish Government				
Project	A9 Dualling: Luncarty to Pass of Birnam				
Drawing Title	Potentially Contaminated Land and Hydrogeology Features				
Drawing Status	FINAL				
Scale @A3	1:12,500	DO NOT SCALE			
Jacobs No.	B1557602				
Client No.					
Drawing No.	FIGURE 8.1b	Rev	0		

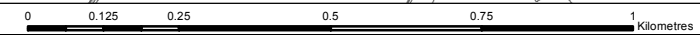
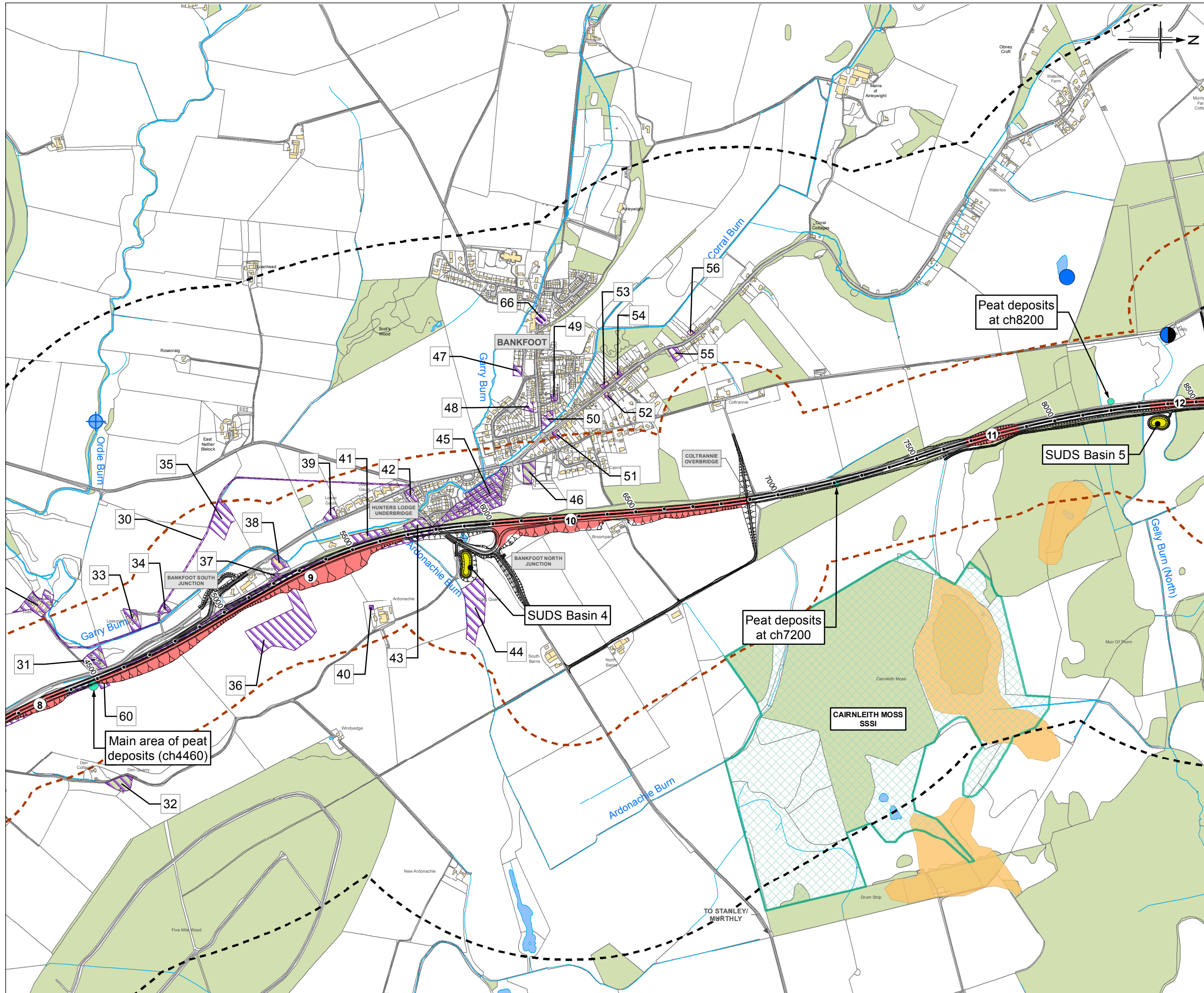

FIGURE 8.1c



- Legend**
- Proposed Scheme (DMRB Stage 3 Design)
  - 250m Study Area
  - 850m Study Area
  - Private Water Supply Users
  - Spring
  - Well
  - Unnamed pond
  - SUDS Basin
  - Contaminated Land
  - Mainline Excavation Area
  - Peat According to BGS Information
  - Peat Encountered During 2013 Ground Investigation
  - Site of Special Scientific Interest (SSSI)

0	MAR 2014	ES Publication	KA	SCRN	VSM	AG
Rev.	Date	Purpose of revision	Drawn	Check'd	Rev'd	Appr'd

**JACOBS**  
 95 Botwell Street, Glasgow, G2 7HX, UK.  
 Tel: +44(0)141 204 2511 Fax: +44(0)141 226 3109  
 www.jacobs.com



Drawing Title		Potentially Contaminated Land and Hydrogeology Features	
Drawing Status		FINAL	
Scale @A3	1:12,500	DO NOT SCALE	
Jacobs No.	B1557602		
Client No.			
Drawing No.	FIGURE 8.1c	Rev	0

Reproduced by permission of Ordnance Survey on behalf of HMSO. © Crown copyright and database right 2013. All rights reserved. Ordnance Survey Licence number 100046688.

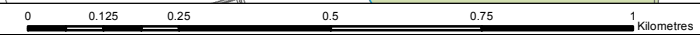

This drawing is not to be used in whole or in part other than for the intended purpose and project as defined on this drawing. Refer to the contract for full terms and conditions.

FIGURE 8.1d

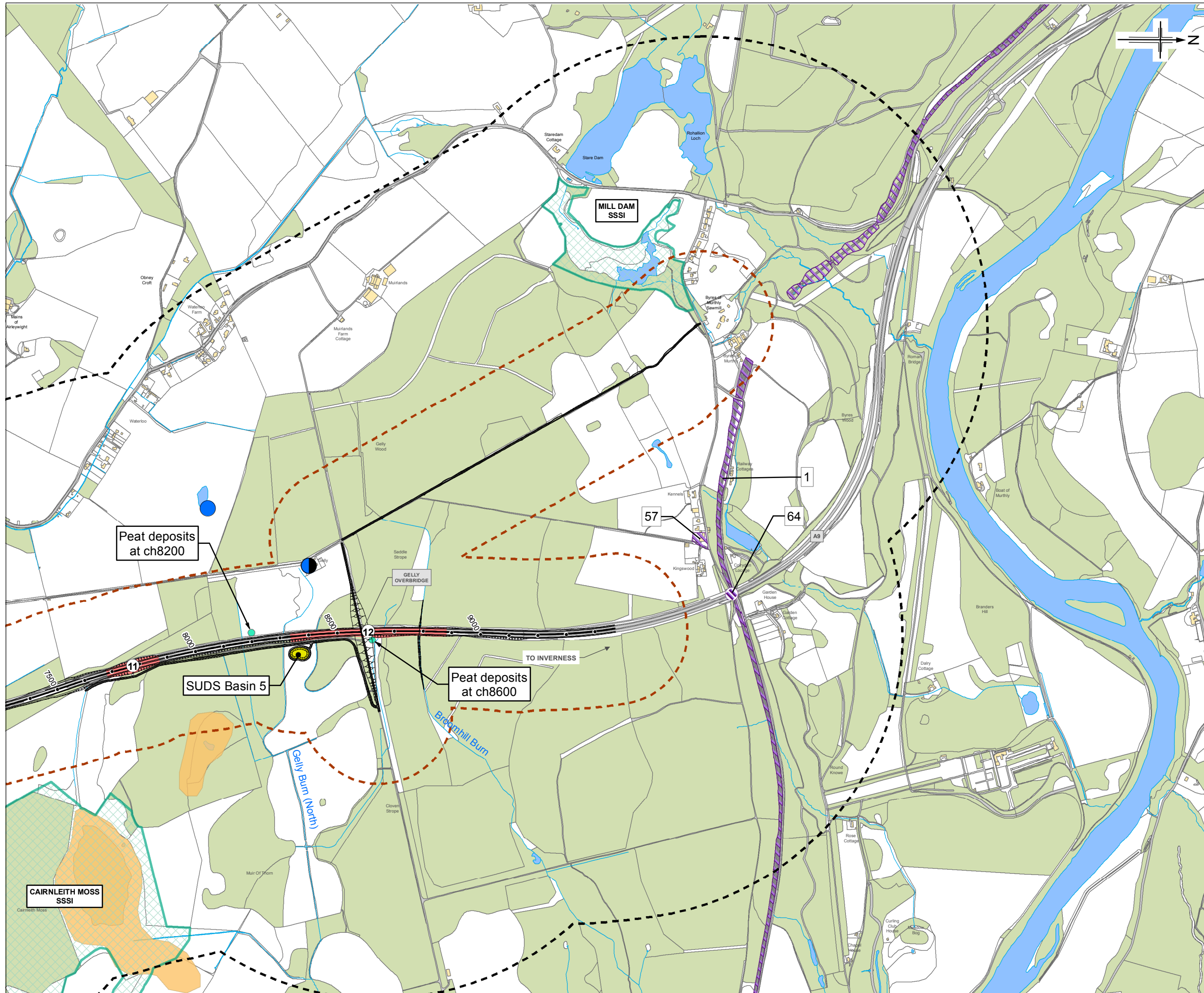

- Legend**
- Proposed Scheme (DMRB Stage 3 Design)
  - 250m Study Area
  - 850m Study Area
  - Private Water Supply Users
  - Spring
  - Well
  - Unnamed pond
  - SUDS Basin
  - Contaminated Land
  - Mainline Excavation Area
  - Peat According to BGS Information
  - Peat Encountered During 2013 Ground Investigation
  - Site of Special Scientific Interest (SSSI)

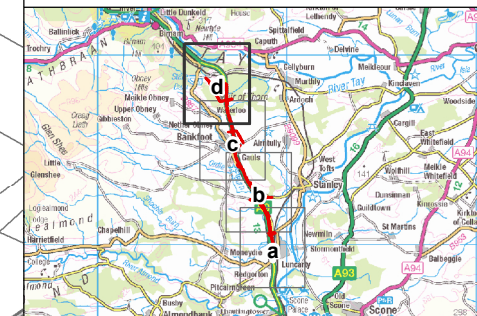

0	MAR 2014	ES Publication	KA	SCRN	VSM	AG
Rev.	Date	Purpose of revision	Drawn	Check'd	Rev'd	Appr'd

**JACOBS**  
 95 Botwell Street, Glasgow, G2 7HX, UK.  
 Tel: +44(0)141 204 2511 Fax: +44(0)141 226 3109  
 www.jacobs.com



Drawing Title		SHEET 4 of 4	
Potentially Contaminated Land and Hydrogeology Features			
Drawing Status		FINAL	
Scale @A3	1:12,500	DO NOT SCALE	
Jacobs No.	B1557602		
Client No.			
Drawing No.	FIGURE 8.1d	Rev	0

