

Not to Scale

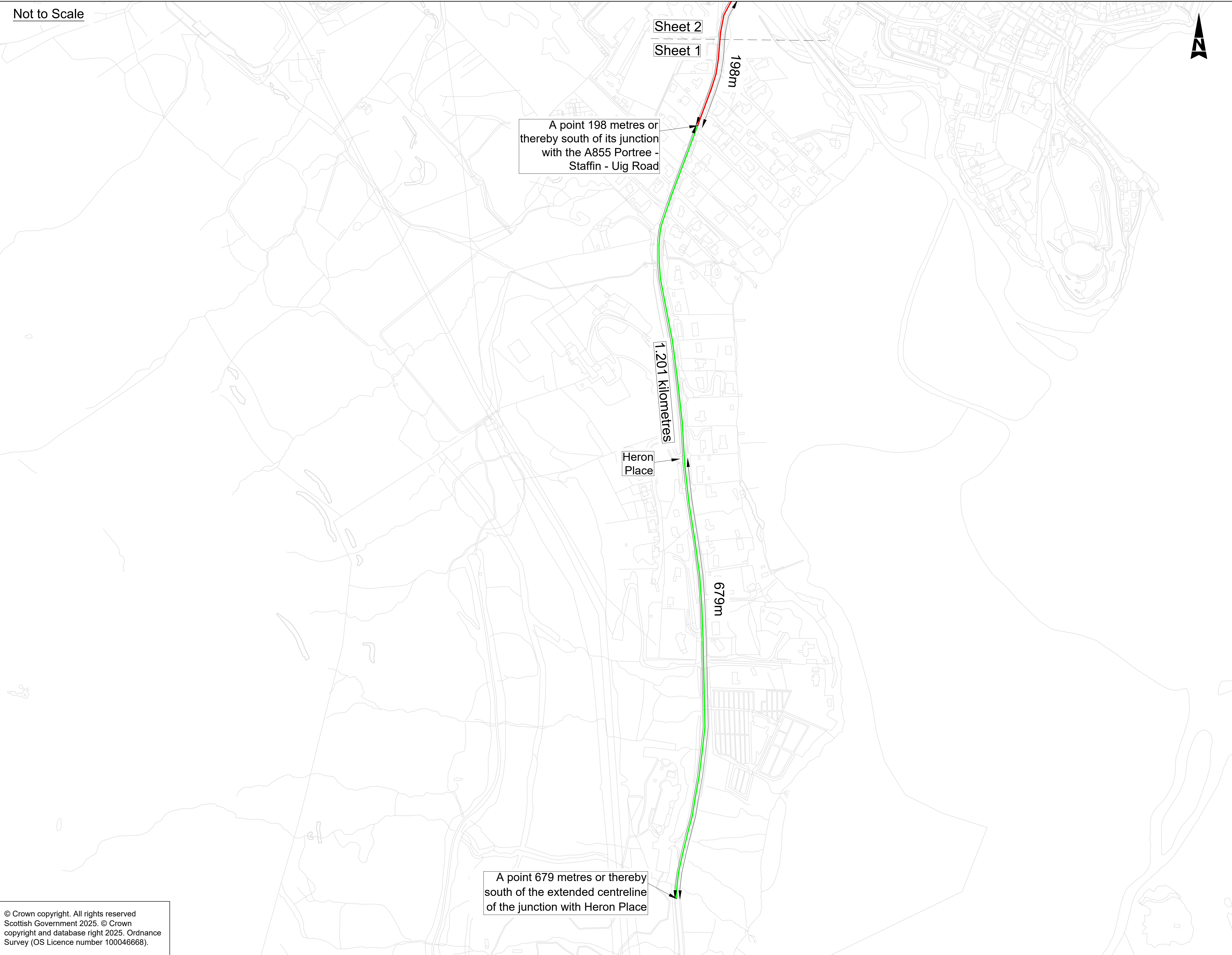

© Crown copyright. All rights reserved  
Scottish Government 2025. © Crown  
copyright and database right 2025. Ordnance  
Survey (OS Licence number 100046668).

Key:

The A87 Trunk Road (Portree) (20mph  
and 30mph Speed Limits) Order 2025:

Part 1 (20mph): —

1. That length of A87 Invergarry - Kyle  
of Lochalsh - Borge - Uig Trunk Road  
at Portree from a point 198 metres or  
thereby south of its junction with the  
A855 Portree - Staffin - Uig road to a  
point 36 metres or thereby north west  
of the extended centre line of the  
junction with Hedgefield Road, a  
distance of 552 metres or thereby.

Part 2 (30mph): —

2. That length of A87 Invergarry - Kyle  
of Lochalsh - Borge - Uig Trunk Road  
at Portree from a point 679 metres or  
thereby south of the extended centre  
line of the junction with Heron Place  
northwards to a point 198 metres or  
thereby south of its junction with the  
A855 Portree - Staffin - Uig Road, a  
distance of 1.201 kilometres or  
thereby.
3. That length of A87 Invergarry - Kyle  
of Lochalsh - Borge - Uig Trunk Road  
at Portree from a point 36 metres or  
thereby north west of the extended  
centre line of the junction with  
Hedgefield Road northwards to a  
point 52 metres or thereby southeast  
of the extended centre line of the  
junction with Lisigarry Place, a  
distance of 521 metres or thereby.